

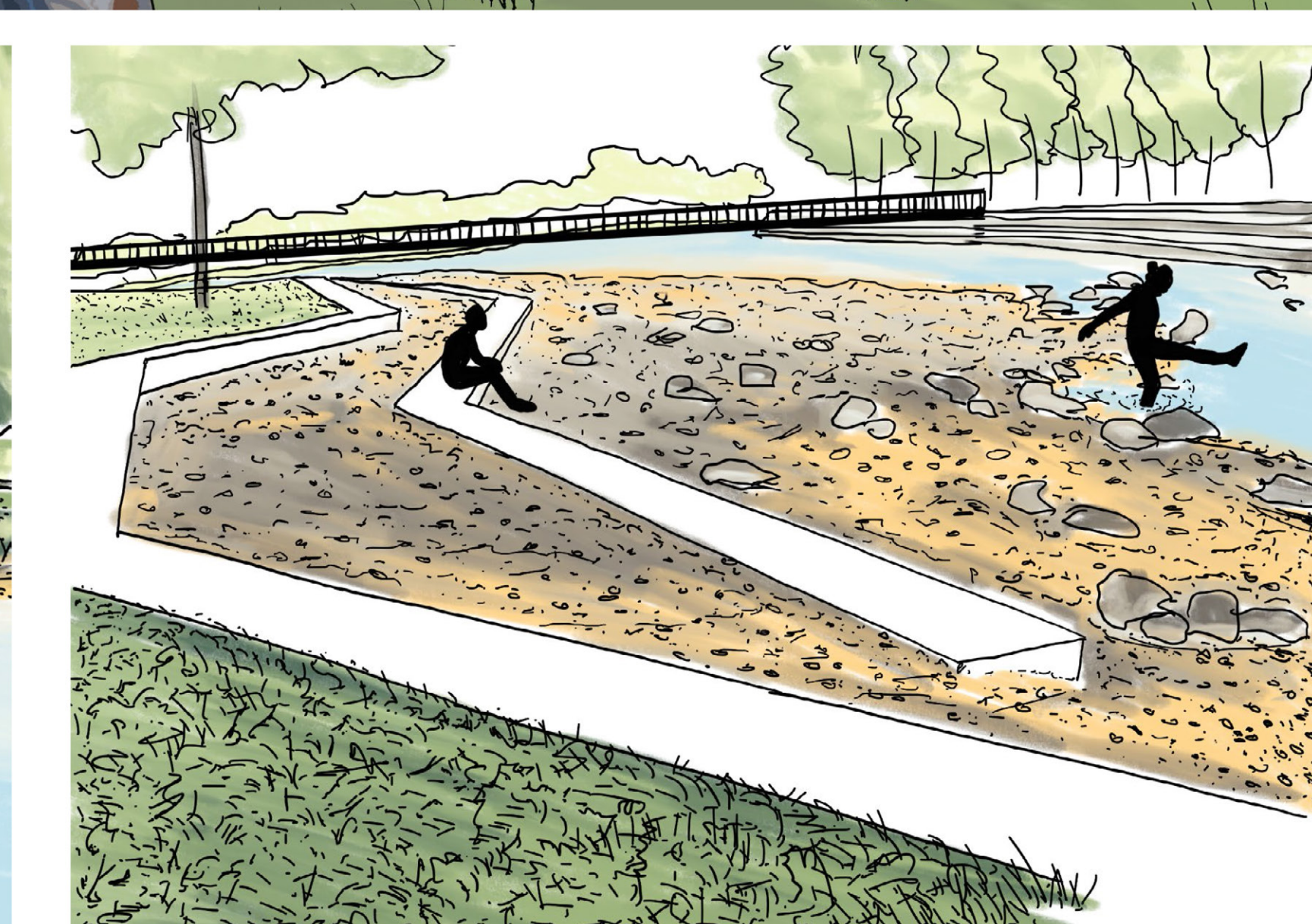

LIBEŇ HARBOR

The aim of the proposal is to revitalize the man-made landscape which is connected to important city districts in the wider city center. The proposal seeks to create space for a more natural movement of the river in a place that has been significantly influenced by human activity. At the same time, it creates the possibility of contact with water and its use for recreational activities.

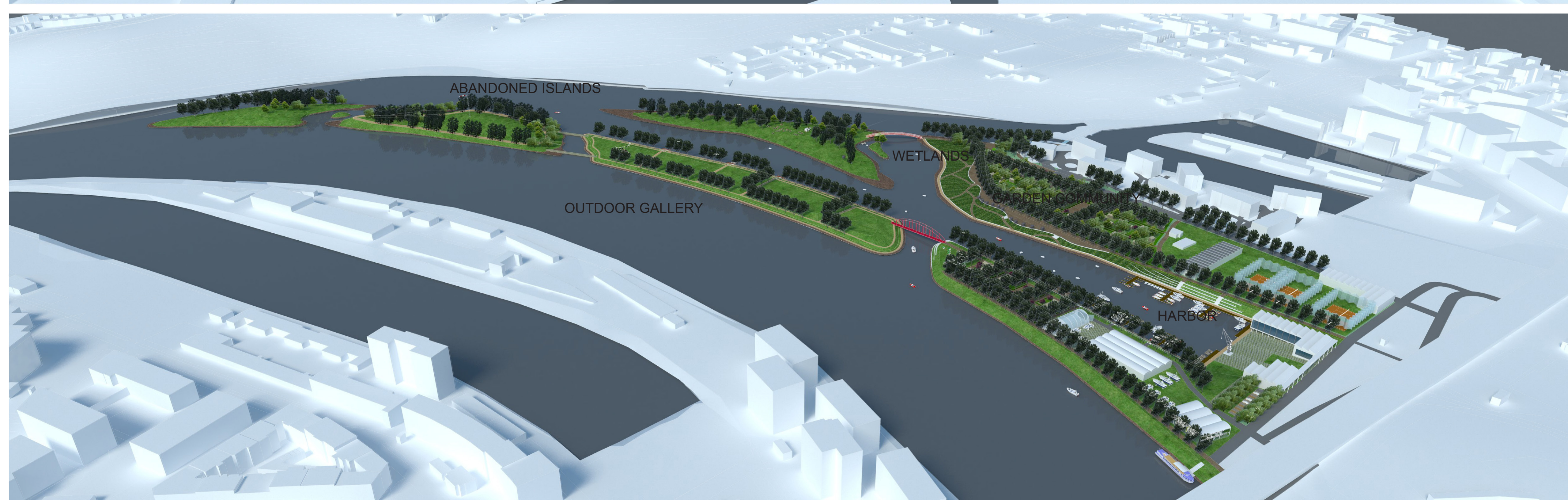
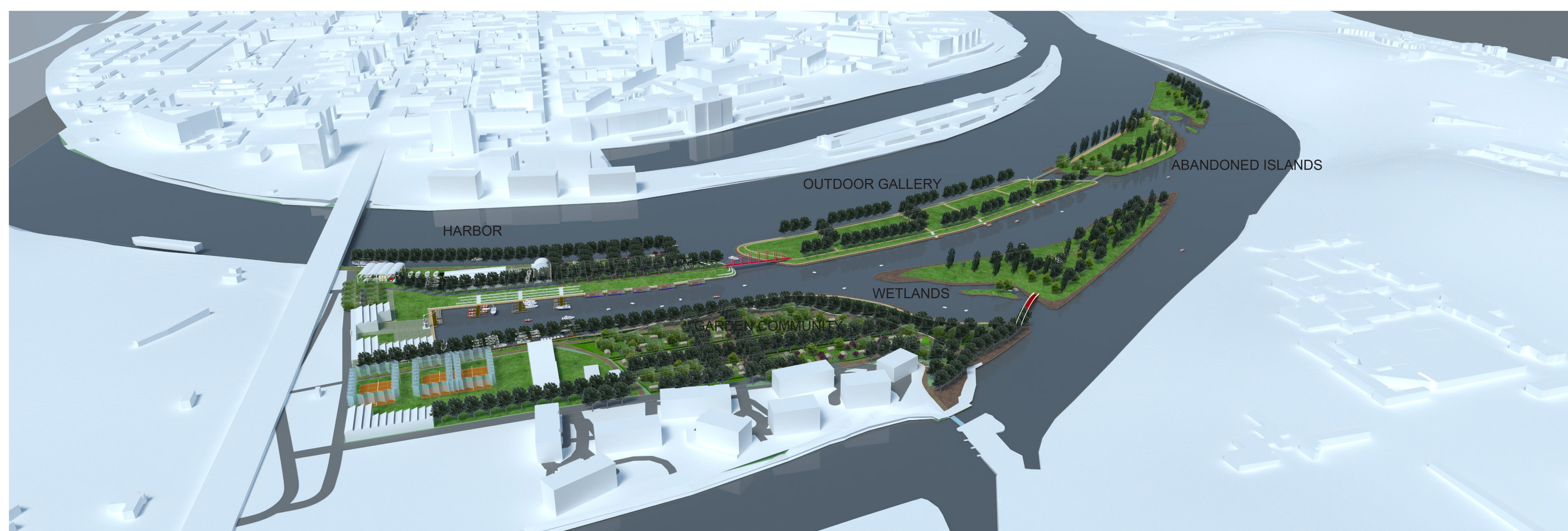
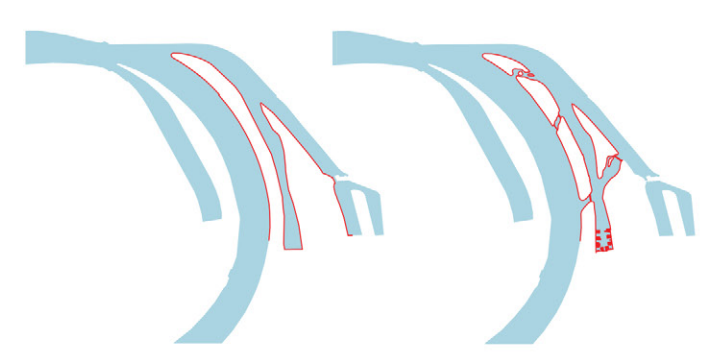

ATELIER HANSON

VERONIKA KUČEROVÁ

PORT OF PRAGUE: LIBEŇ HARBOR AT2 - MEDIUM SCALE LS 2019_2020