

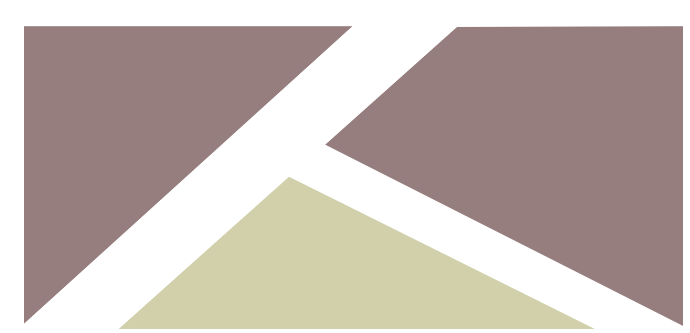

THE EDGE OF CHANGE

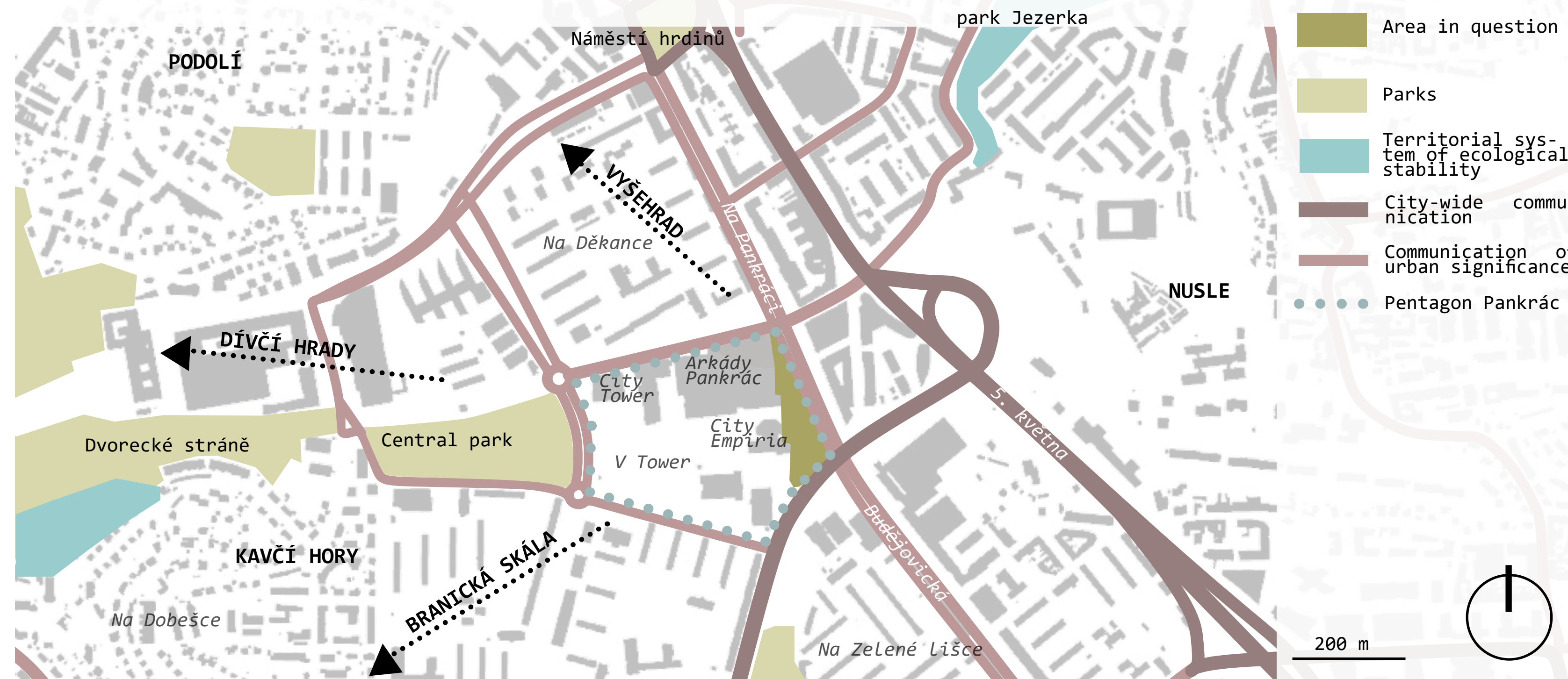

WIDER RELATIONS 1:5000



Concrete jungle. High-rise buildings on a non-human scale. Bustle. Noise. The noise of cars. Is it possible to find a balance between nature and a fast, consumer society? The project dealing with public space in the center of the modern part of Prague works with this topic. I create a space that puts the needs of nature, people and the city in the plane. A place is created that is modern, representative, user-friendly and at the same time helps nature by applying principles close to it. Are we able to find the edge of change within ourselves that will stop our irresponsible behavior towards nature and reverse our approach to it?

The area in question is located on the right bank of the Vltava River in the southern part of Prague 4 - in Nusle. PANKRÁČSKÝ PENTAGON or also Pankrácský plán is a designation for the area on the Pankrác hill and is known for its high-rise buildings. The solved area forms the corner of the pentagon and is in the grip of busy traffic arteries. In the immediate vicinity is the Central Park, which is very popular with locals. Nearby is also a natural monument called Dvorská stráně or park Jezerka. The area is connected to the center by metro C.

MASTERPLAN 1:500

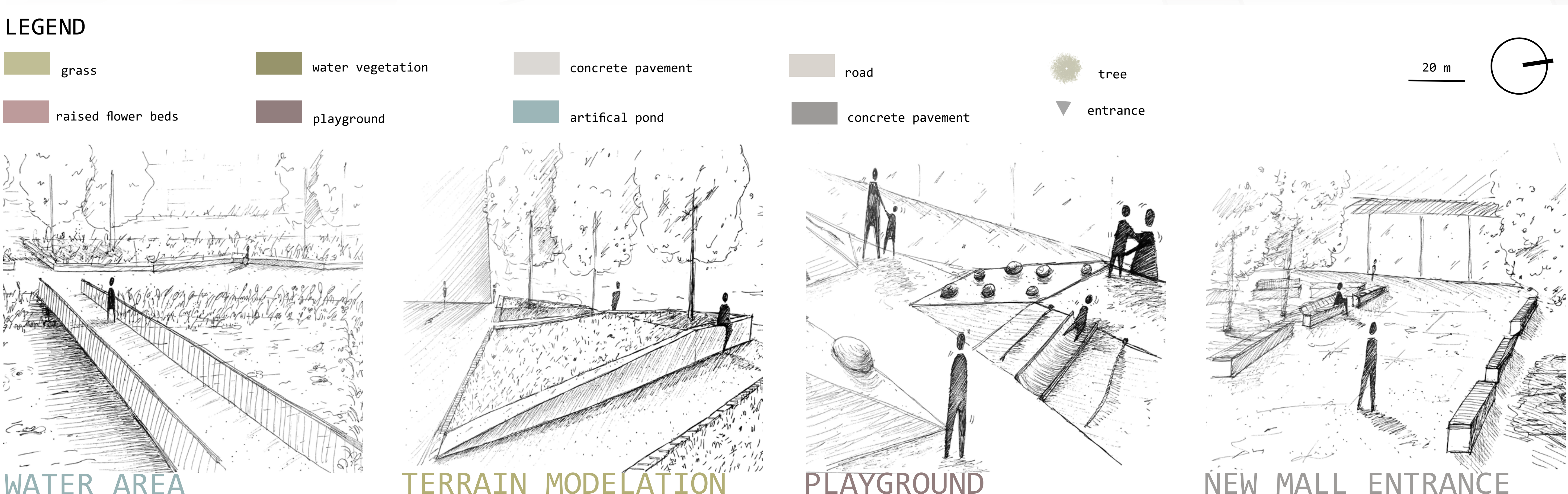
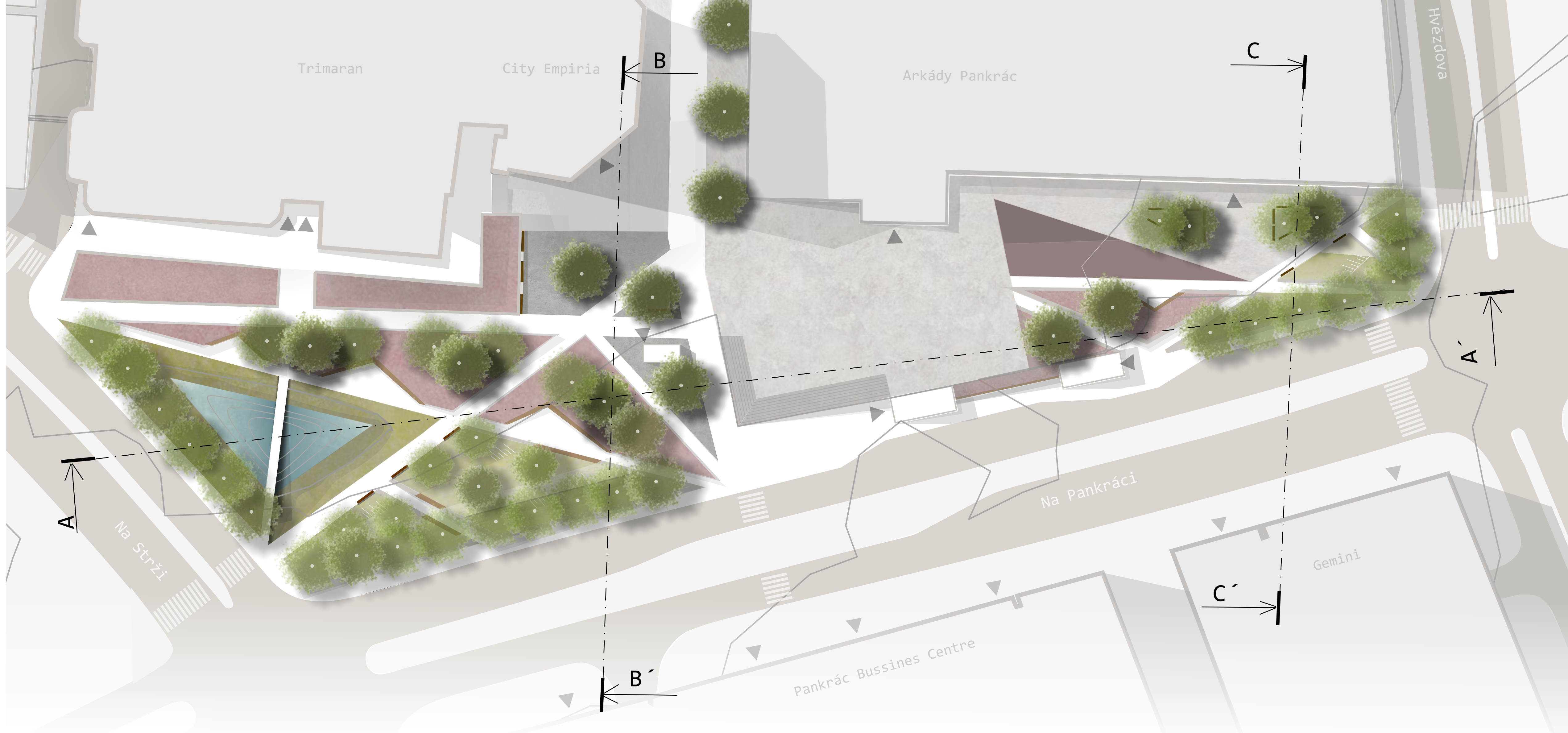

The unifying element of the project is a triangle. The area is located in the space between high-rise buildings, where everything seems slightly opposite them. In the design, I decided to work in large areas. Tiny elements in this space could seem inappropriate or ridiculous. The newly created road network is created according to the expected movement of people and is designed to meet their needs as much as possible. Paths are designed to allow for smooth movement through the territory, but also to stop and not hinder others in the way. The proposed terrain modelation and shapes have sharp edges, which, however, are softened by added vegetation. The project offers several different spaces so that each visitor can find their place in it.

SURFACES



TREES



VEGETATION



LONGITUDINAL SECTION A - A', 1:500

