

↴ Nemocnice Krč

CONTENTS



BROADER
CONTEXT



CURRENT
STATE



PROPOSAL
DEVELOPMENT

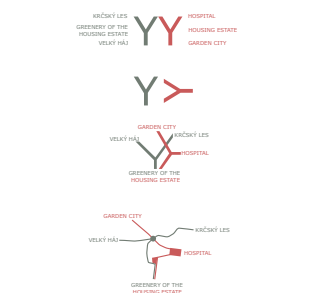

CONCEPT



PROPOSAL



VIEWS

BROADER CONTEXT CONCEPT

LEGENDA

METRO STATIONS



GREEN AREAS



GREEN CONNECTIONS



PUBLIC SPACES



STRONG CONNECTIONS
BEETWEEN PUBLIC SPACES



MENTAL CONNECTIONS
BEETWEEN PUBLIC SPACES



TRANSPORT FROM SOUTH



SAPA



HOSPITALS



INDUSTRIAL ZONE

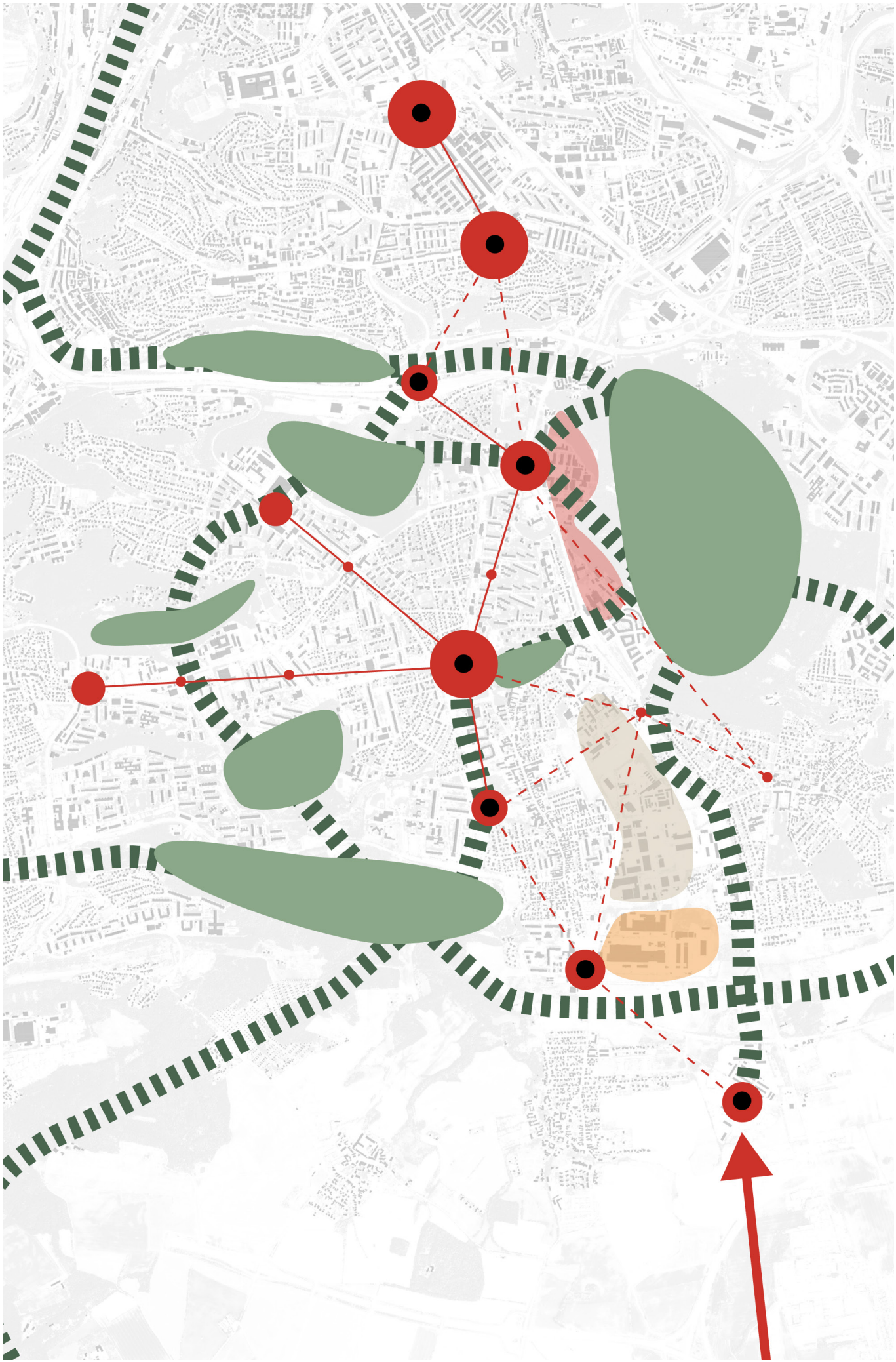

CURRENT STATE
PHOTOS



CURRENT STATE

SWOT

STRENGHTS AND WEAKNESSES

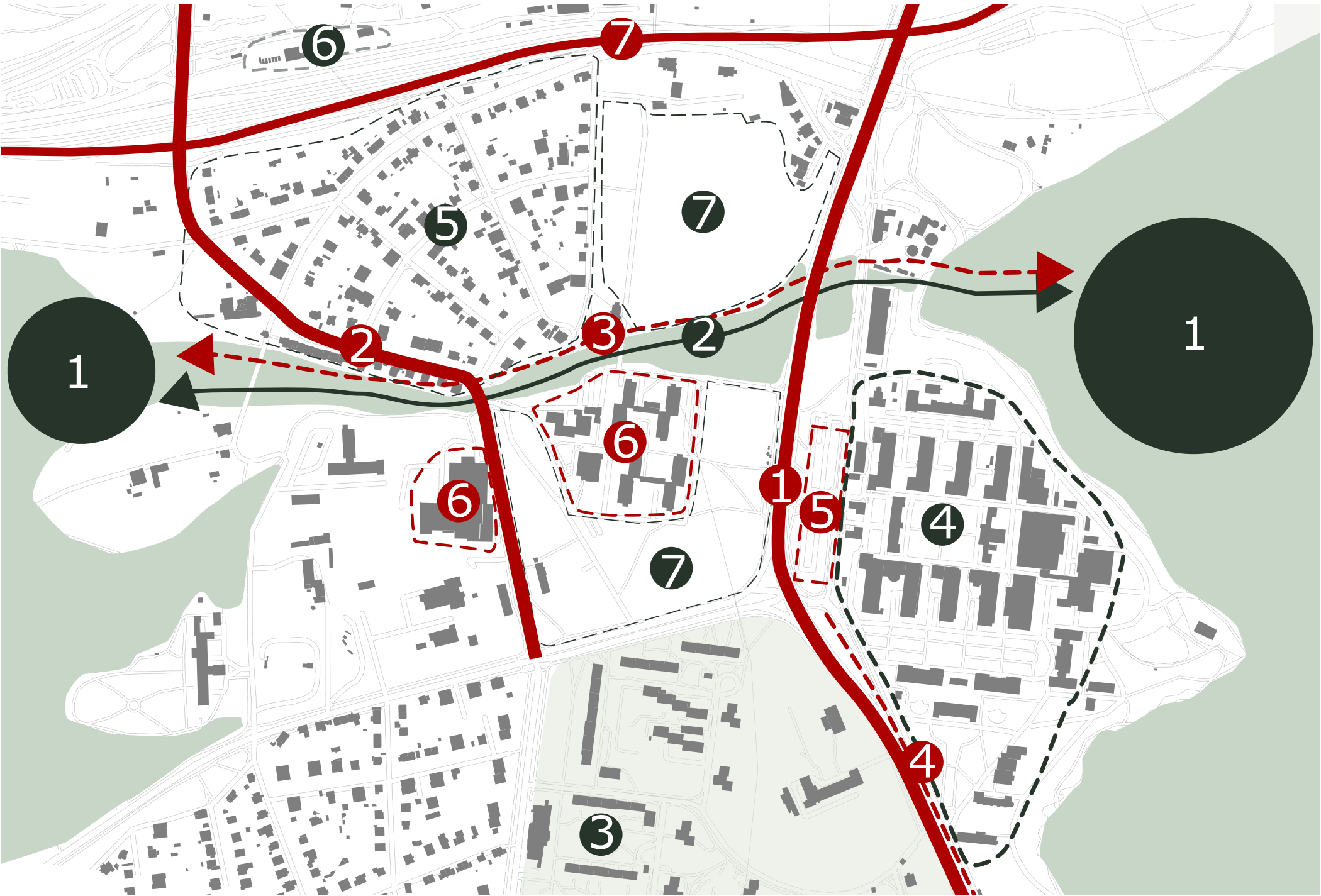

- 1 THE GREEN PARKS
 - 2 THE PROPOSED USES
 - 3 A LOT OF GREENERY IN THE HOUSING ESTATE
 - 4 THE HOSPITAL GIVING CHARACTER TO OUR AREA
 - 5 THE STABILIZED STRUCTURE OF THE GARDEN CITY
 - 6 THE RAILWAY STATION NEARBY
 - 7 A LOT OF UNBUILT AREA TO BE DEVELOPED
-
- 1 HEAVY TRAFFIC ON VÍDEŇSKÁ STREET
 - 2 HEAVY TRAFFIC DISTURBING THE GARDEN CITY THREW POD VIŠNOVKOU STREET
 - 3 UNUSED GREENERY
 - 4 WALL AROUND THE HOSPITALS AREAL AS A BARRIER ON WAY TO THE KRČSKÝ LES
 - 5 LACKING OF PUBLIC SPACE IN FRONT OF THE HOSPITAL PARKING LOTS INSTEAD OF THAT
 - 6 NONSENCELY PLACED VOLUMES OF BUILDINGS WITH DISPUTABLE FUNCTIONS
 - 7 THE RAILWAY AS A BARRIER IN THE NORTH

PROPOSAL DEVELOPMENT

STEP 1

REACTION ON THE STRUCTURE
OF THE HOSPITAL

WORKING WITH THE GARDEN CITY STREETS

ADDING A CHURCH TO THE MAIN AXIS

TOO LONG MAIN AXIS

NOT WELL CONNECTED
TO THE SURROUNDINGS



STEP 2

MOVING THE CHURCH MORE TO THE CENTER
AND CREATING A NEW SQUARE AROUND

SEQUENCE OF THREE TOO LARGE SQUARES

TOO ARTIFICIAL PROPOSAL WITH AN BLOCKS
IN SHAPE OF ARCH AROUND



STEP 3

FOCUS ON THE CONNECTIONS WITH NEW
GARDEN CITY AND NÁDRAŽÍ KRČ STATION

AVOIDING THE ARCH



STEP 4

PROPOSING JUST ONE SQUARE IN FRONT OF
THE HOSPITAL

TRYING TO ADD A HIGH DENSITY QUARTER TO
THE SOUTHWEST PART

TOO CLOSED BLOCKS

THE HIGH DENSITY IS TOO MASSIVE AND
DESTROYING THE CHARACTER



PROPOSAL CONCEPT



NEMOCNICE KRČ METRO STATION IS LOCATED IN BETWEEN DIFFERENT FUNCTIONAL ZONES SUCH AS HOUSING, HEALTH CARE AND RECREATIONAL FOREST PARKS.

THE PROJECT AIMS TO SERVE AS A **CONNECTION NODE** THAT GUIDES ORIENTATION BY THE ESTABLISHMENT OF A DOUBLE "Y" IN THE SITE.

THE RED "Y" CONNECTS **3 URBAN STRUCTURES**.

THE GREEN "Y" CONNECTS **3 GREEN PATCHES**

THIS INTERVENTION FOCUSES ON **CREATING A NETWORK** FOR BOTH URBAN AND NATURAL SYSTEMS TO BE INTERCONNECTED IN A HARMONIOUS WAY, INTEGRATING PEOPLE, FAUNA AND FLORA IN THE URBAN ENVIRONMENT.

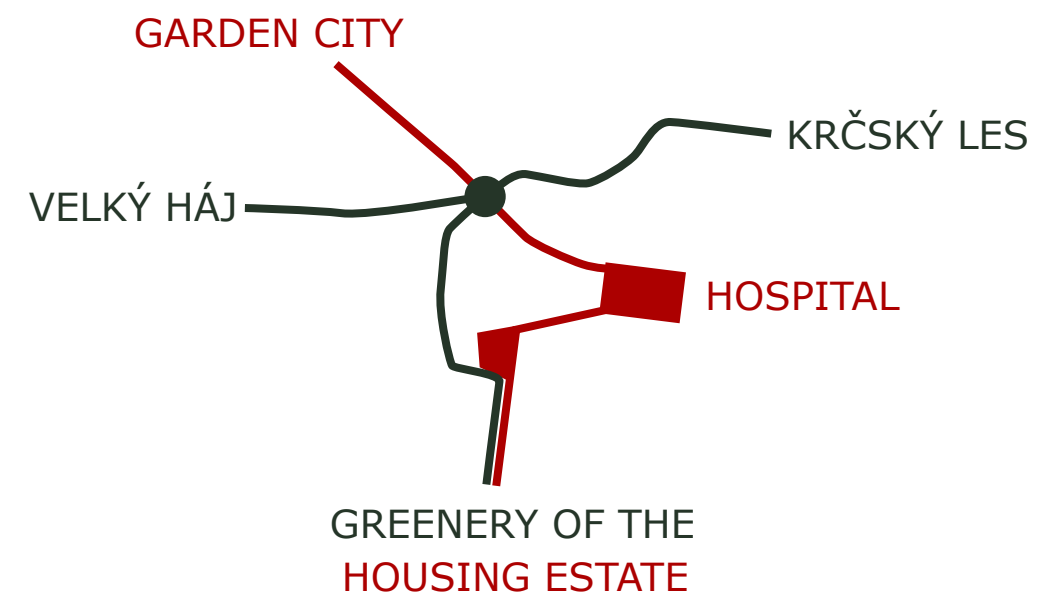
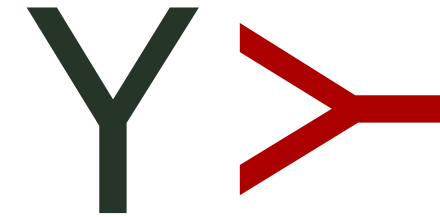
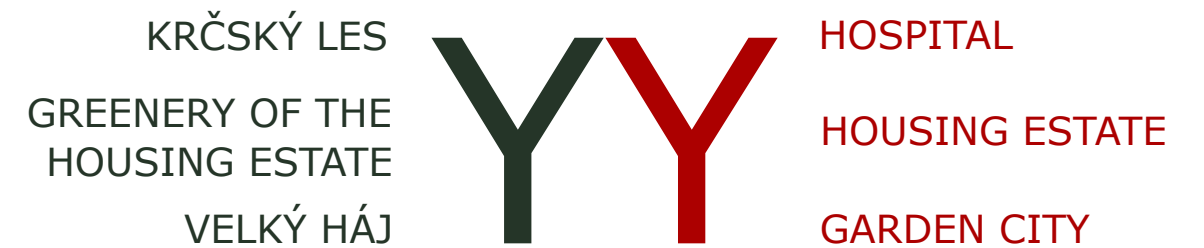

PROPOSAL MASTERPLAN

LEGENDA

- STREETS
- SQUARES
- PAVEMENTS
- PROPOSED BUILDINGS
- PARK GREENERY
- PRIVATE, SHARED GREENERY
- HOUSING ESTATES,
HOSPITALS GREENERY

1 : 4 000



PROPOSAL COMPOSITION

LEGENDA

- GARDEN CITY AXES
- - - SQUARE CONNECTIONS
- - - HOSPITAL AXES
- - - HAUSING ESTATE AXES
- SIGNIFICANT FRONTAGES

1 : 4 000

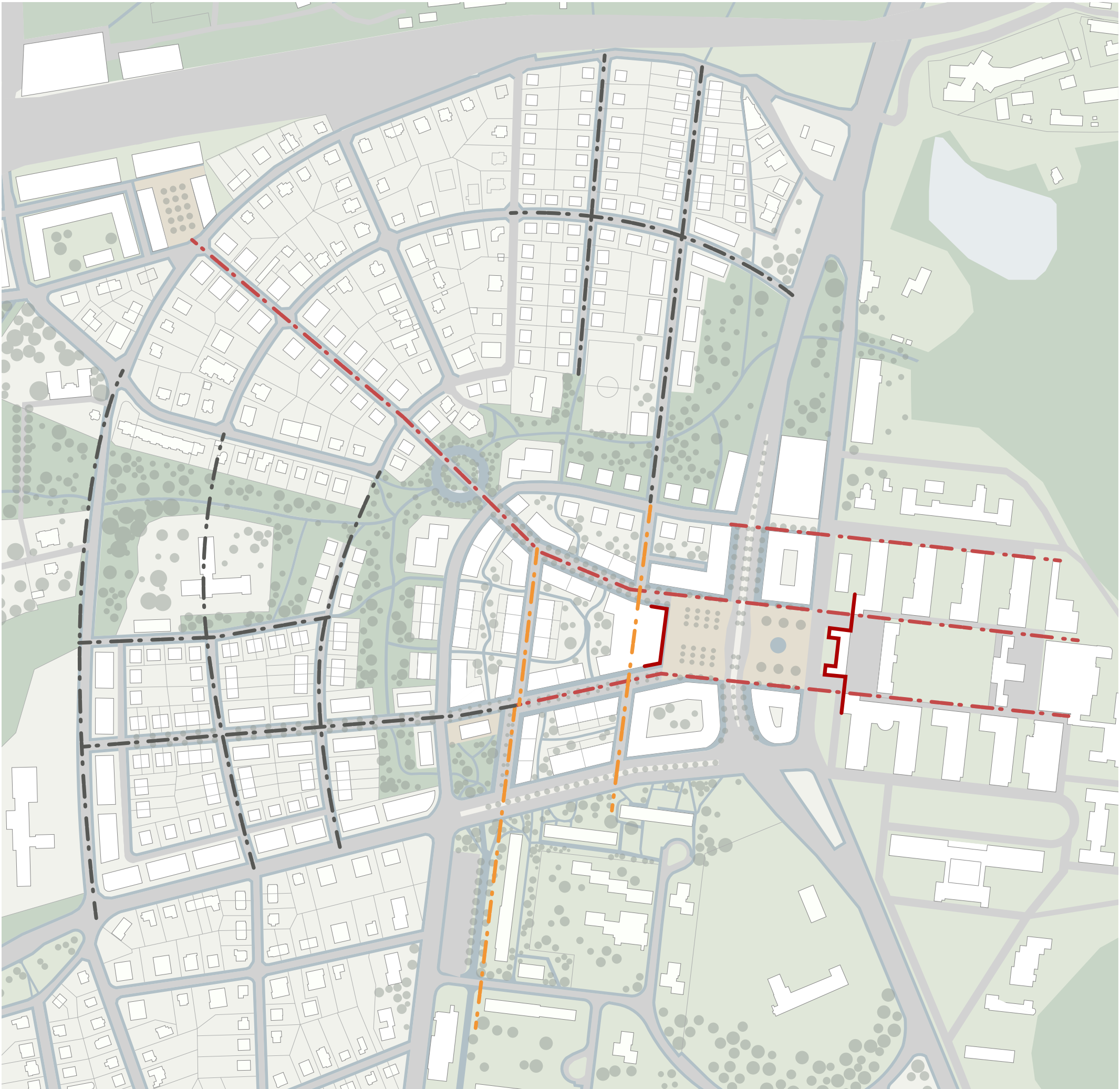

PROPOSAL PUBLIC SPACES

LEGENDA

- STREETS LOADED WITH HEAVY TRAFFIC
- STREETS WITH HIGH PEDESTRIAN DENSITY
- UTILITY STREETS
- LOCAL CALM STREETS (PROPOSED)
- LOCAL CALM STREETS (CURRENT)
- THE MAIN SQUARE OF NEMOCNICE KRČ METRO STATION
- NÁDRAŽÍ KRČ METRO STATION
- SIGNIFICANT PUBLIC BUILDINGS
- SIGNIFICANT GREEN NODS
- PARK PATHWAYS (PROPOSED)
- PARK PATHWAYS (CURRENT)
- URBAN PATHWAYS (PROPOSED)
- URBAN PATHWAYS (CURRENT)

1 : 4 000

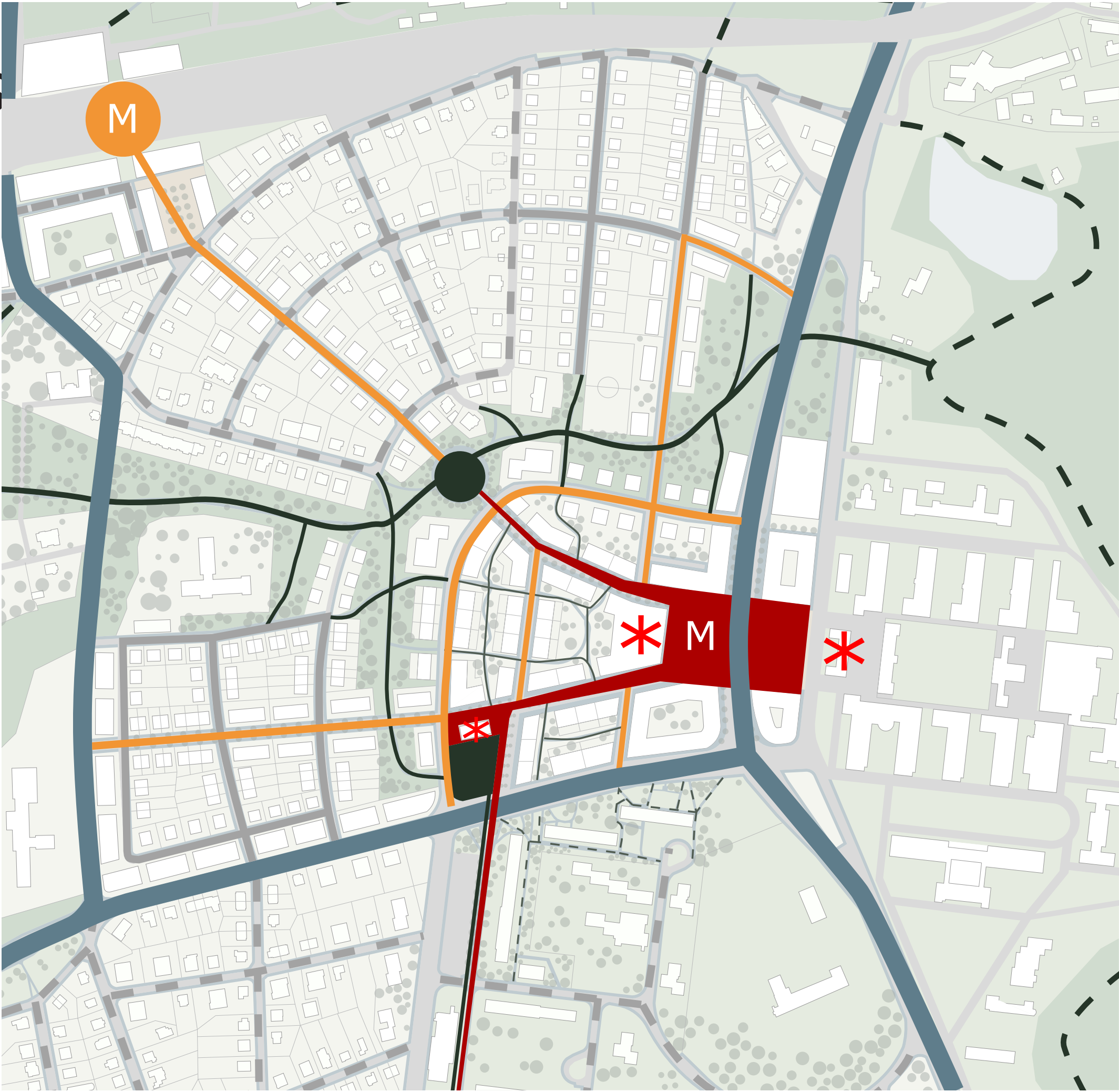

PROPOSAL TRANSPORT THE BYPASS

LEGENDA

- HEAVY TRAFFIC STREETS
- 1 000 DAILY NUMBERS OF CARS
- REMOVED STREET

1 : 4 000

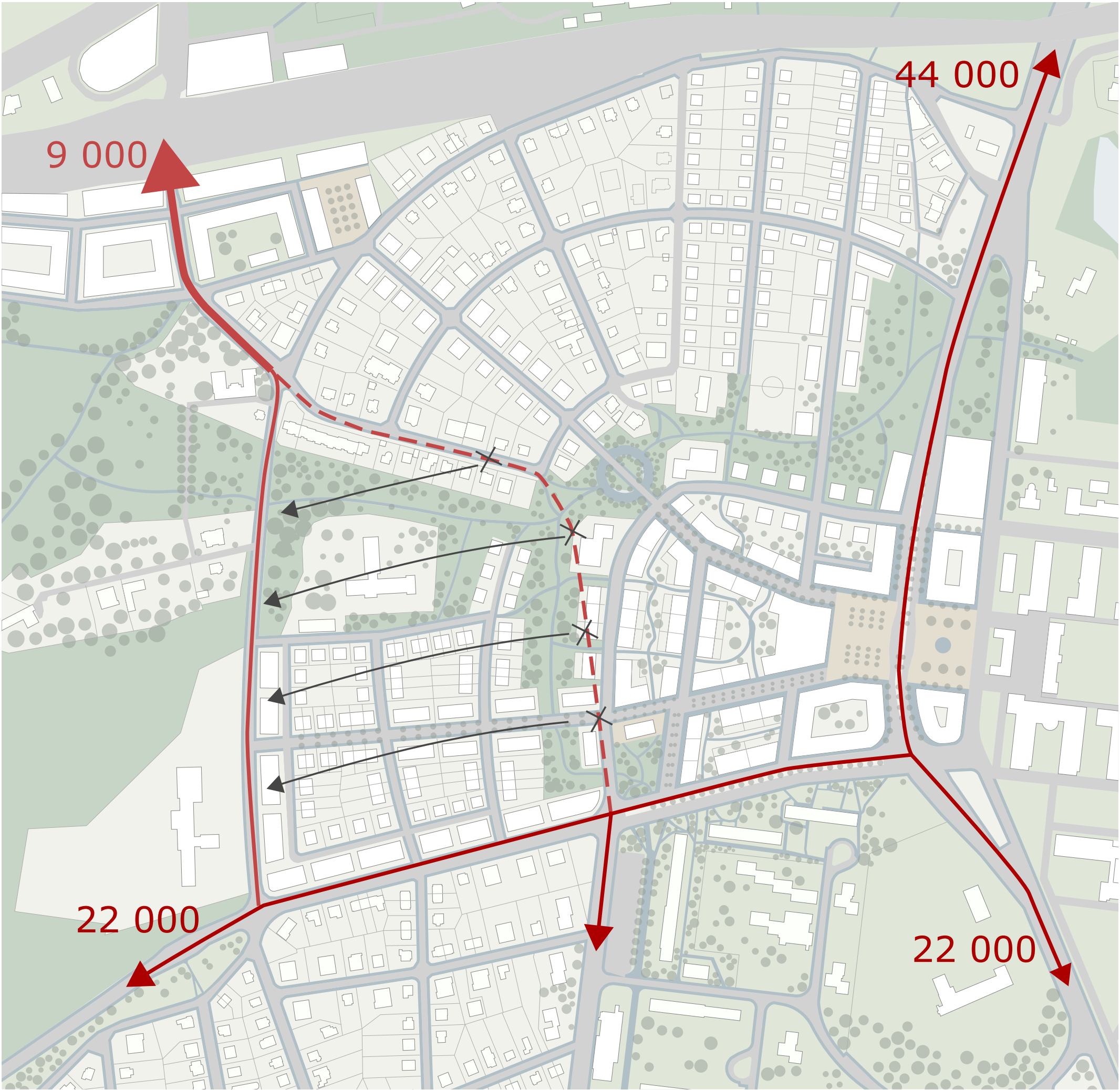

PROPOSAL TRANSPORT

LEGENDA

- HEAVY TRAFFIC STREETS
- SIGNIFICANT STREETS
- SUPPLY STREETS
- LOCAL CALM STREETS
- BUS STOPS
- METRO ENTRANCES

1 : 4 000



PROPOSAL LANDUSE

LEGENDA

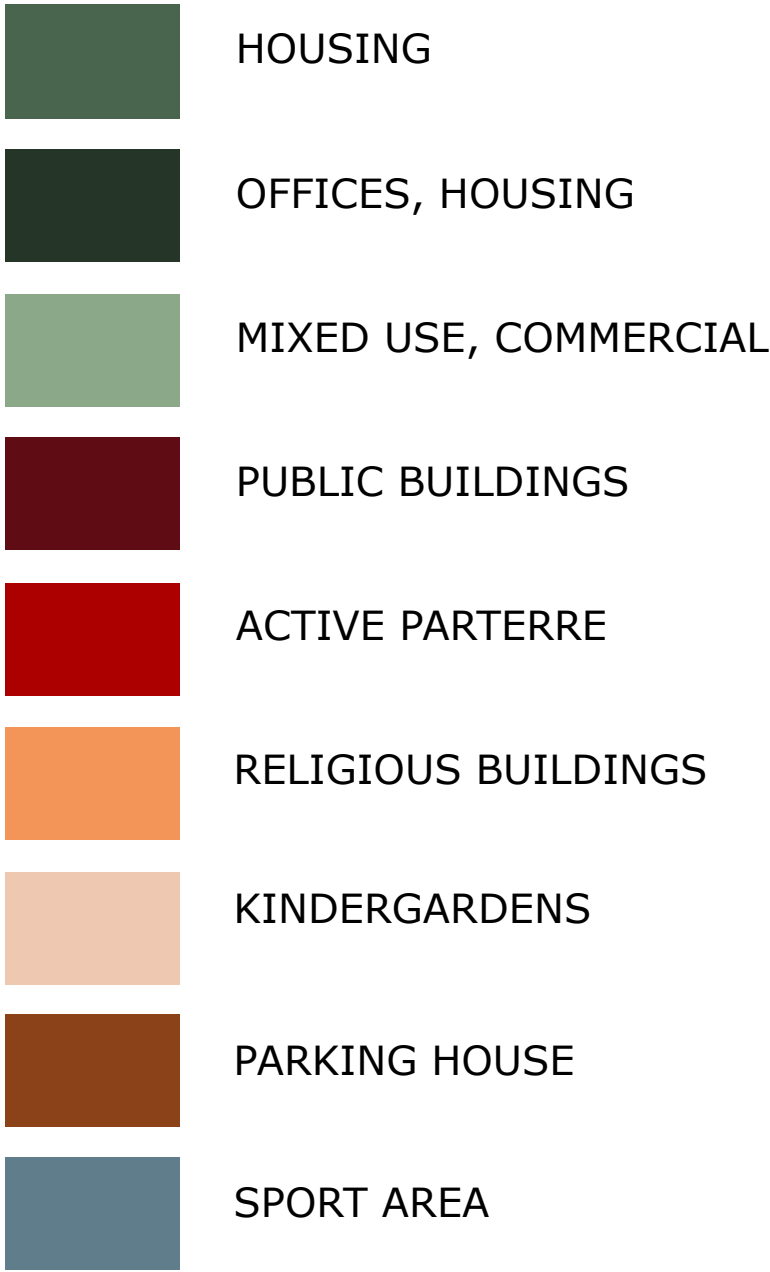







1 : 4 000 



PROPOSAL GREEN INFRASTRUCTURE

LEGENDA

-  THE PARK FORREST VELKÝ HÁJ
-  THE CITY FORREST KRČSKÝ LES
-  BIOCORRIDOOR PROPOSED BY USES
TURNED INTO PARK
-  SECONDARY GREEN CONNECTION
WITH THE GREENERY
OF THE HOUSING ESTATE,
A PARK WHICH REPLACES
HEAVY TRAFFIC STREET
-  NEW PEDESTRIAN CONNECTIONS
WITH THE PARK IN THE NORTH
-  CURRENT TREELINES
-  PROPOSED TREELINES

1 : 4 000



PROPOSAL

URBAN DETAIL

SECTION

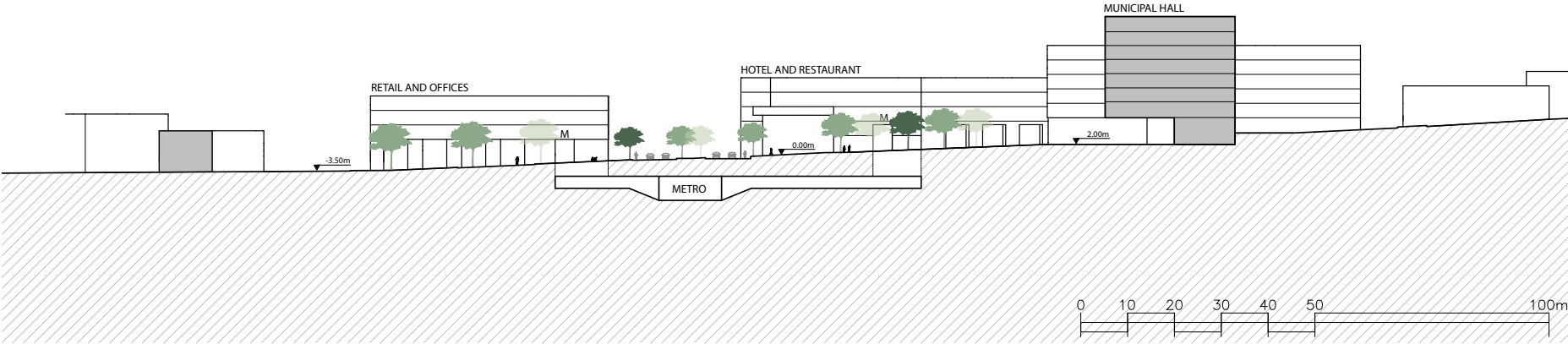

PROPOSAL

STREET PROFILES



- A VÍDEŇSKÁ
- B CONNECTION WITH THE HOUSING ESTATE
- C CONNECTION WITH NÁDRAŽÍ KRČ

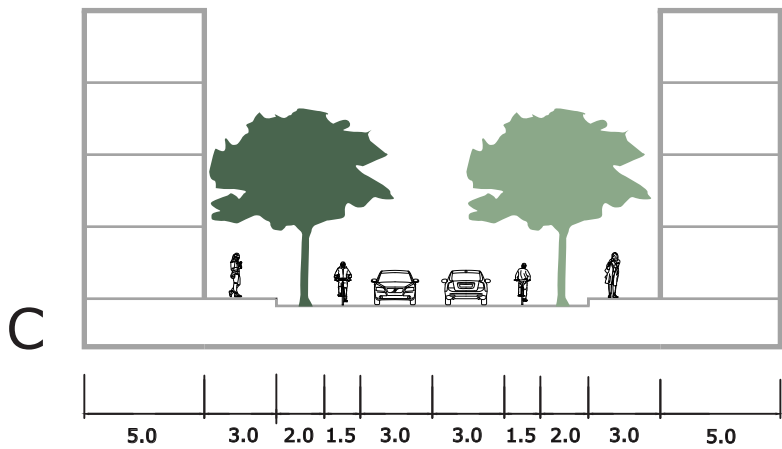
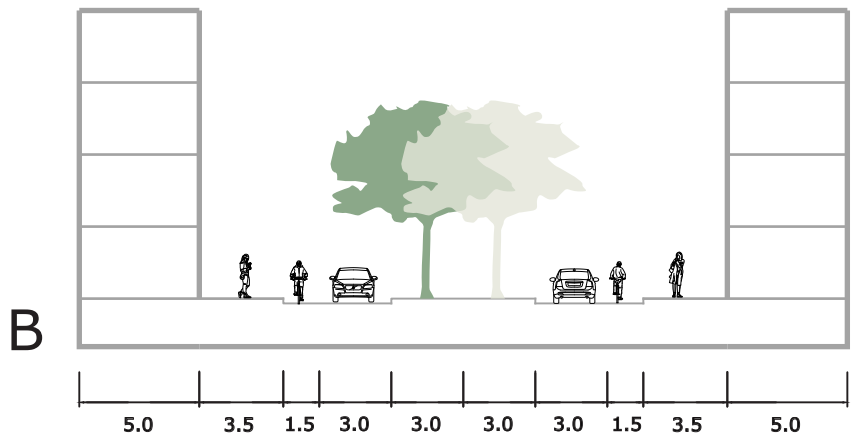
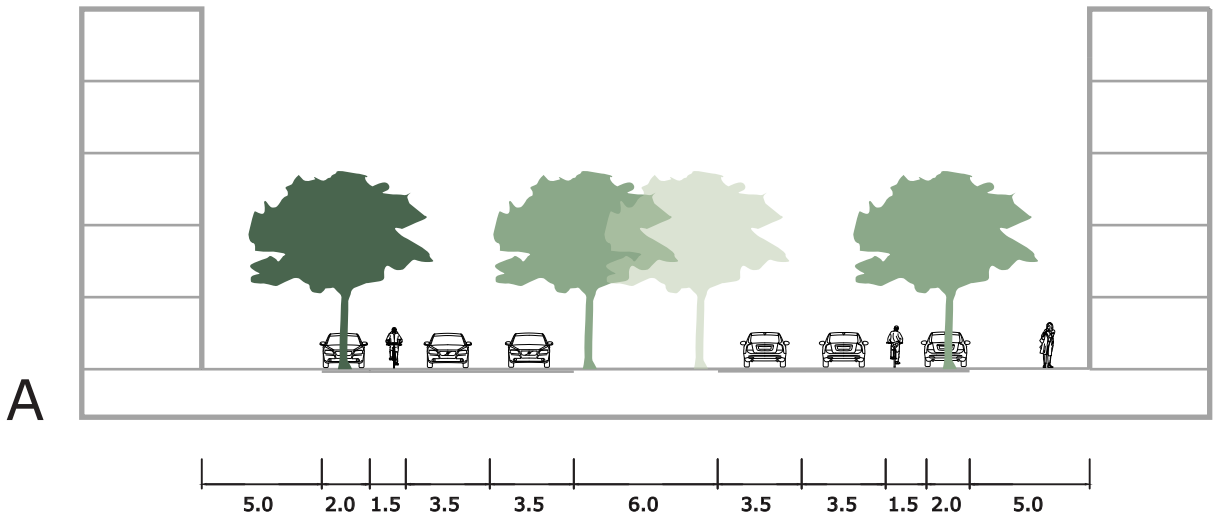

PROPOSAL VIEWS

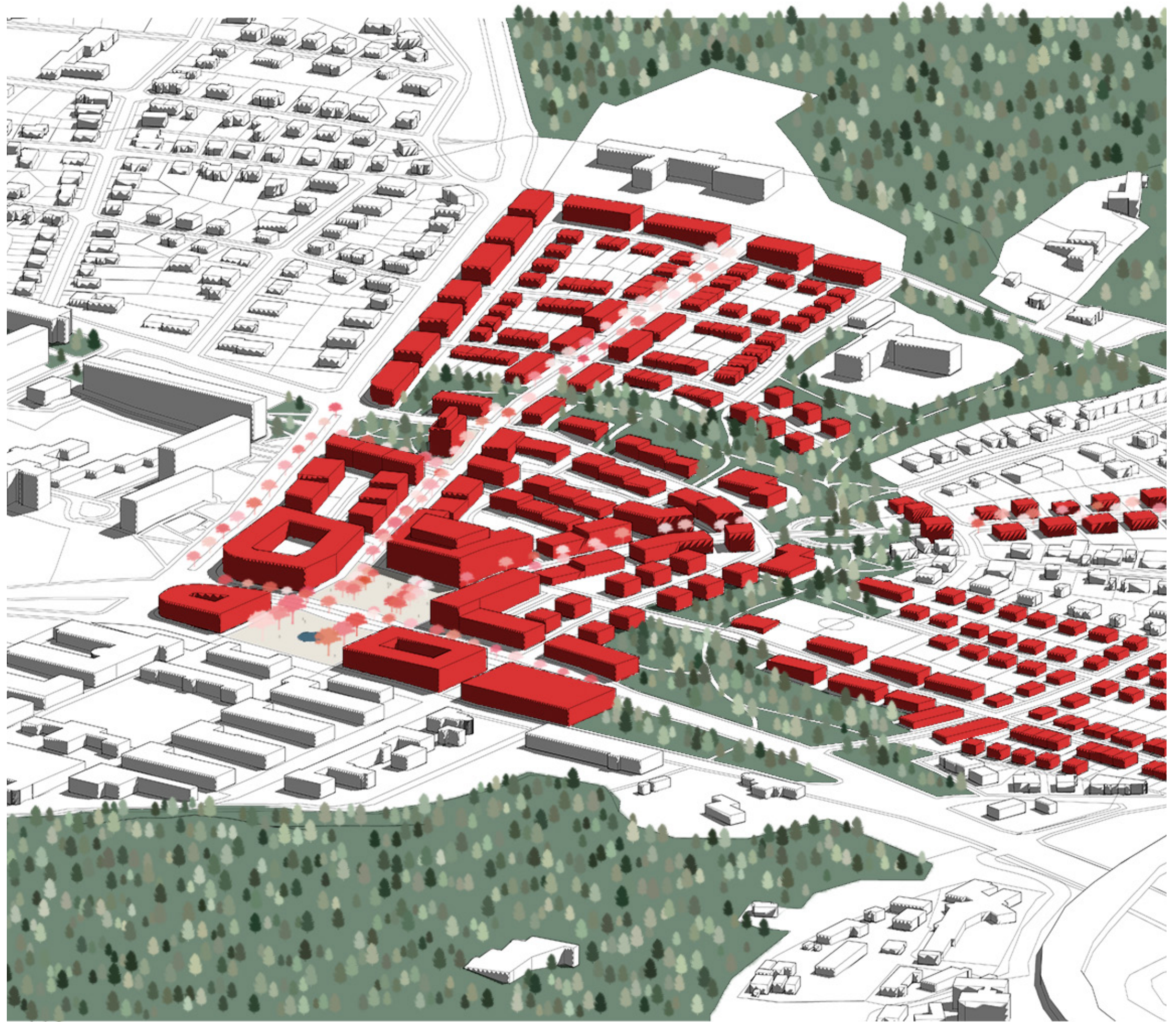
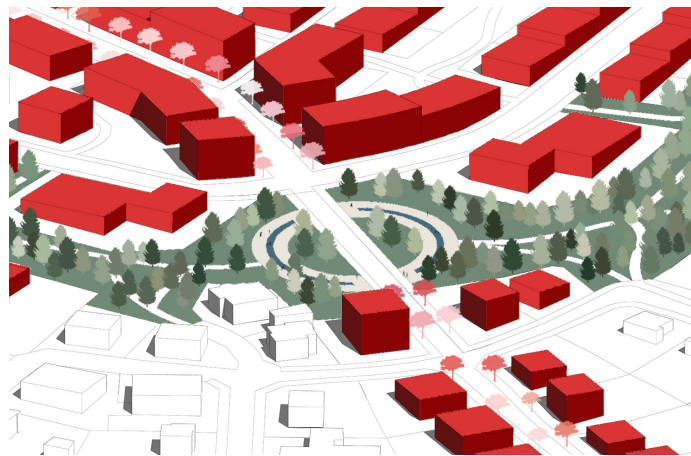

THE AUTORS



VALERIA MURILLO VÍQUEZ
Costa Rica, San José
valeriamurivi@gmail.com



ADÉLA HERZOGOVÁ
Czech republic, Prague
adelaherzogova@gmail.com



