



PINK LANTERN

THE BRIGHTEST LIGHT IN THE PARK

This project proposes the construction of a bistro-bar located in the park of Sady Dr. Milady Horákové in Ostrava. What today is known as the park was, in the past, one of the most important cemeteries in the city. However, the cemetery was relocated and the park is today a large expanse of parkland with considerable cultural and historical significance. It is also host for a great number of visitors and over 200 different species of vegetation.

The project aims at utilizing this richness in vegetation, historical value and abundance of visitors together with the new upcoming concert hall construction. Respecting the existing trees as much as possible, the bistro-bar is located on a plain where only two trees would need to be cut down. This position also takes advantage of the sun path, shows itself up to the main street to the North and creates a direct link from the Hospital area on the East side and the park.

Small modification to the parks' walking paths is proposed to encourage the pedestrian flow from North to South of the park, connecting the bistro-bar to the concert hall with a pleasant walk. Also, a new opening from the main street to the bistro-bar is proposed, meant to provide accessibility to service vehicles to the restaurant.

Functions & Form

The design of the building tries to find functionality with an elliptic shape. This would not only maximize the intake of natural light from the South, but it also allows having a fully open rounded kitchen where the customers can enjoy seeing their food being prepared as a part of the experience.

The ground floor features a restaurant with an indoor and another semi-indoor dining room, toilets and a winter garden, apart from all the functionalities needed for the staff to work comfortably. The first floor also counts with four entrances: a main entrance from the South, one through the winter garden from the East, a secondary entrance North-West and a private entrance from North-East that functions as a quick access to the storage rooms and staff facilities.

The first floor connects to the ground floor with stairs and an elevator. It also features a private side with a hydroponic greenhouse and a public side to the West of the building. Here is where the bar is, with some games such as billiard, and a balcony facing the park.

The whole project works with transparency as a main driver, the building shows its functionality from the outside and even inside as the chefs cook the meals. Glass is therefore one of the most used materials in this project except for the concrete walls facing North. These walls are clad in polished steel to reflect the light and attract attention from the North side. This façade material can also be found in the new concert hall, creating a link between the buildings.

The hydroponic greenhouse is also visible from the bar thanks to the curtain walls inside. This practice allows the workers to produce high quality vegetables for the customers while allowing the visitors to learn about this technology.

SITEPLAN



BEARING STRUCTURE

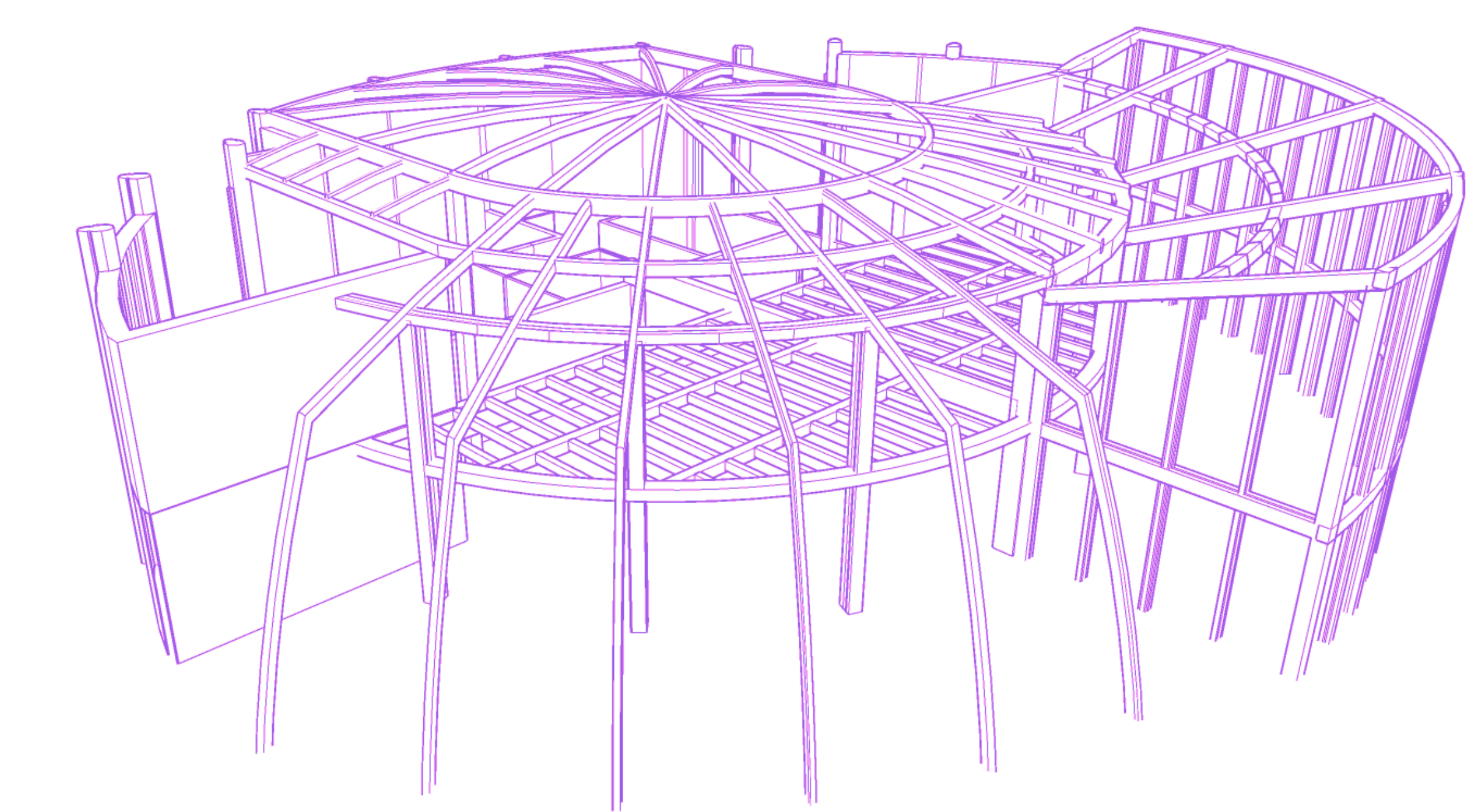

SECTION A-A'



SECTION B-B'



GROUND FLOOR

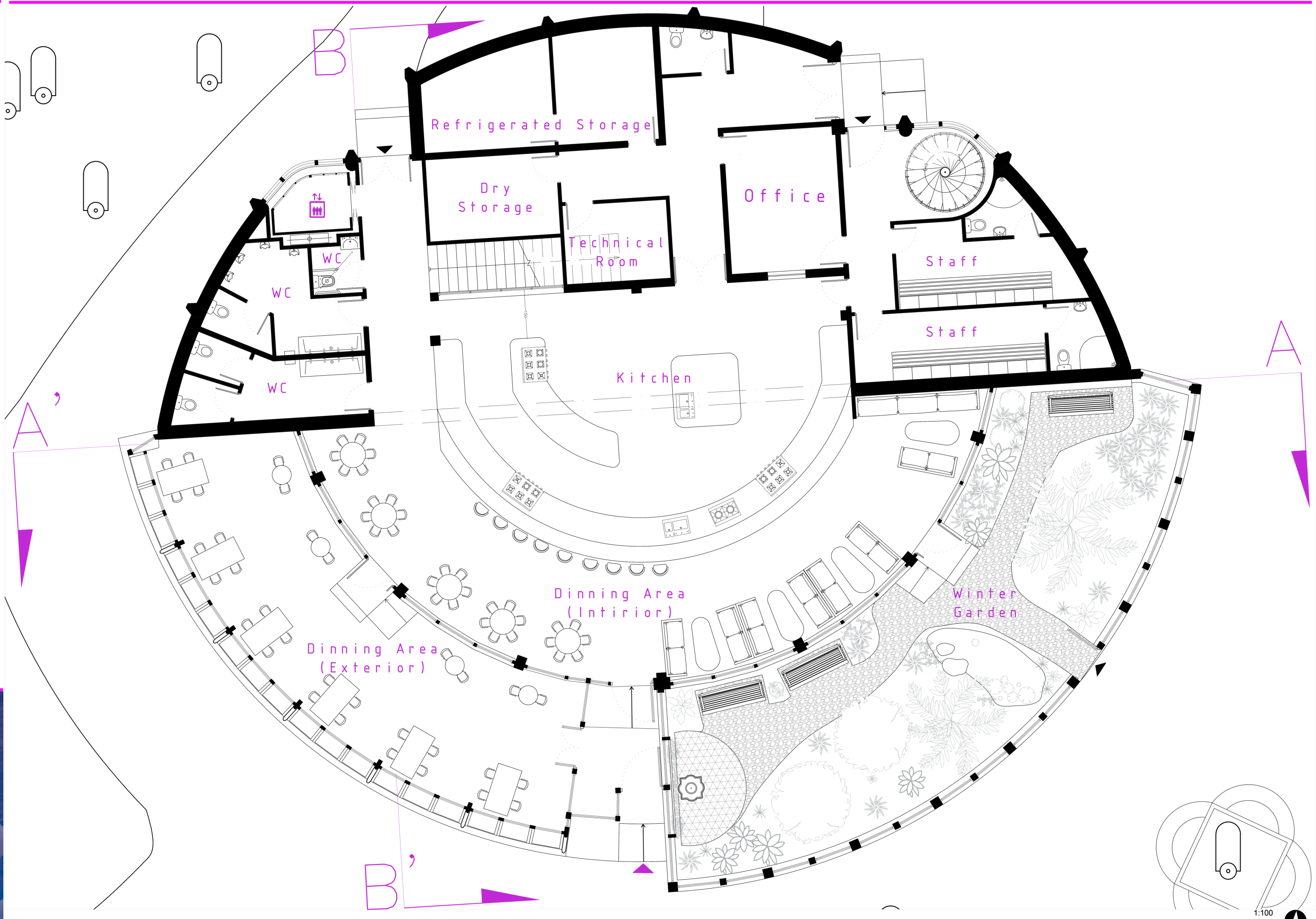

FIRST FLOOR

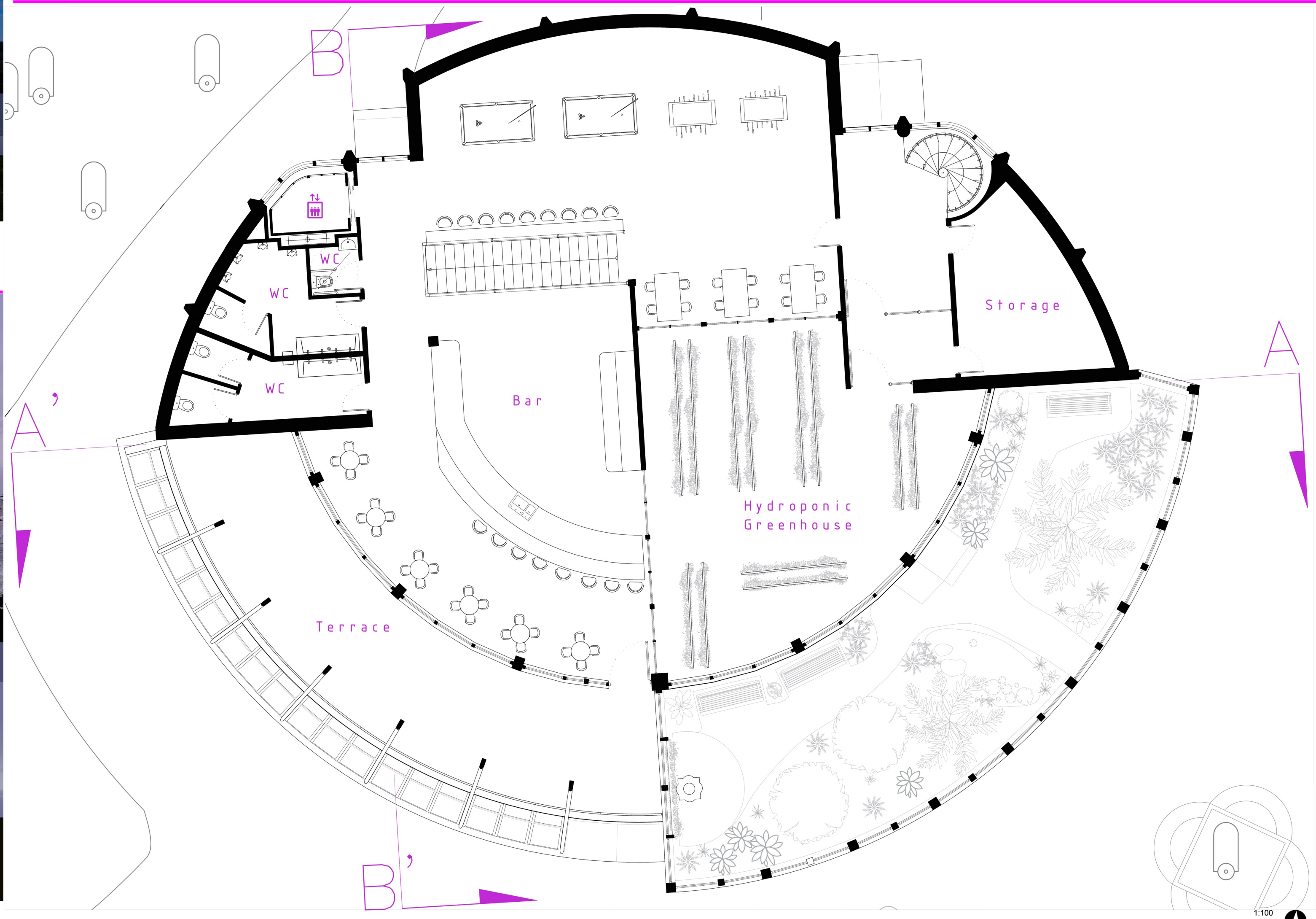

VISUALIZATIONS



Winter garden (Ground floor)



Bar (First floor)



Dining Area & Restaurant (Ground floor)

SIMON CORTES L.

OSTRAVA / park Milady Horákové

ATELIER SITTA - CHMELOVÁ

AT1 - ERASMUS

WINTER SEMESTER 2022