

THE SOUND OF WATER

BREGJE WALKATE

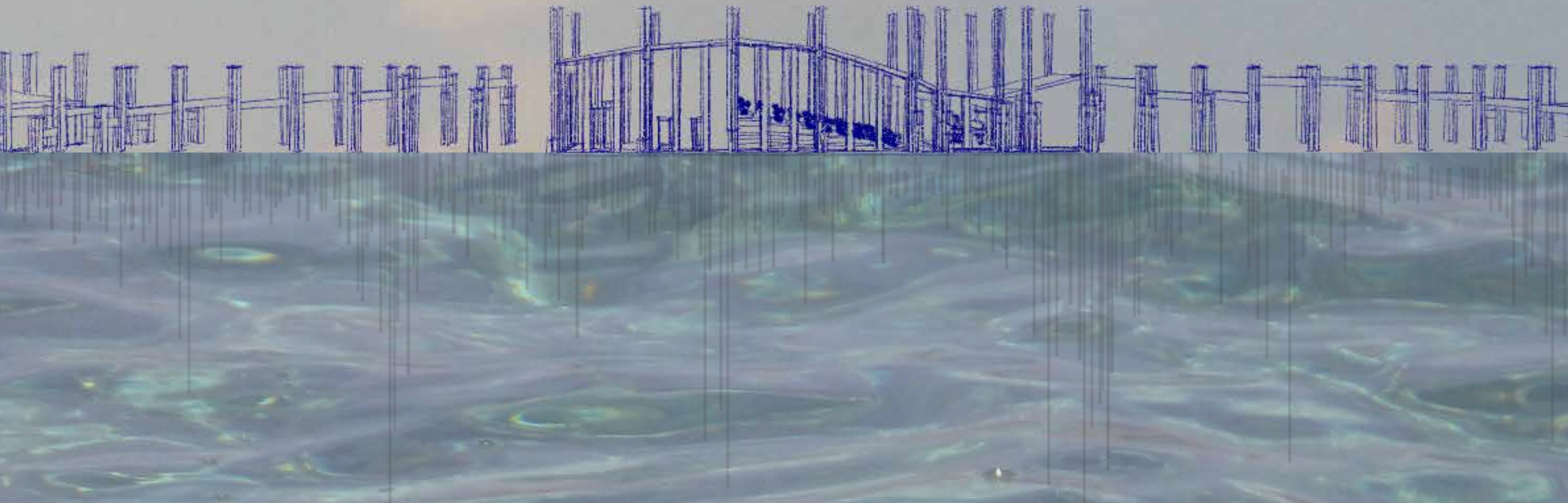

DISTRICT GOALS

More culture, education and social services.

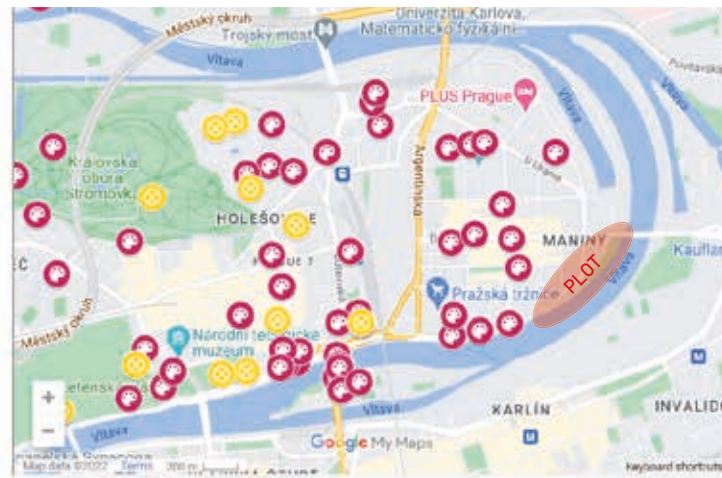

Art in public space

Cycle route A1



Cycle route A1
www.praha7.cz

More playgrounds for children



Playground managed by the Prague 7 Municipal Council

Bring back the nature that has been destroyed during the floods.



August 12, 2002: The Prague Floods

Red: simulated 2002 flooded areas
Blue: probable flood extent if a 2002 event occurred today

GOALS

An cultural educational centre for youth.

Where children can explore and experience all performance arts.
A safe place where they can learn in an interactive environment.



Promote the heritage of Prague and the district.

The heritage of Prague and the district is visible and can be felt.



Make the Vltava meander accessible.

The area will be embraced and integrated with the Vltava river.
The plot will open up and connect to the water.









Create a flood resistant green route along the riverside from Letenská plán to Stromovka.

A green route alongside the river will amplify the nature in the district and create more possibilities for pedestrians, cyclists and sporters to explore and enjoy the district.



FUNCTIONS

	Restaurant for 30 people	60 m ²
	Performance Art Centre of Education (PACE) Elementary education – 9 years Art Performance education and practise	2000 m ² in total 125 m ² per classroom of 20 pupils 600 m ²
	Interactive Playground	1400 m ²
	Pavilion	20 m ² per stage
	Park Area – accessible	4000 m ²
	Park Area – only for community	500 m ²
	Nature Area – not accessible	Rest of the plot

Total area of the plot is 30.000 m²

INSPIRATION

The movement of sound and water

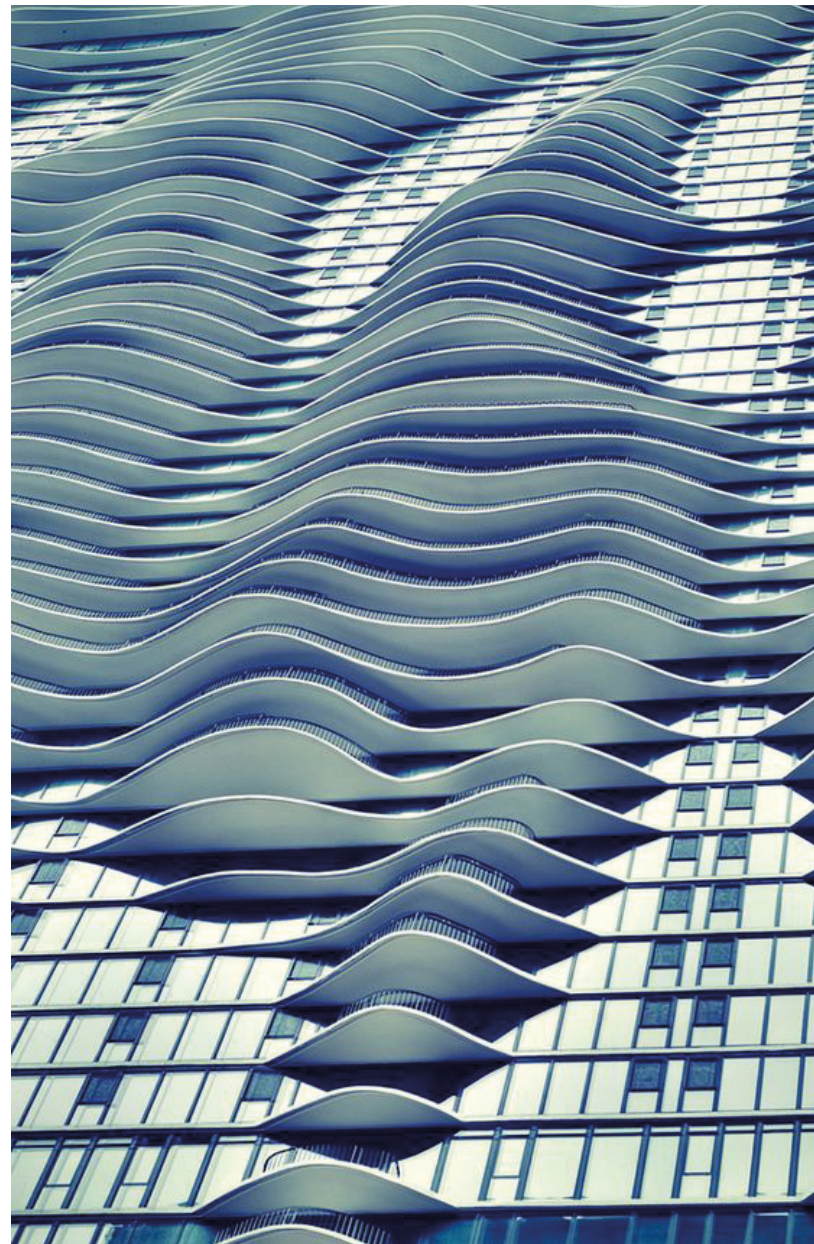
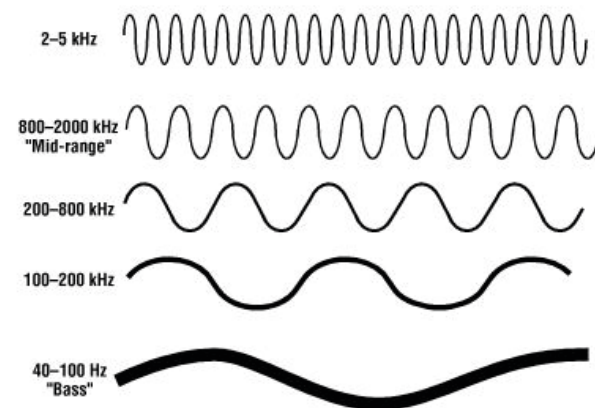
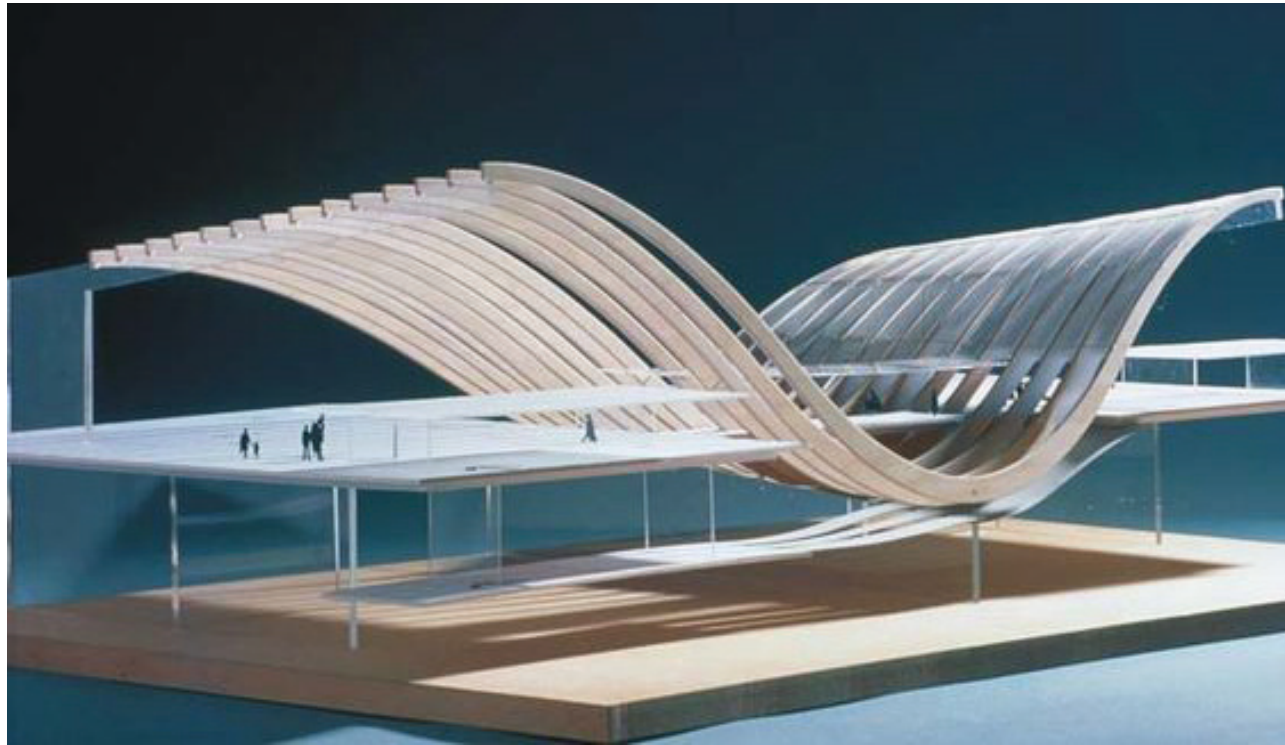

CONCEPT HORIZONTAL

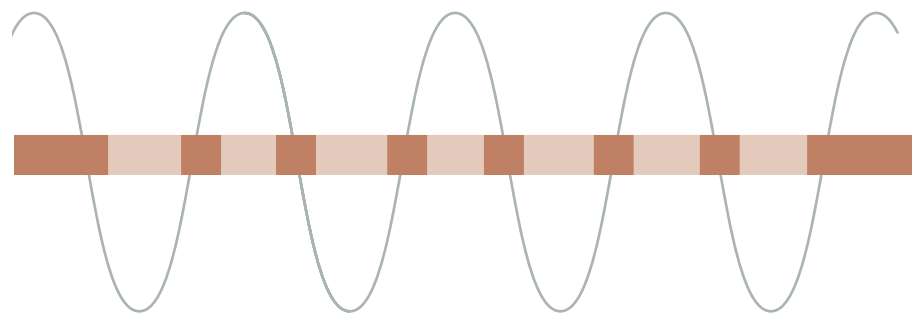

building program is a longitudinal wave, landscape route is a transverse wave

CONCEPT VERTICAL

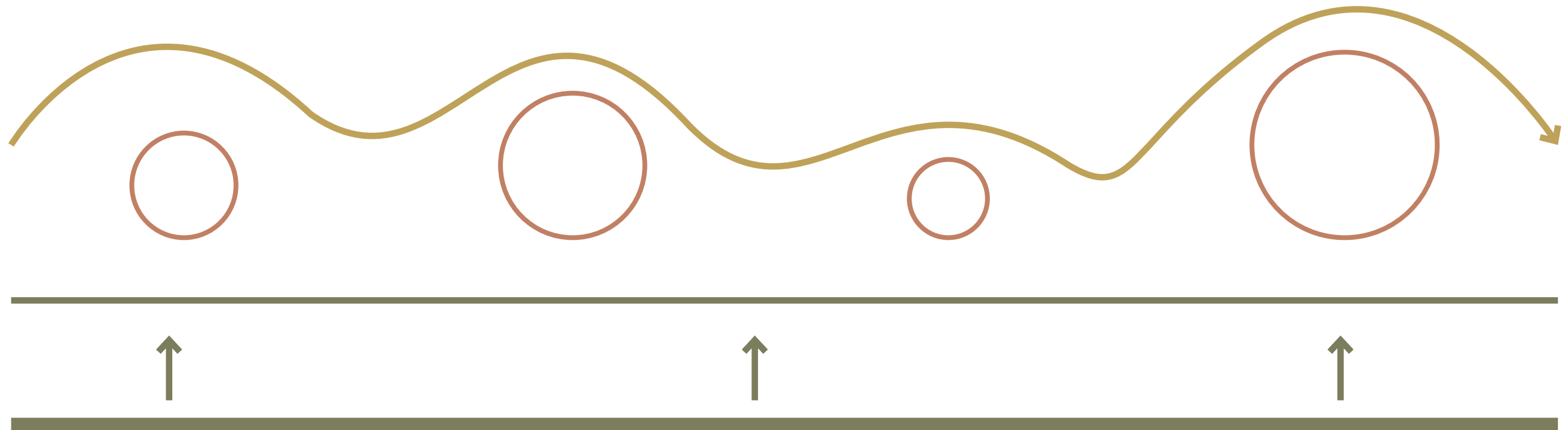

Playfull route over build environment

Building program per function

Pathway lifted against the flood

CONCEPT SITE PLAN

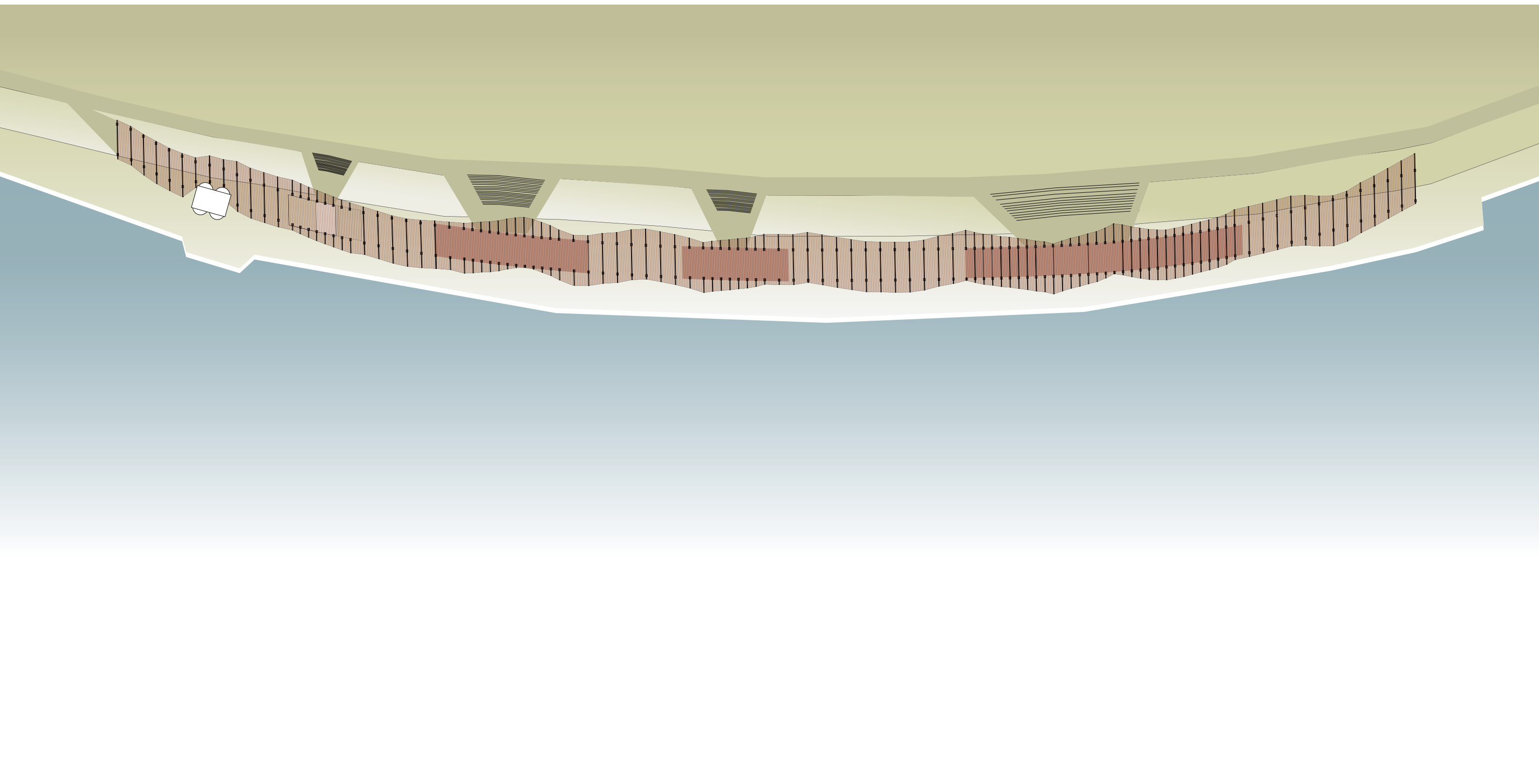

BEARING STRUCTUE

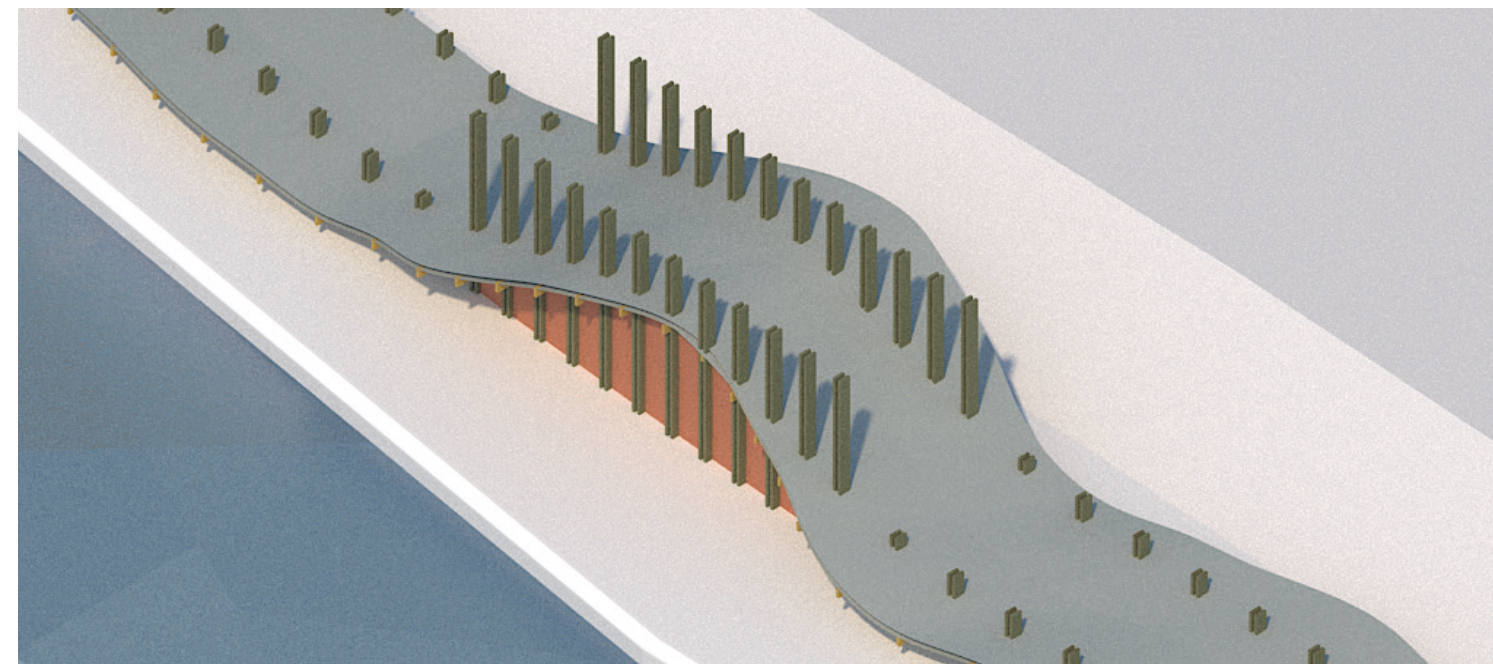
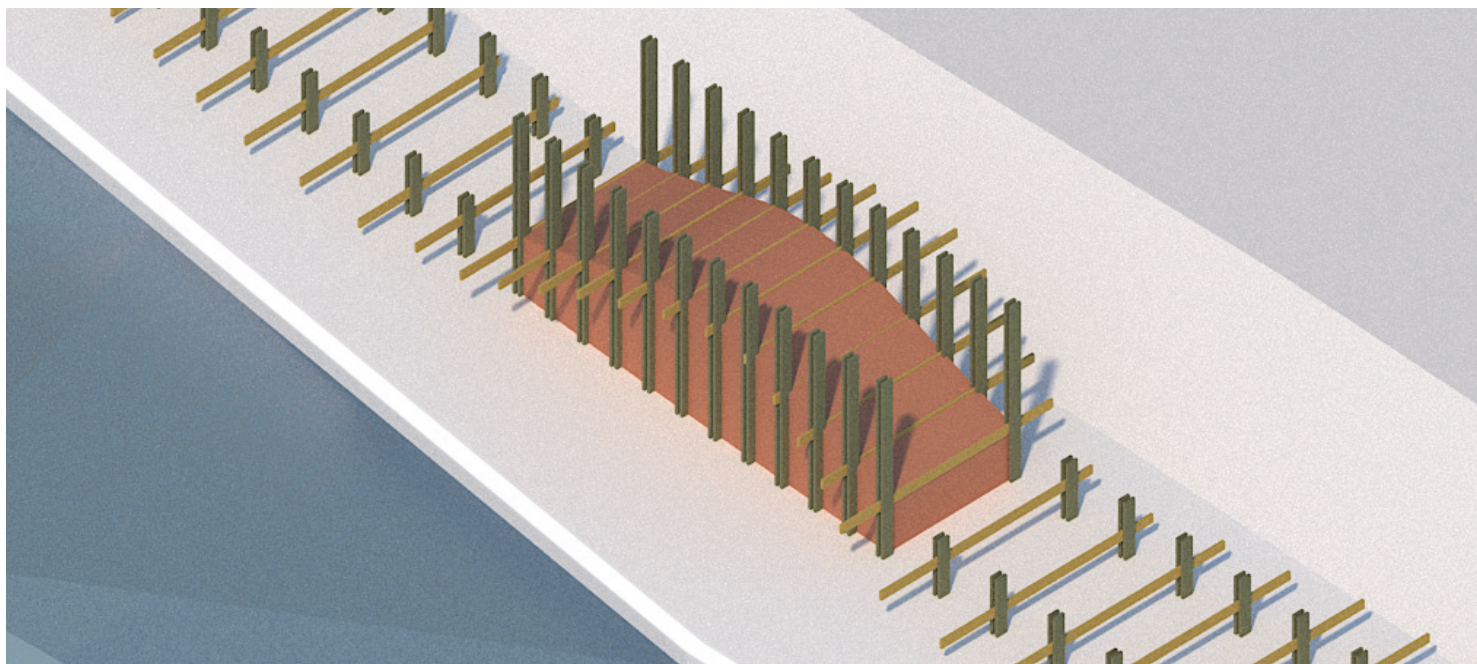
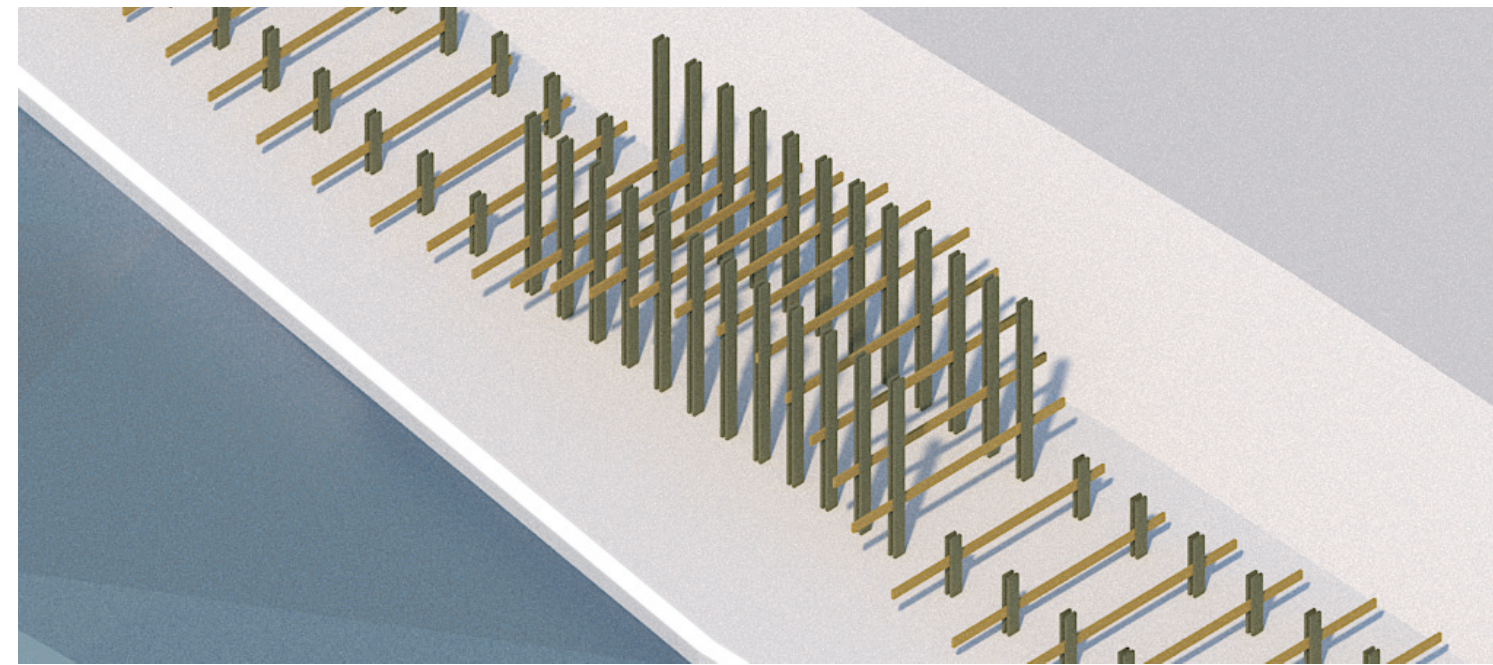
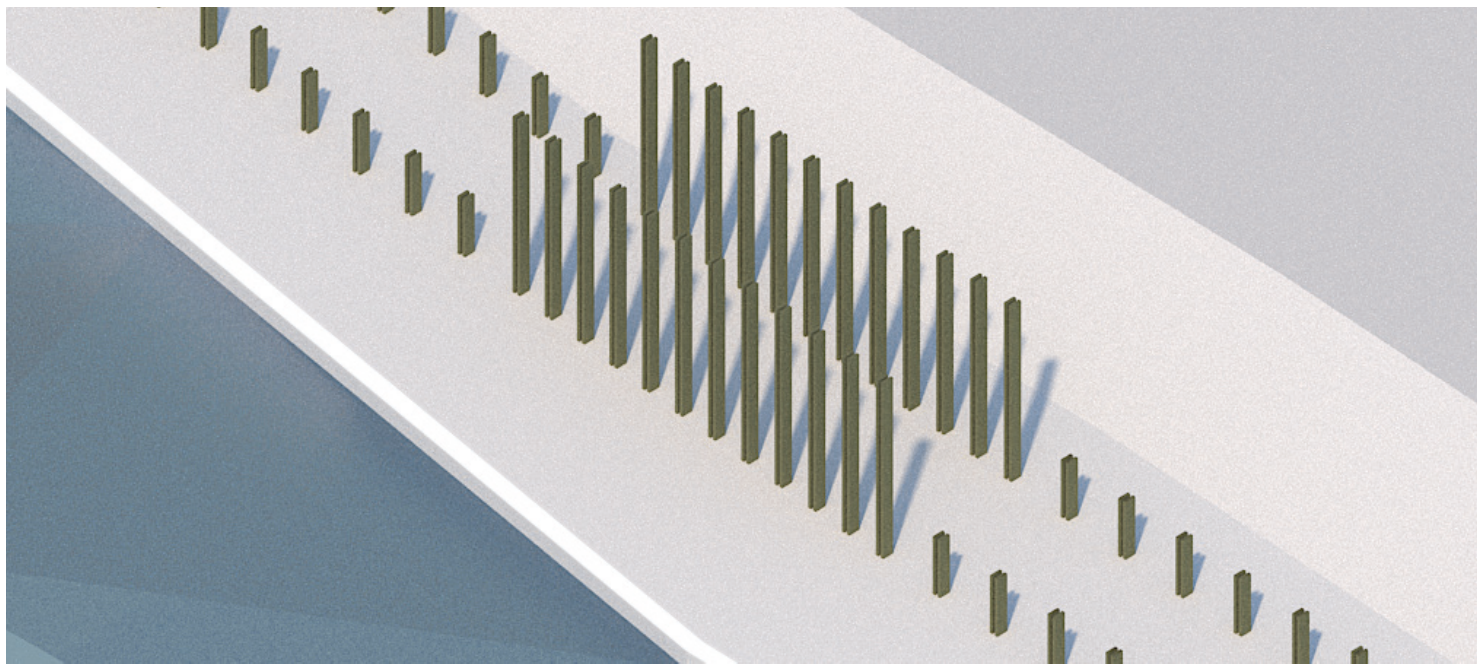

BEARING STRUCTURE DETAIL

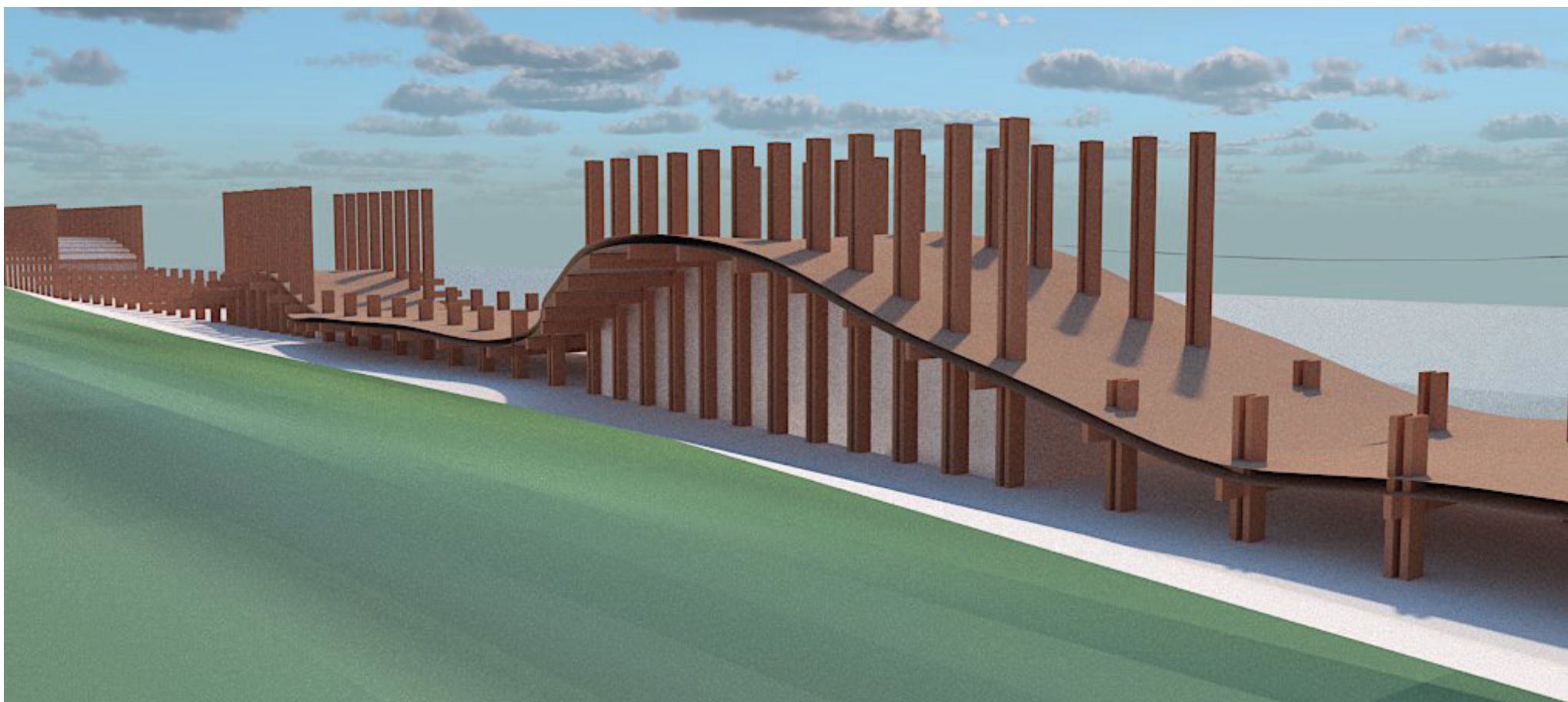

Bearing structure

Column:	Glulam wood, double 800x200 mm
Primary beams:	Glulam wood, 600x200 mm
Secondary beams:	Glulam wood, 200x100 mm

Facade

Open	Glass curtain wall placed on the inside of the bearing structure
Closed:	Stone panels To give the feeling you're underground

MATERIALIZATION

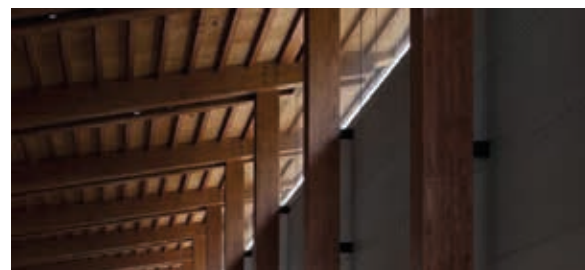
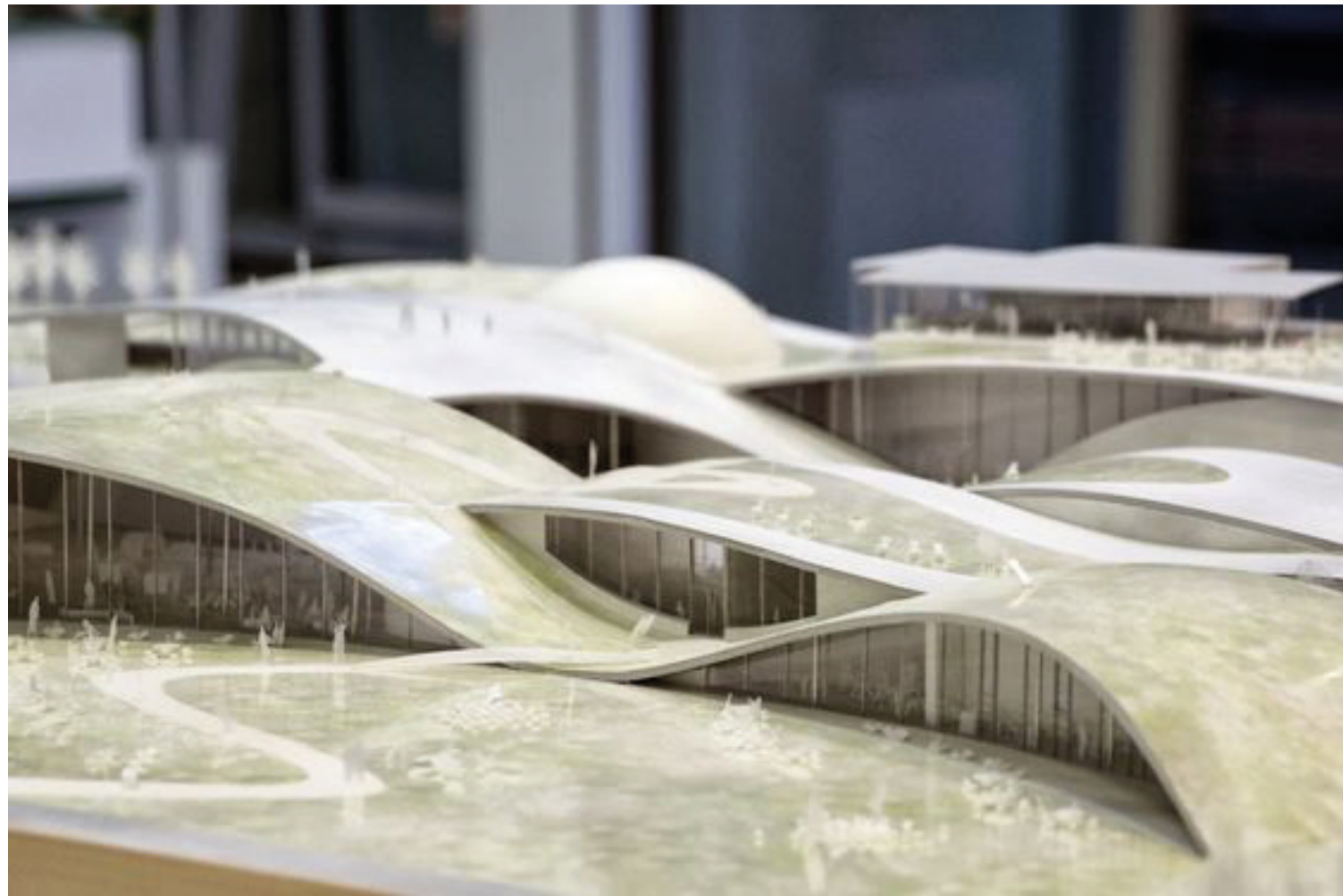

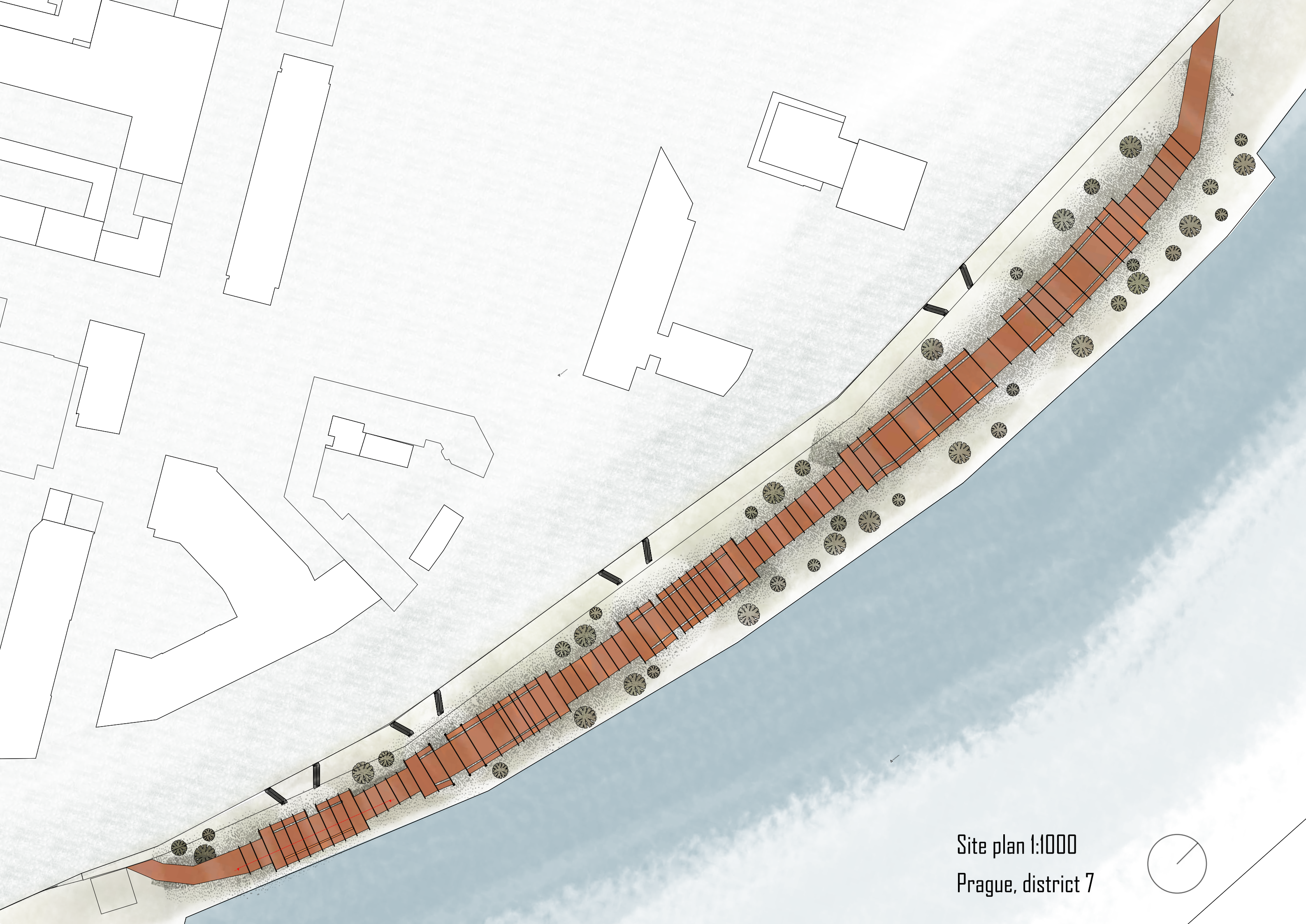

Site plan 1:1000
Prague, district 7



RESTAURANT

THE SOUND OF WATER

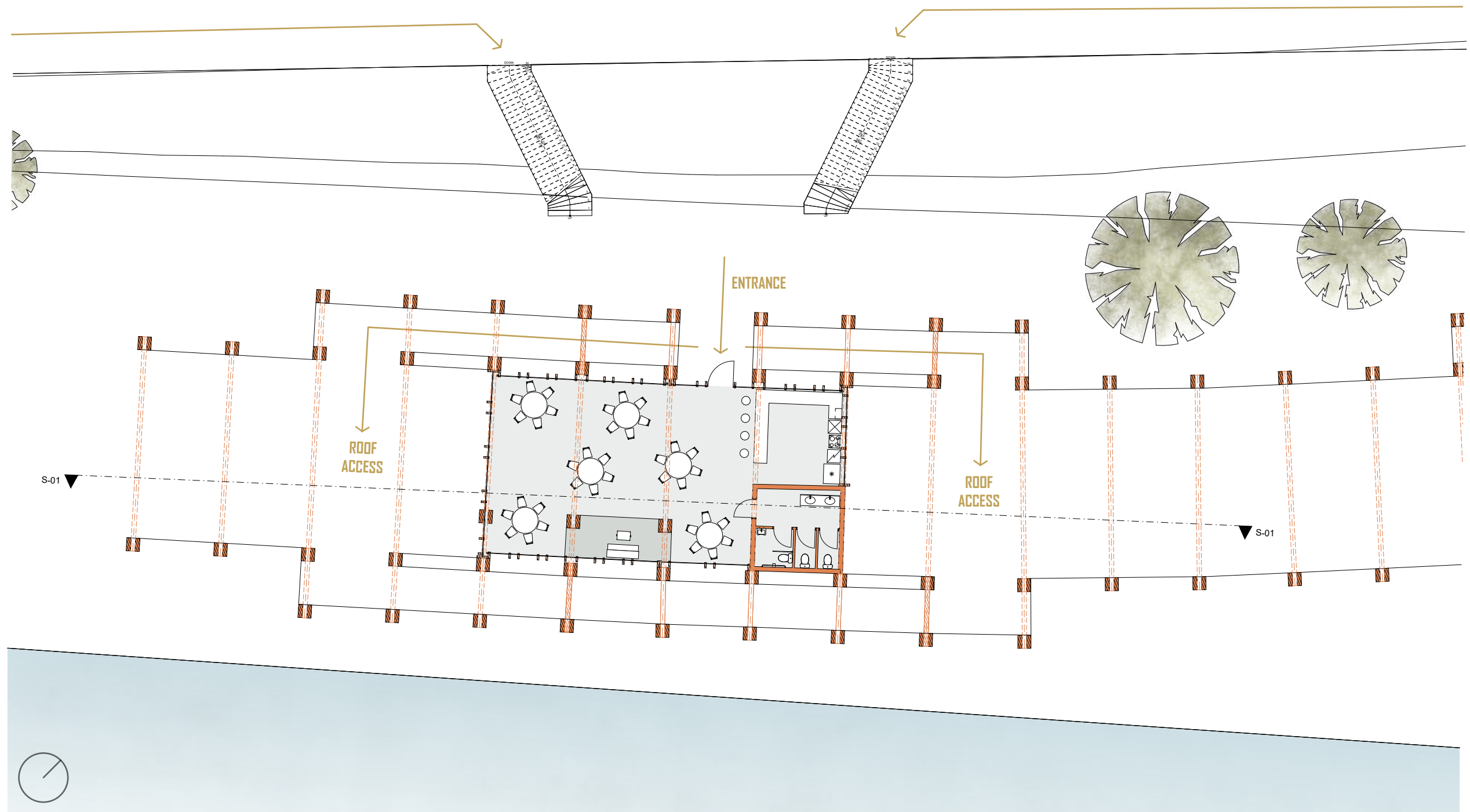

Floor plan 1:200

Restaurant



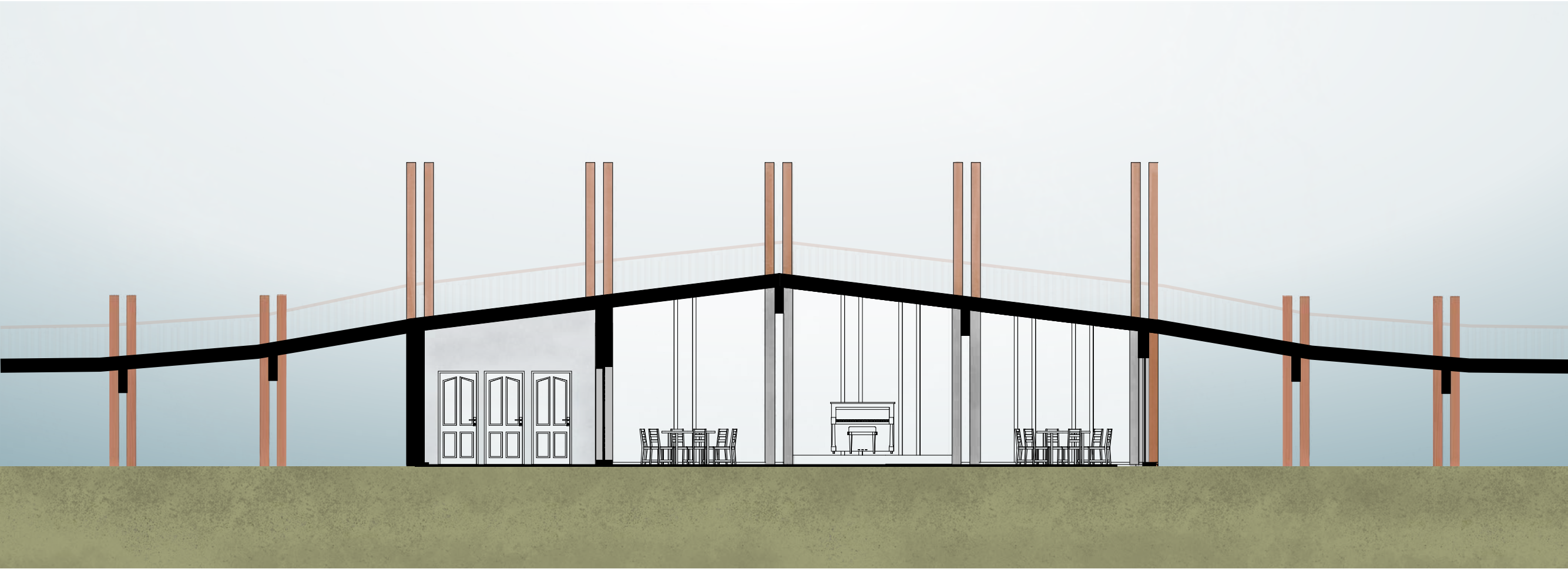

Section S-01 1:100
Restaurant

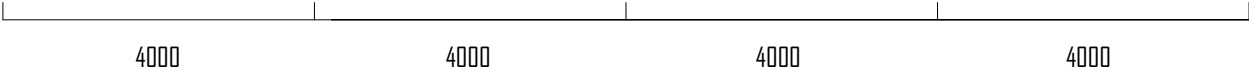

THEATRE HALL

THE SOUND OF WATER

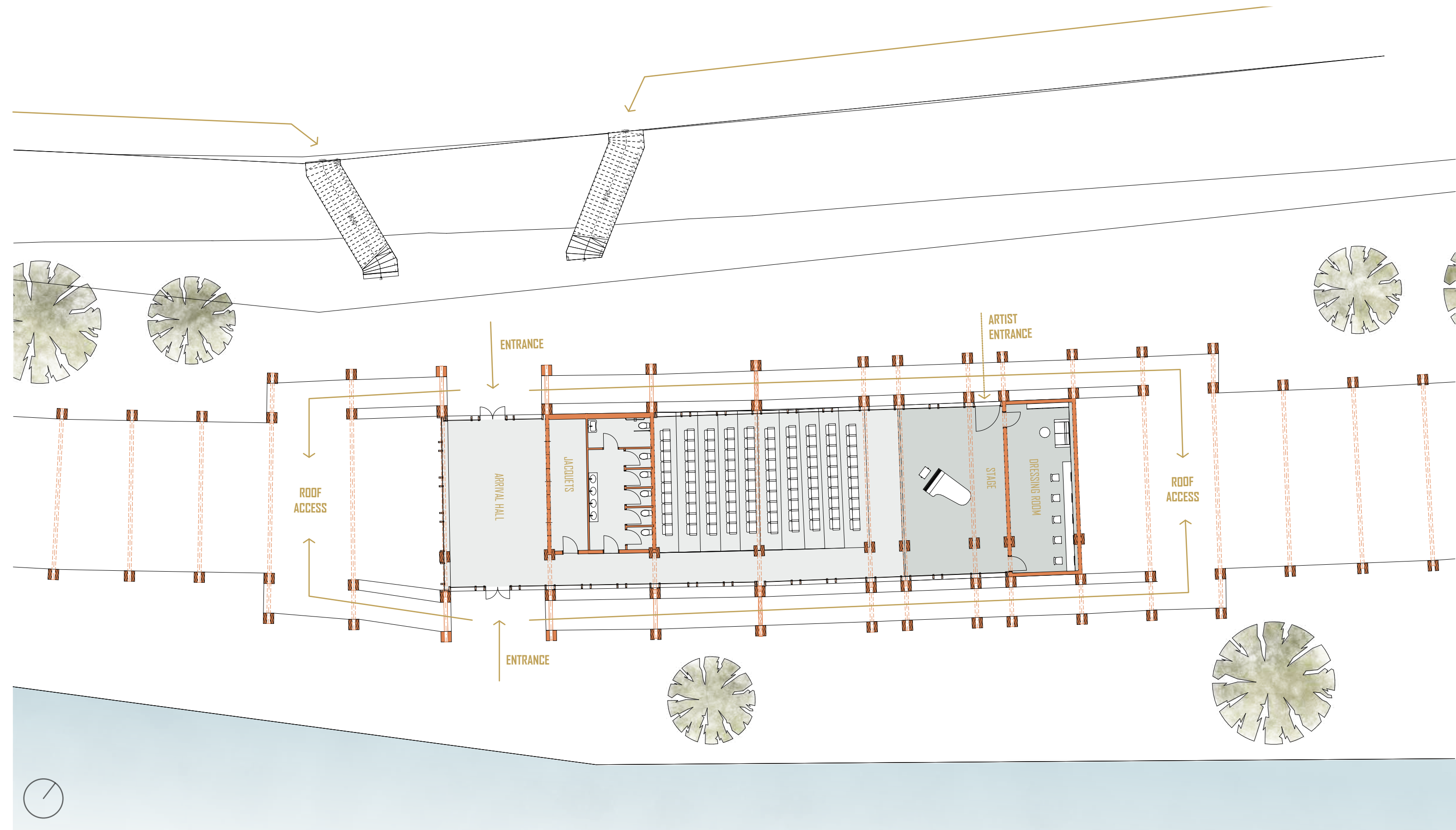

Floor plan 1:200
Theatre Hall



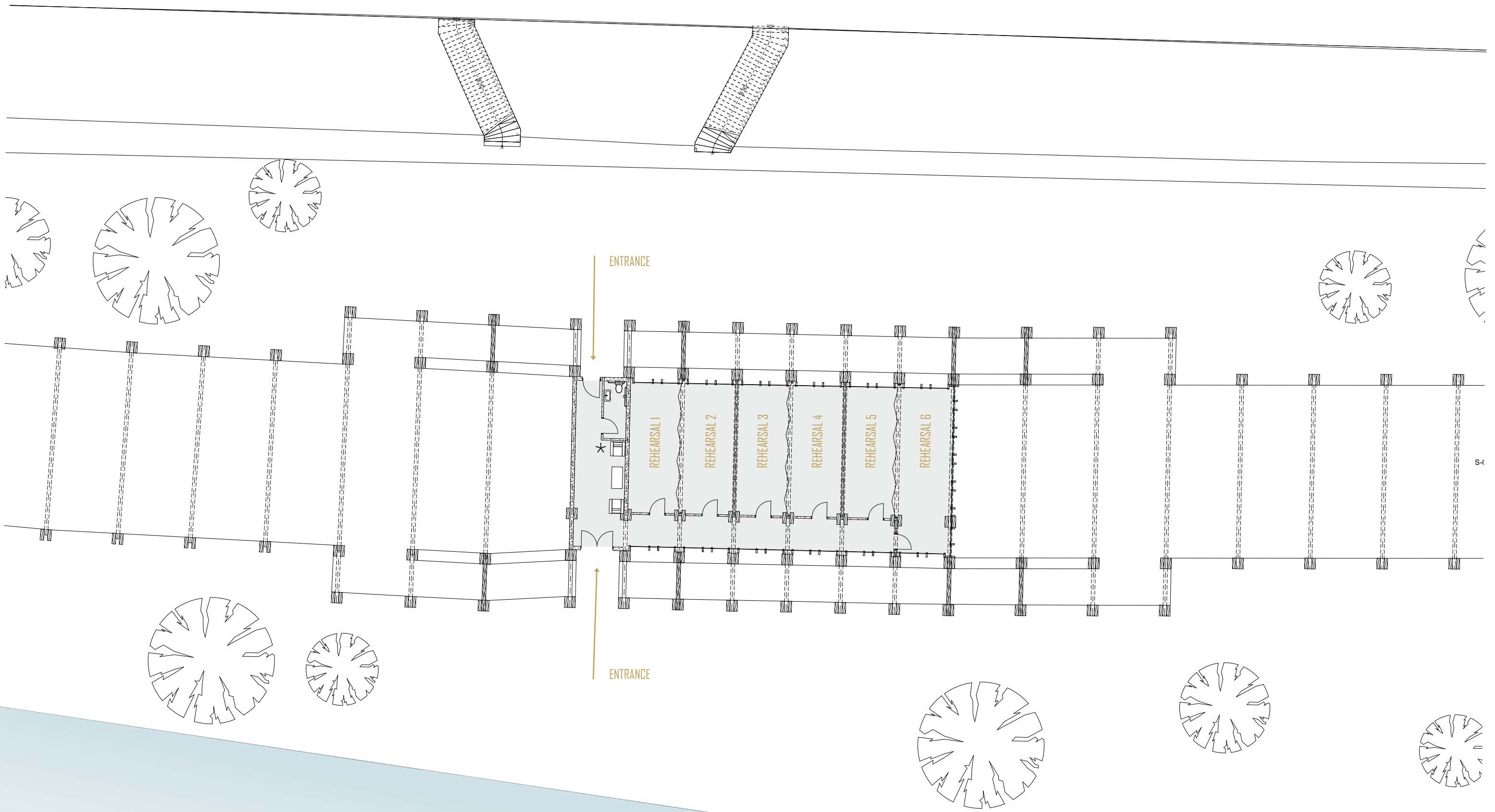

FLOOR PLAN 1:200
REHEARSAL ROOMS



EDUCATION CENTRE

THE SOUND OF WATER

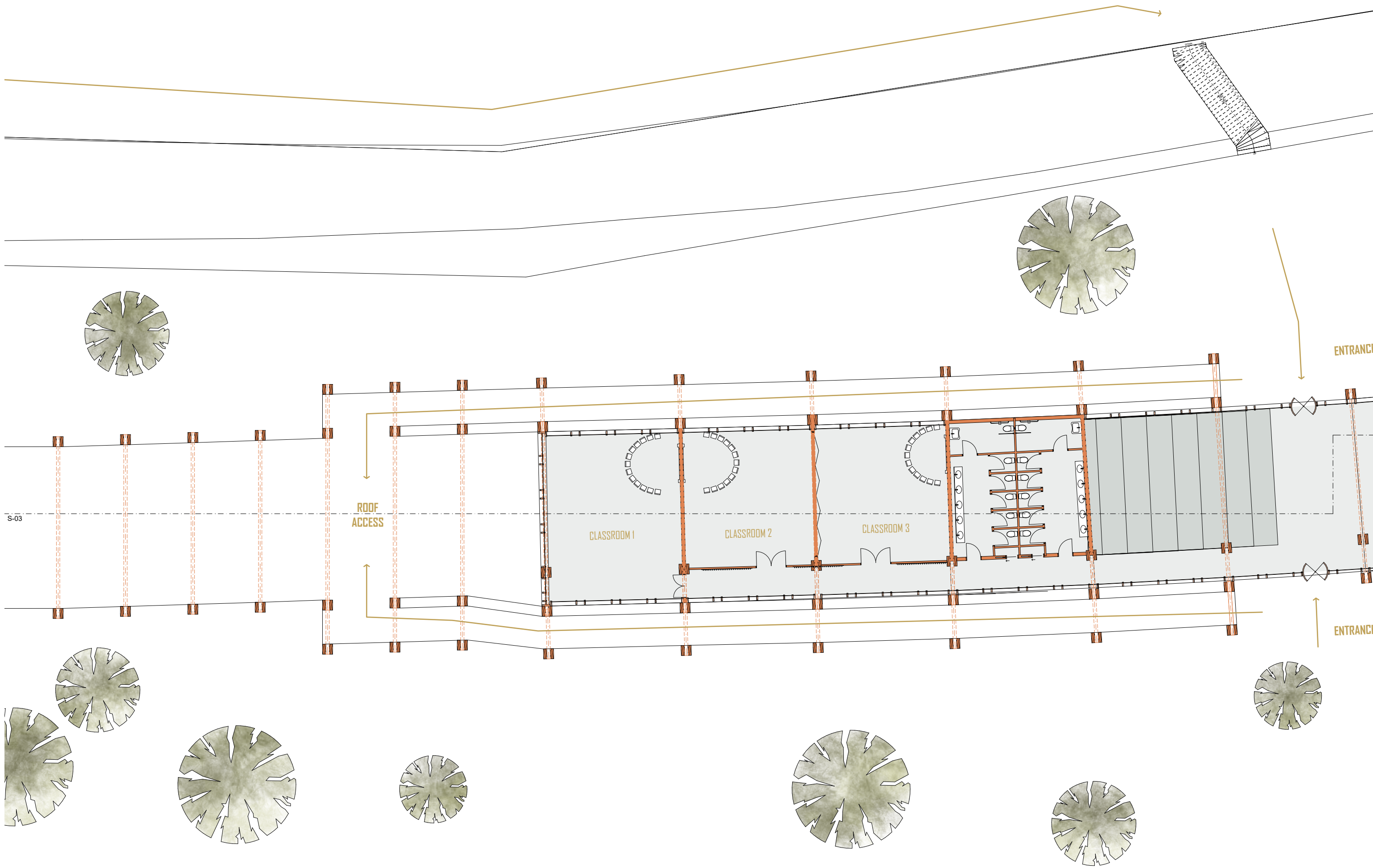

FLOOR PLAN 1:200
EDUCATION CENTRE - GROUND FLOOR

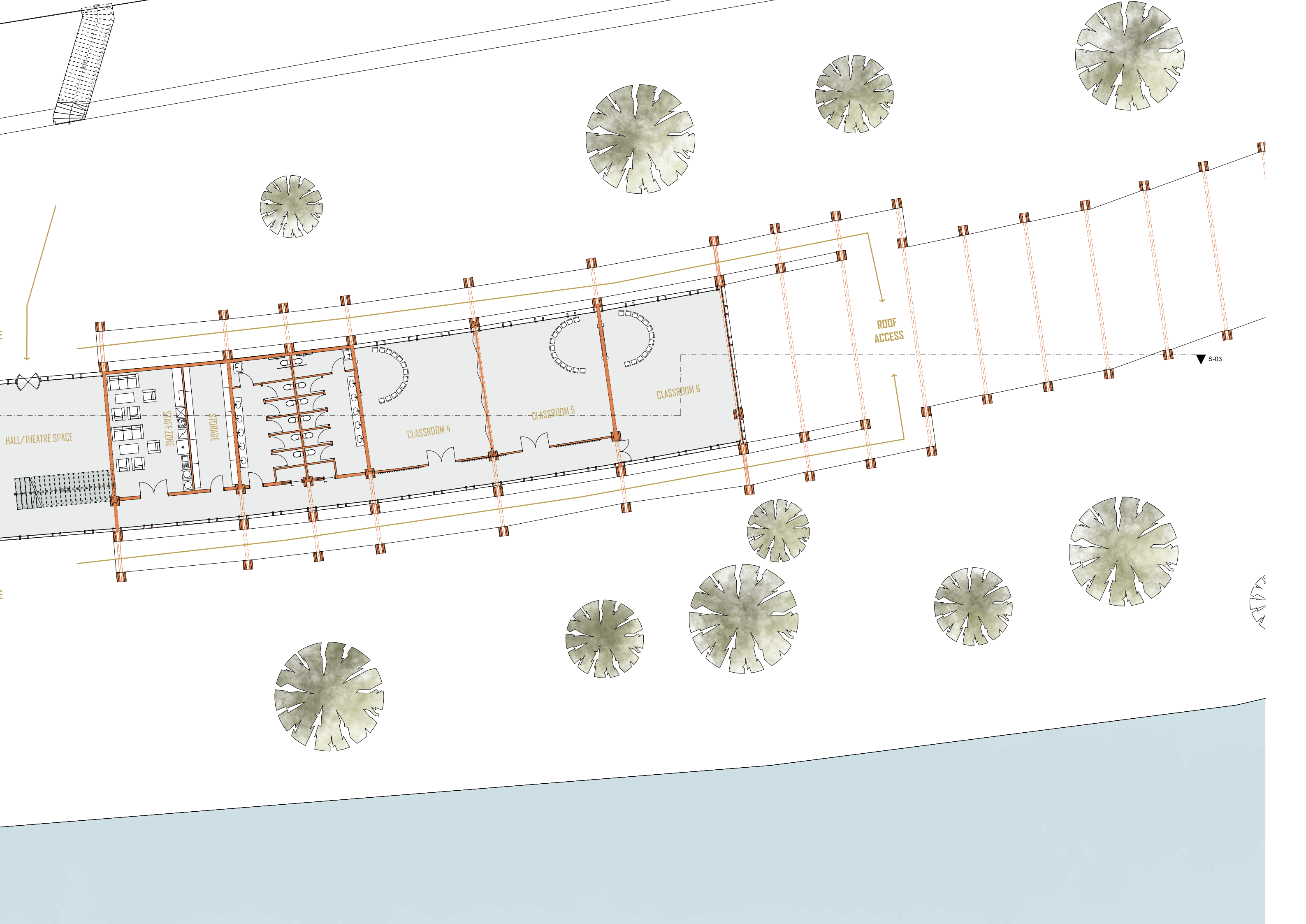

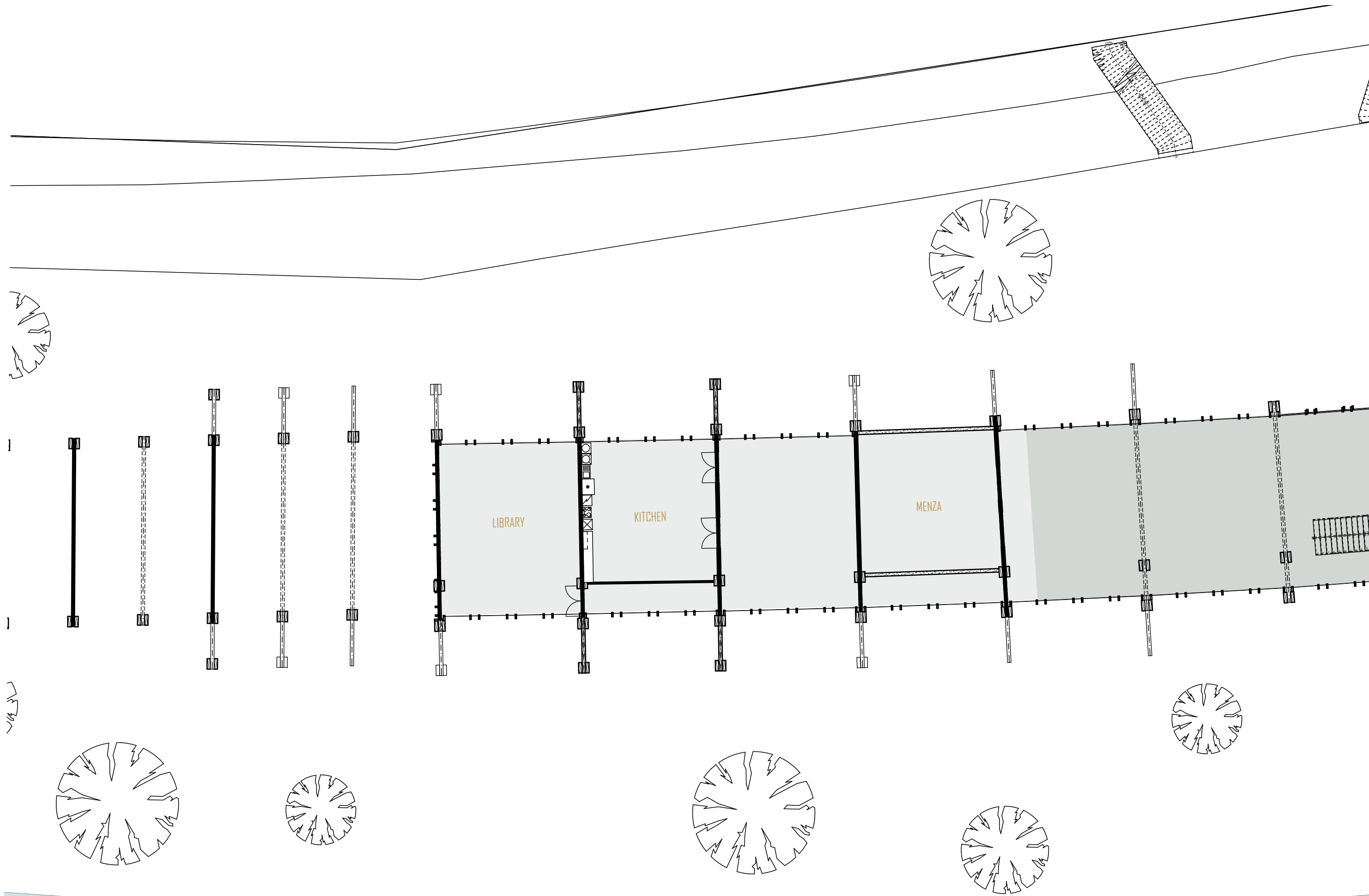

FLOOR PLAN 1:200
EDUCATION CENTRE - FIRST FLOOR

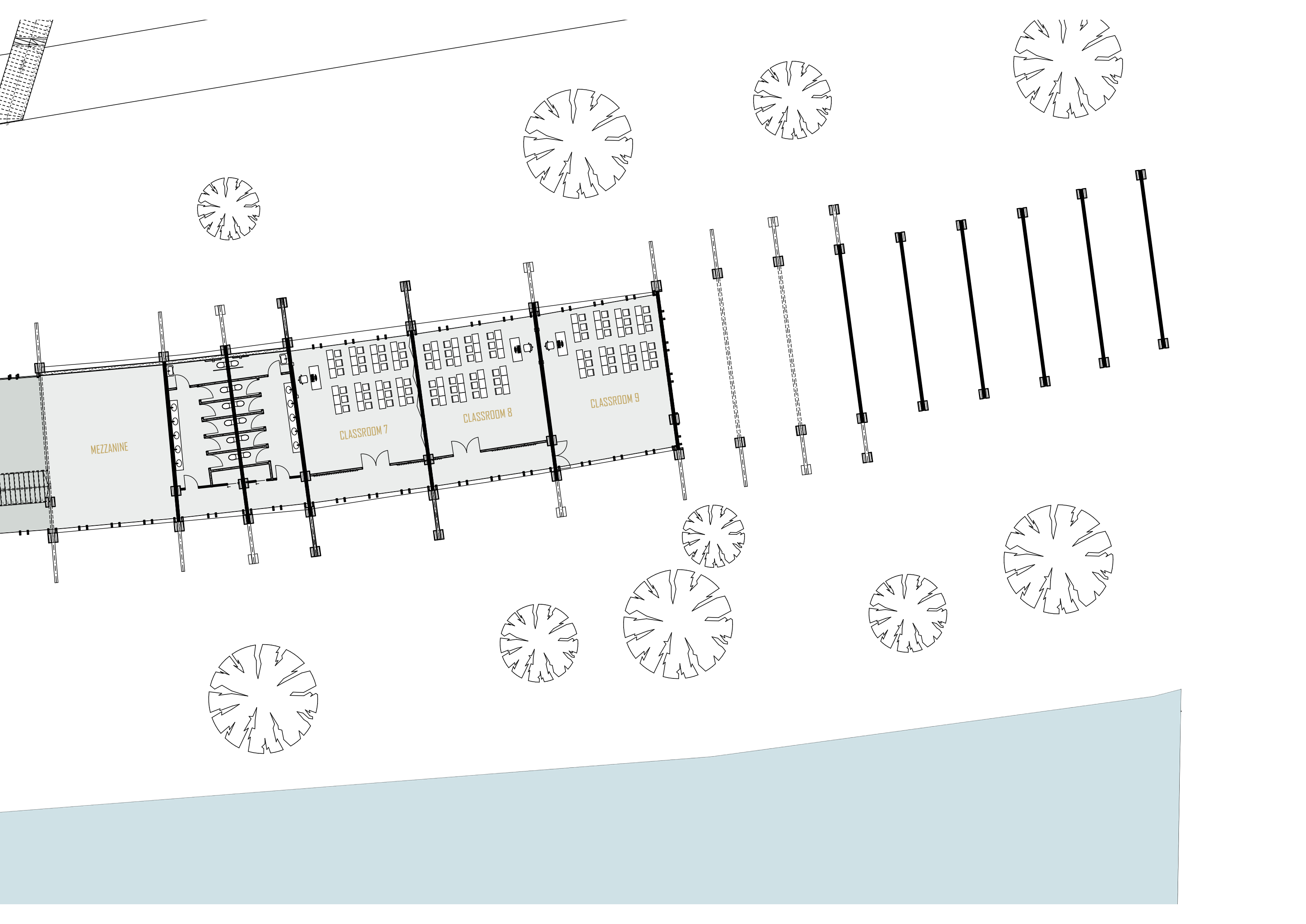

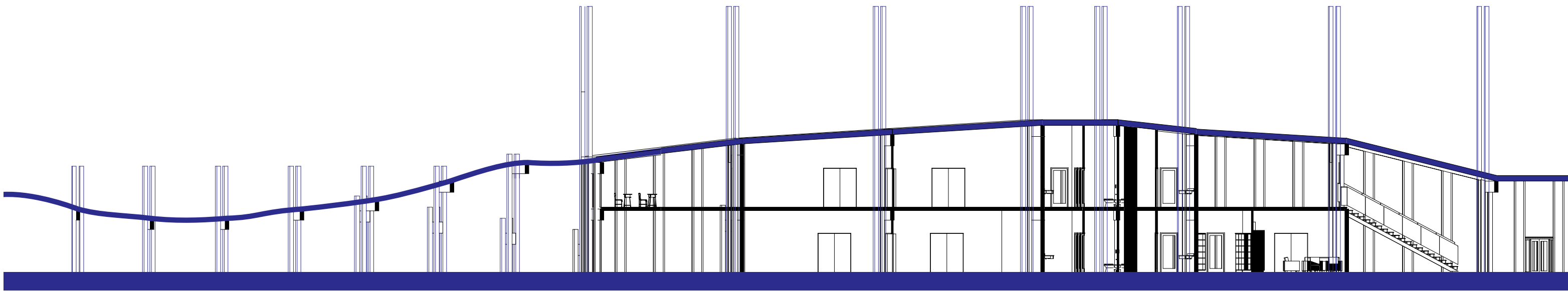

SECTION 1:200
EDUCATION CENTRE

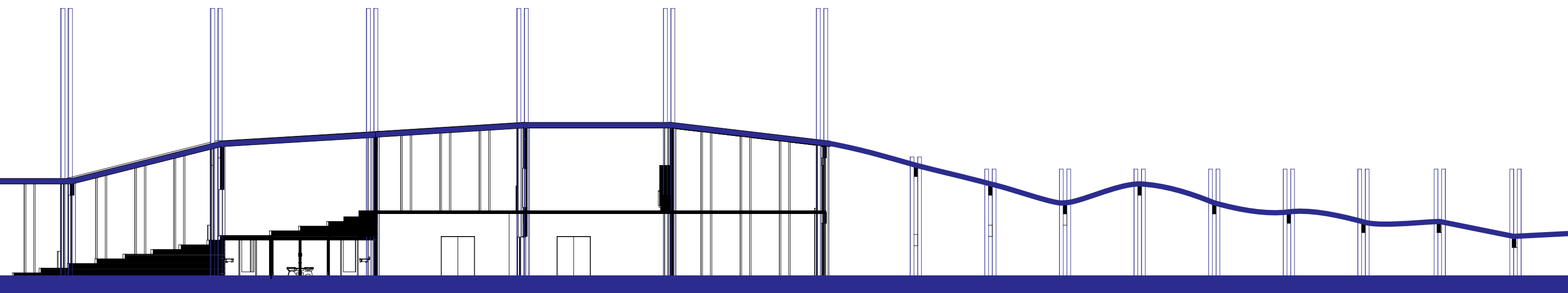



EDUCATION CENTRE



EDUCATION CENTRE - MAIN HALL