



Praha-Zahradní Mesto



ZAHRADNÍ MESTO

1. CURRENT STATE



2. VISION - GOALS

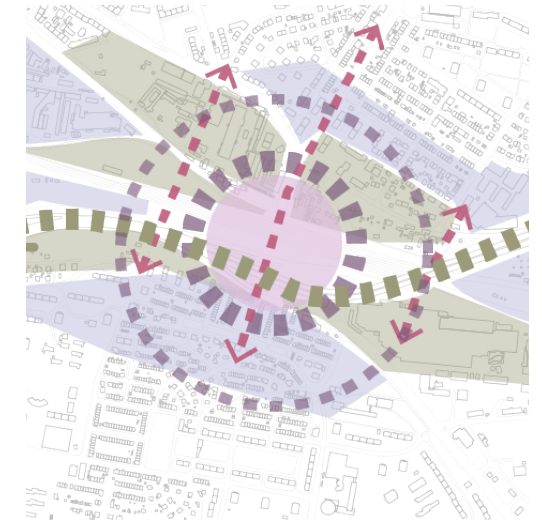

3. CONCEPT



4. PROPOSAL

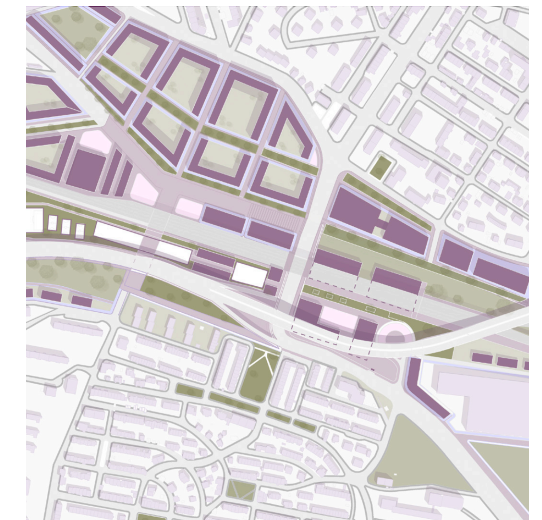

CURRENT STATE
ANALYSIS

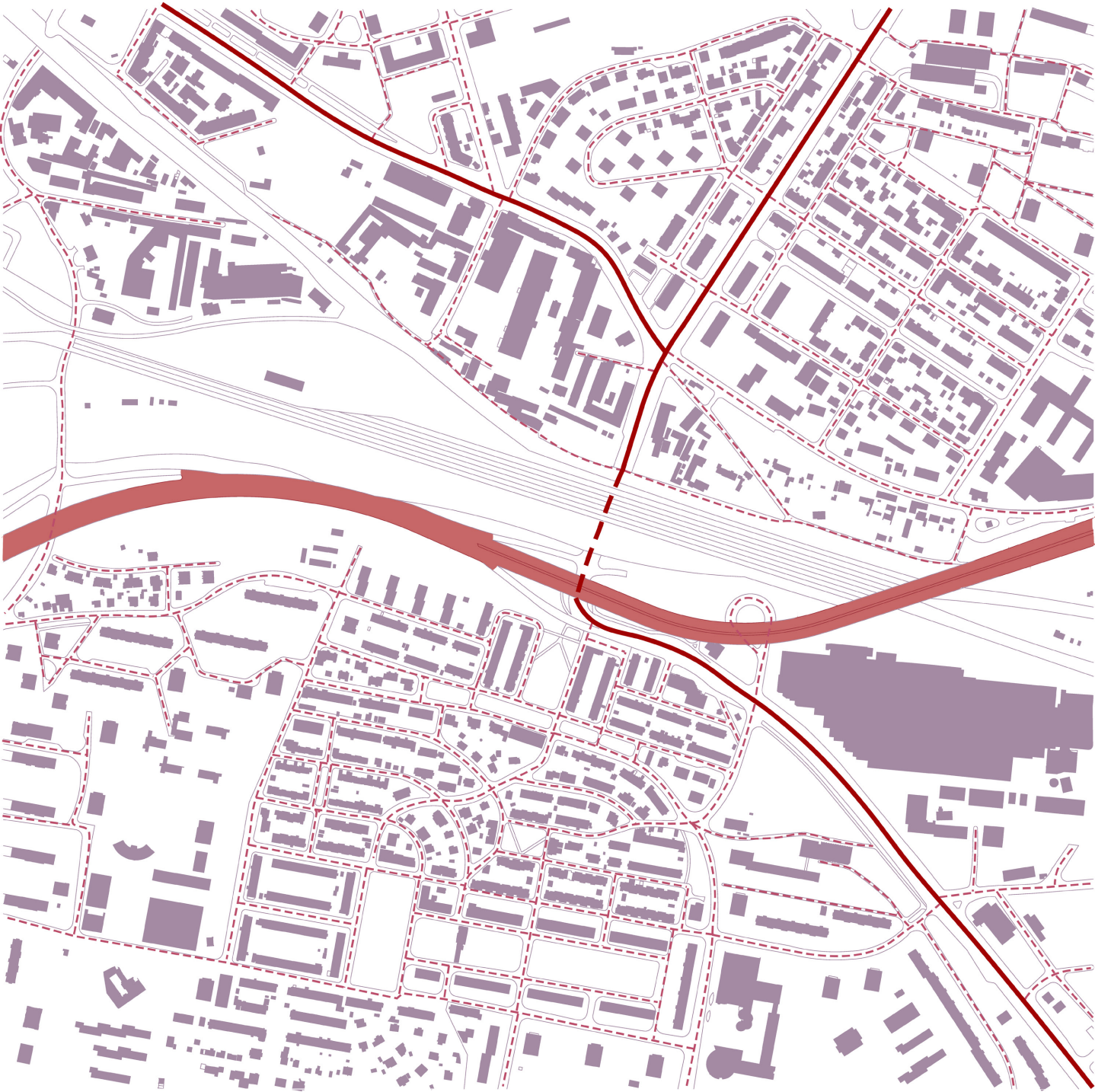

- secondary roads
- primary roads
- highway

PUBLIC SPACE

CURRENT STATE
ANALYSIS

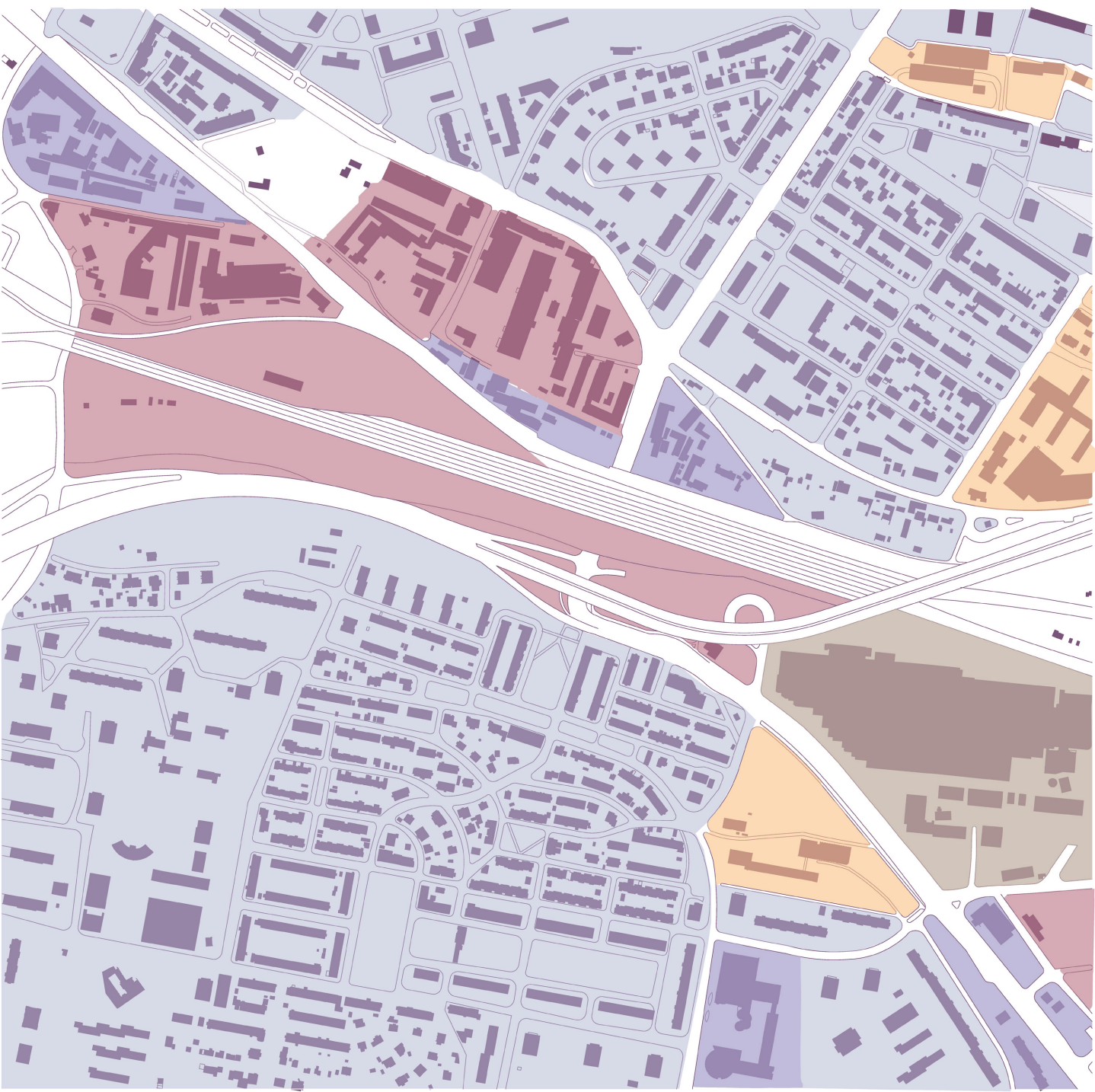

- services
- educational
- industry
- housing
- commercial

LAND USE

CURRENT STATE
ANALYSIS

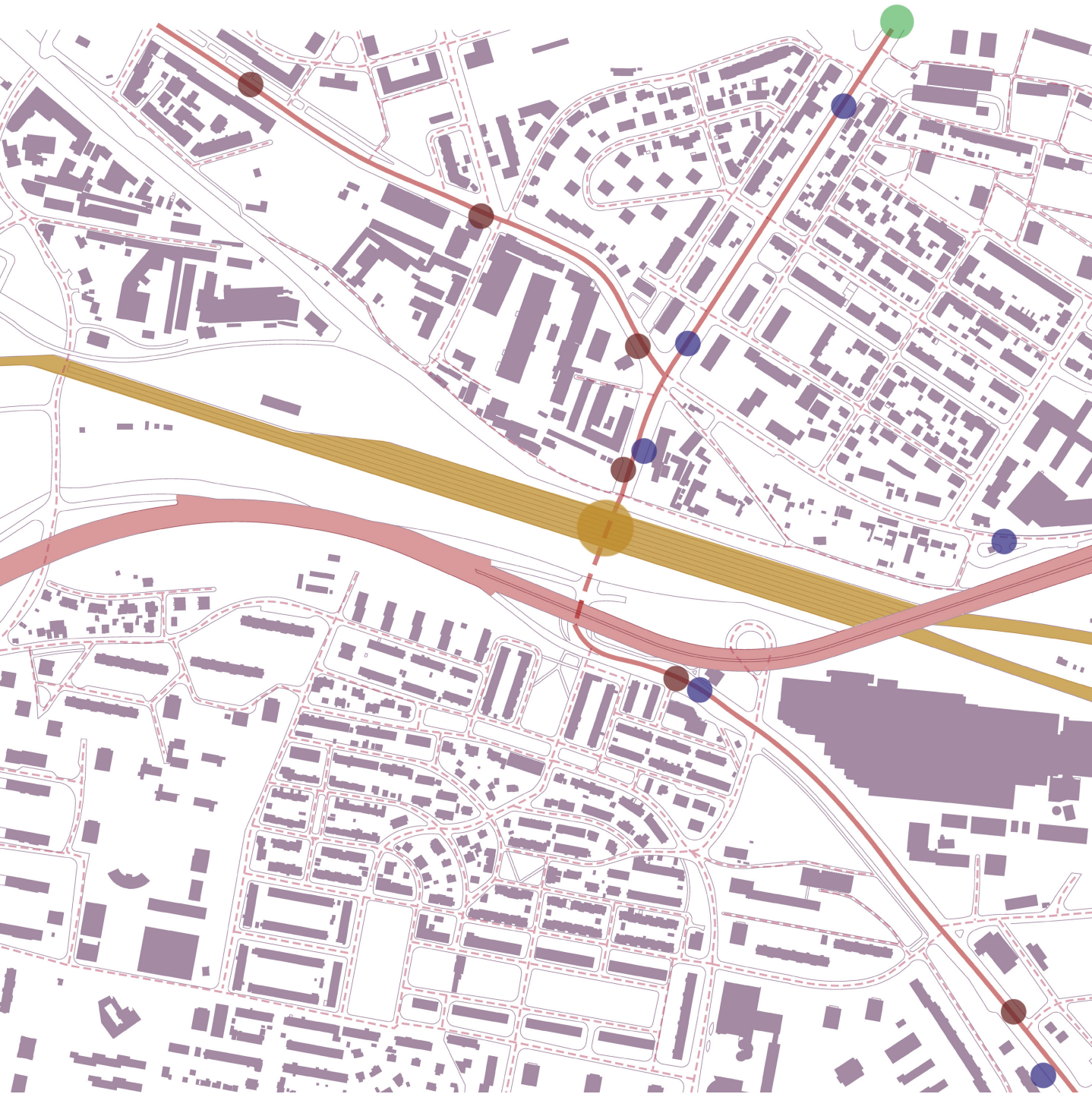

- railway station
- tram stop
- bus stop
- metro station

TRANSPORTATION

CURRENT STATE
ANALYSIS

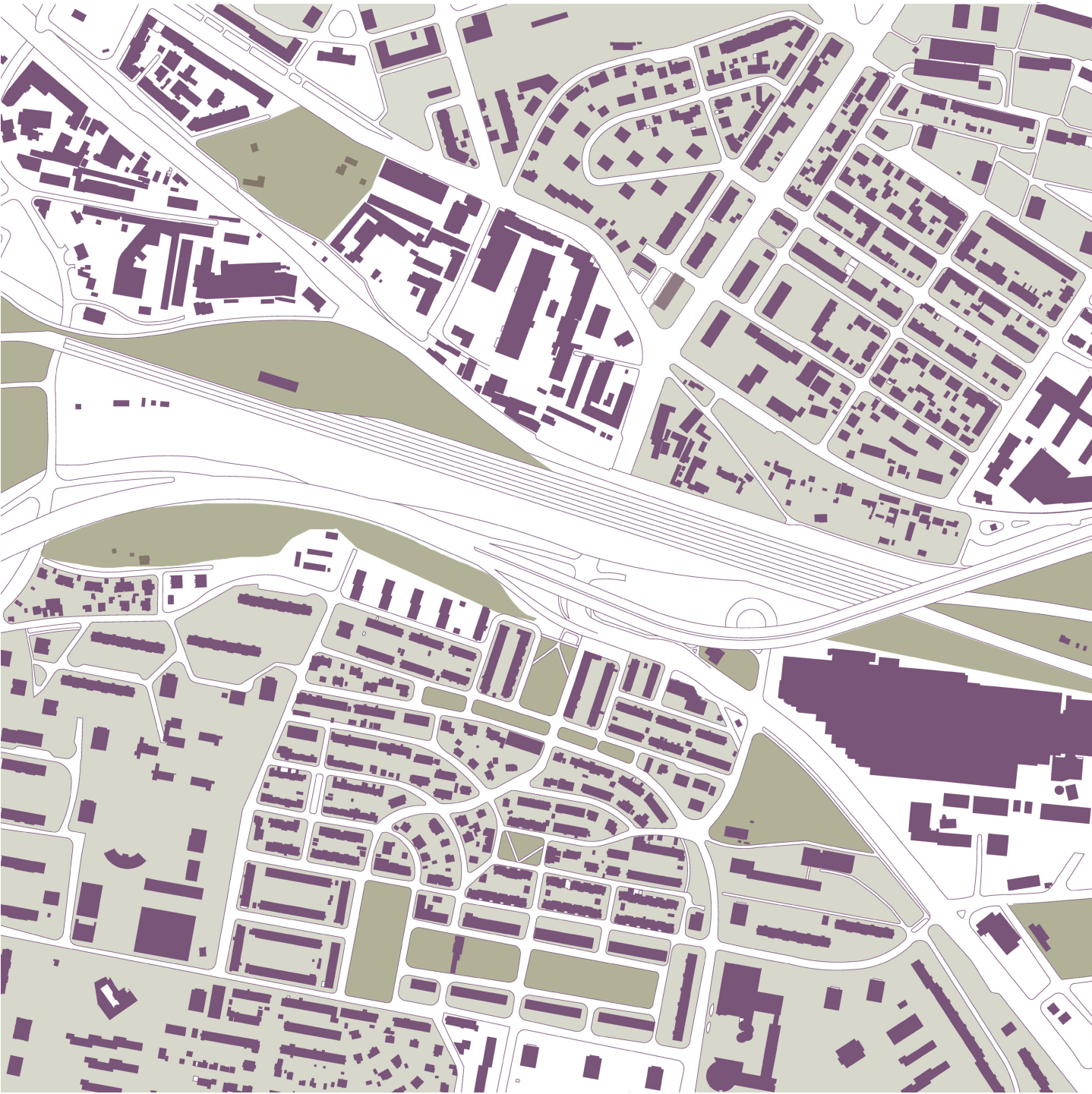

- private green
- public green

GREEN SPACE

CURRENT STATE
SITE PHOTOS



CURRENT STATE
SWOT

Green empty area with potential for being a park or garden .
Transport connection between east and west
New station development, good accesibility, and modern proposal for the area.
8.Development areas
Existing industry and storage warehouse facilities can be removed to make space for local economy growth and for public usage.

Development of empty space under the highway and near the gas station.
Terrain of site is varied which is helpful for various design elements.
There is enough unused area to create a local commercial center within 2-3 km radius.
Density - We can add influx of people in the proposed recreational/cultural centres.

Manufacturing industries and storage warehouse take up the most important spaces near the tracks and highway.
No barrier free spaces , have to be designed
Less access to pedestrians in the housing development.

Empty space between road.
There no use or access
Housing complex with no public and friendly development. Walking in this area feels like walking next to a fast road.
Lack of recreational spaces for daily use.



Cycling track near the abandoned railway track at north of station.
Recreational area design and advancement of eco system at south of station.
Possible connection between north and south for open space that need to be done.

Undeveloped areas near hilly terrain feels unsafe to walk in.
Creating more cultural, shopping, recreational centres may increase density of people and transport.

GOAL - VISION

Regeneration of the **ZAHRADNI MESTO** railway station with a recreational green development. Joining zahradni mesto and Strasnice with an infrastructure of elevated corridors with social and commercial potential. The potential of the development also looks for a sustainable and social work environment, creating new mix-used buildings that attract new users and more density to the site near the periphery of the railway station while sustaining the essence of a transport hub in an urban context.



ACCESS AND CIRCULATION

Infrastructure for constant circulation and communication on foot or by bicycle between the north and south side.

Corridors with elevated infrastructure

First: Along Prubezna street, as a main square. This connection will start from the station and will continue along the development.

Second: On Dubecska street, between north and south and above the railway tracks.

GREENERY

Green belt corridor that enhances the potential of existing parks and works as a barrier between the railway station and the highway.

Pocket Parks: Join the green unused small green areas around the railway station and make their infiltration areas.

Urban parks: Along the east-west, there's an existing big green area that will be the start and end of the development with big urban parks.

Kids' play areas – Playgrounds: The new development will include a big recreational area.

Rest park – areas for older people closer to the housing for less distance.

USE – ACTIVITIES

Mixed-use buildings like a library, café, retail, and housing for travelers, and commuters towards the Eastern side of the station.

Open-air cinema, sculpture/art parks in the proposed square near Na Padesatem tram stop.

Creating livable neighborhoods within garden cities by adding green spaces for all demography of users near the periphery of the railway station.

To break the barrier between housing and transport hub by building foot over the bridge for pedestrians and cyclists to reach from the square at Na Padesatam stop to Dolinecka street for commercial space and intensive green areas as a barrier.

NEW LAND USES

Retail, hospitality, medical facilities, and commercial buildings in a 500m radius of the transport hub to attract jobs for the residents and workers.

New commercial center near the brown-field (North side of the railway station) for more jobs.

Recreational, green area near Praha-Strasnice Zast tram stop which surrounds the cycling track connecting to the city center.

Reusing empty spaces under the highway and railway station as potential robust public spaces by introducing art and local fairs, farmers markets, food trucks, exhibitions, etc.

ENHANCE EXISTING AREAS

Redevelop unused/intensive areas with extensive usage of green space near garden cities in both North & South districts.

Include more sports and recreational areas near existing schools.

Create small urban clusters hosting public functions connecting transport hub and North & South districts.

CONCEPT

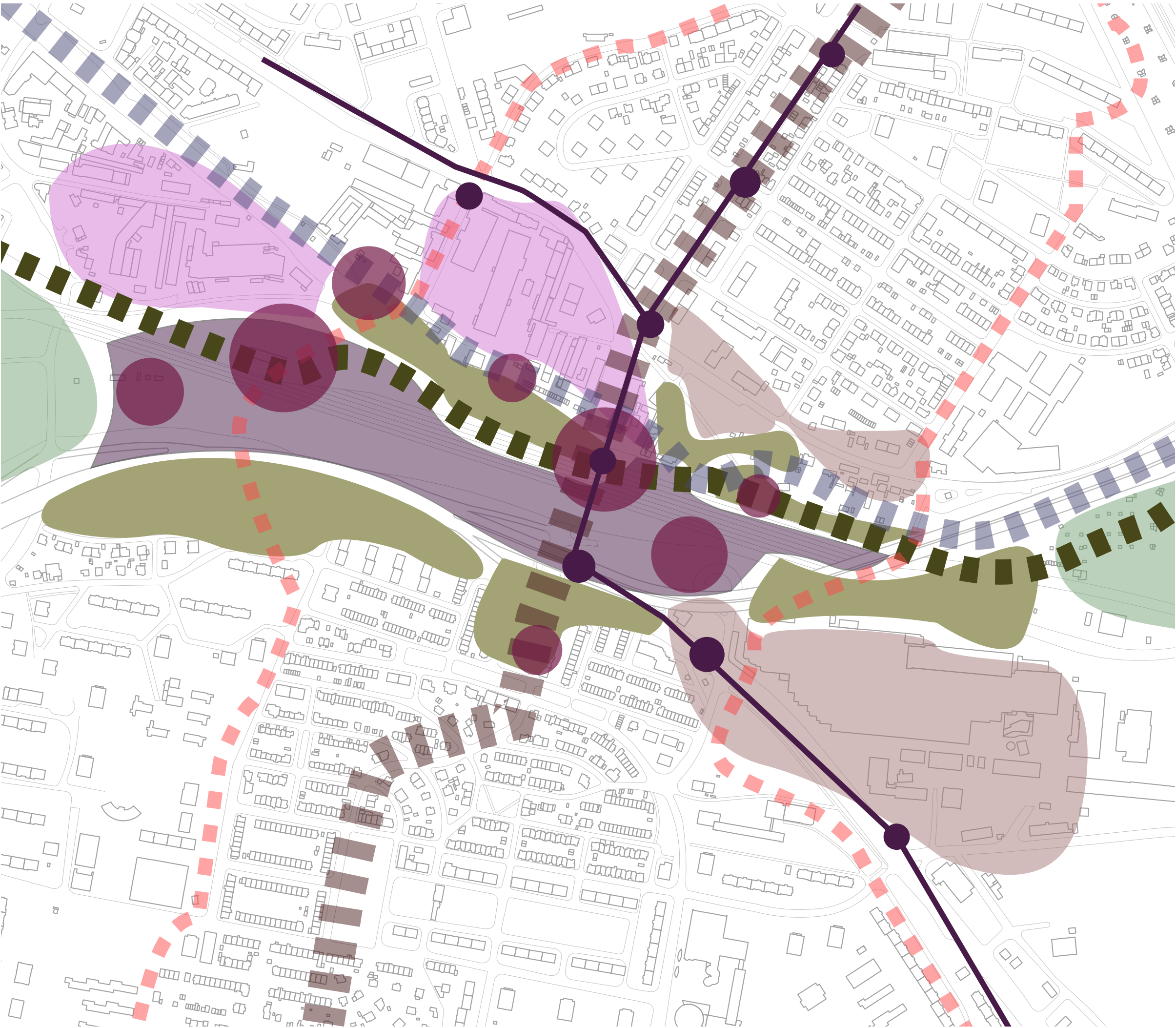

- public spaces
- transport stop
- transport line
- bike line
- green corridor
- intensive public connection
- new public connection
- modification of industry
- new development
- recreational
- public green
- natural green space

DESIGN PROPOSAL

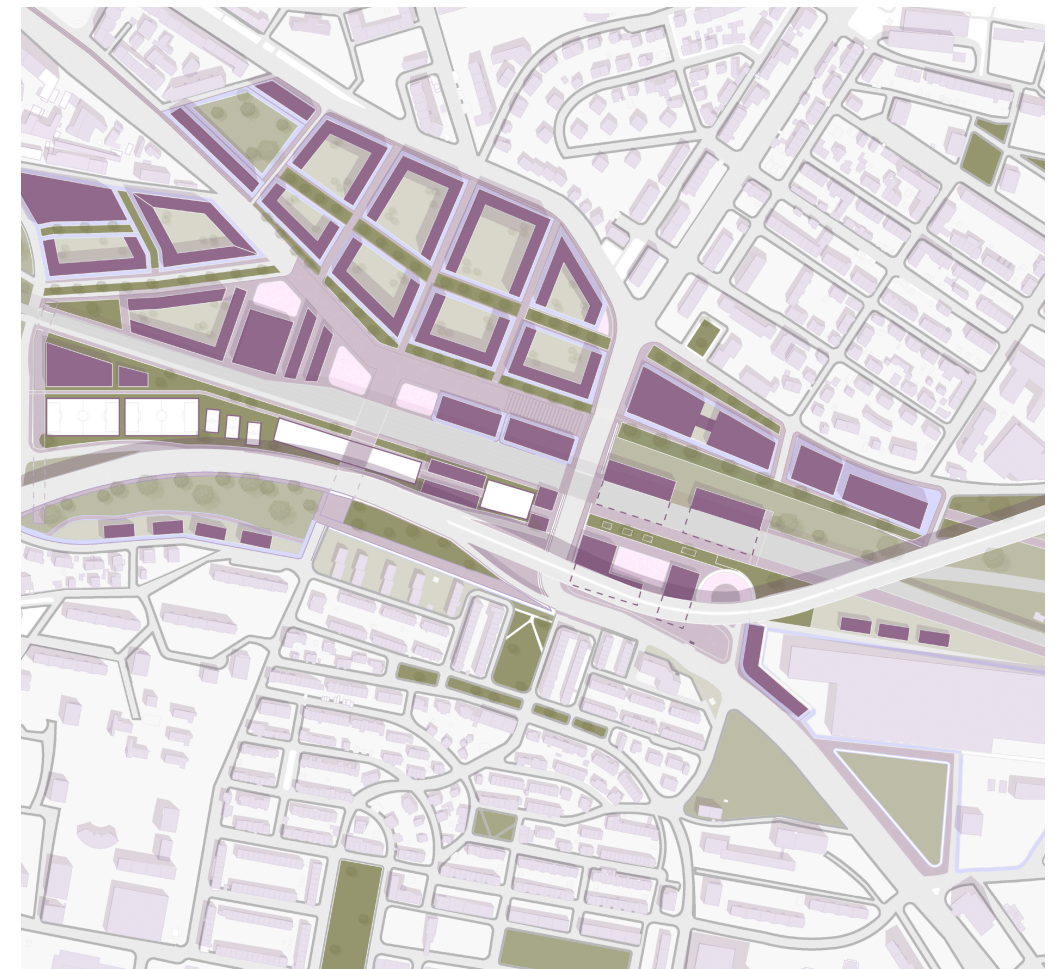

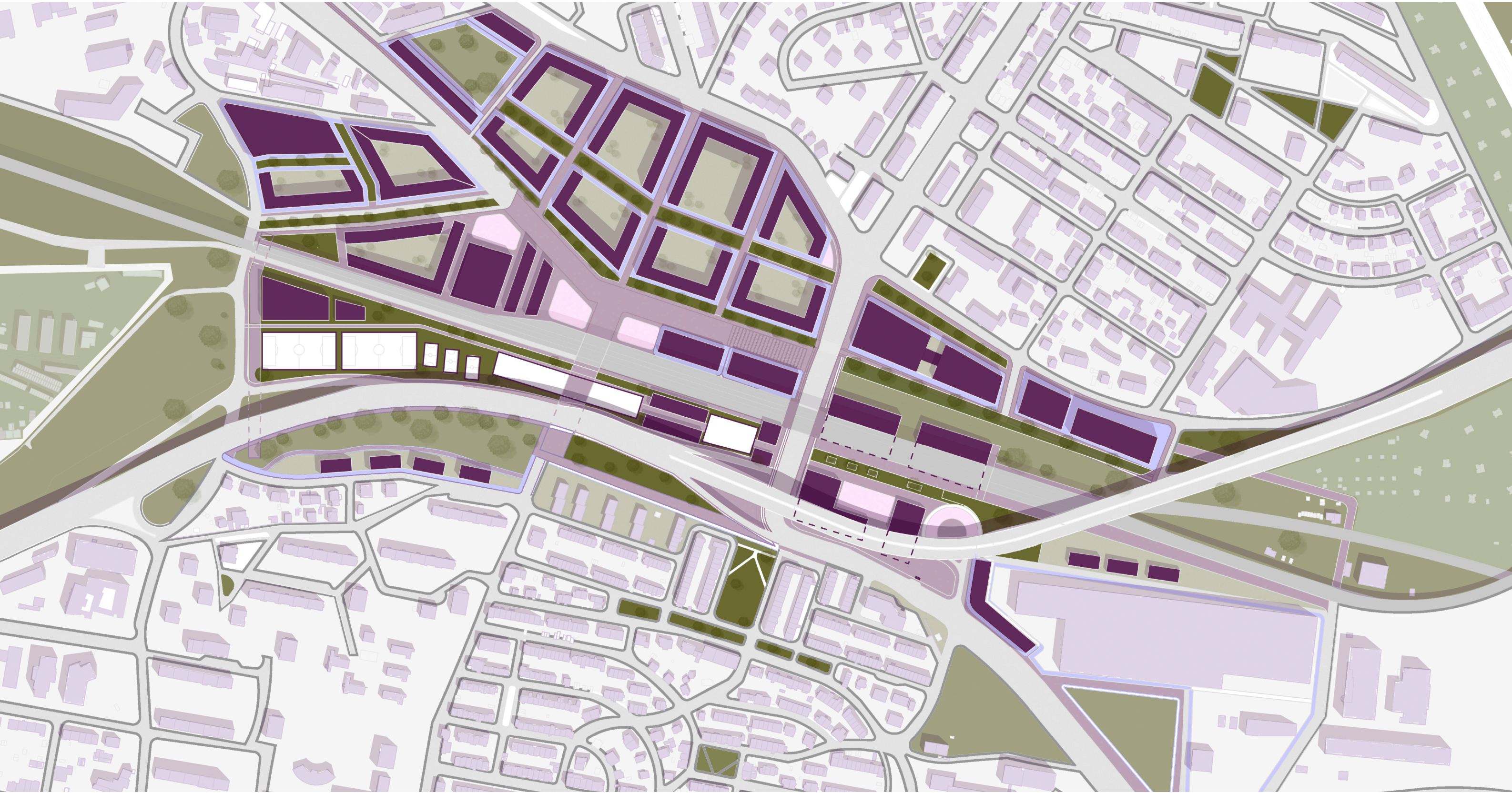

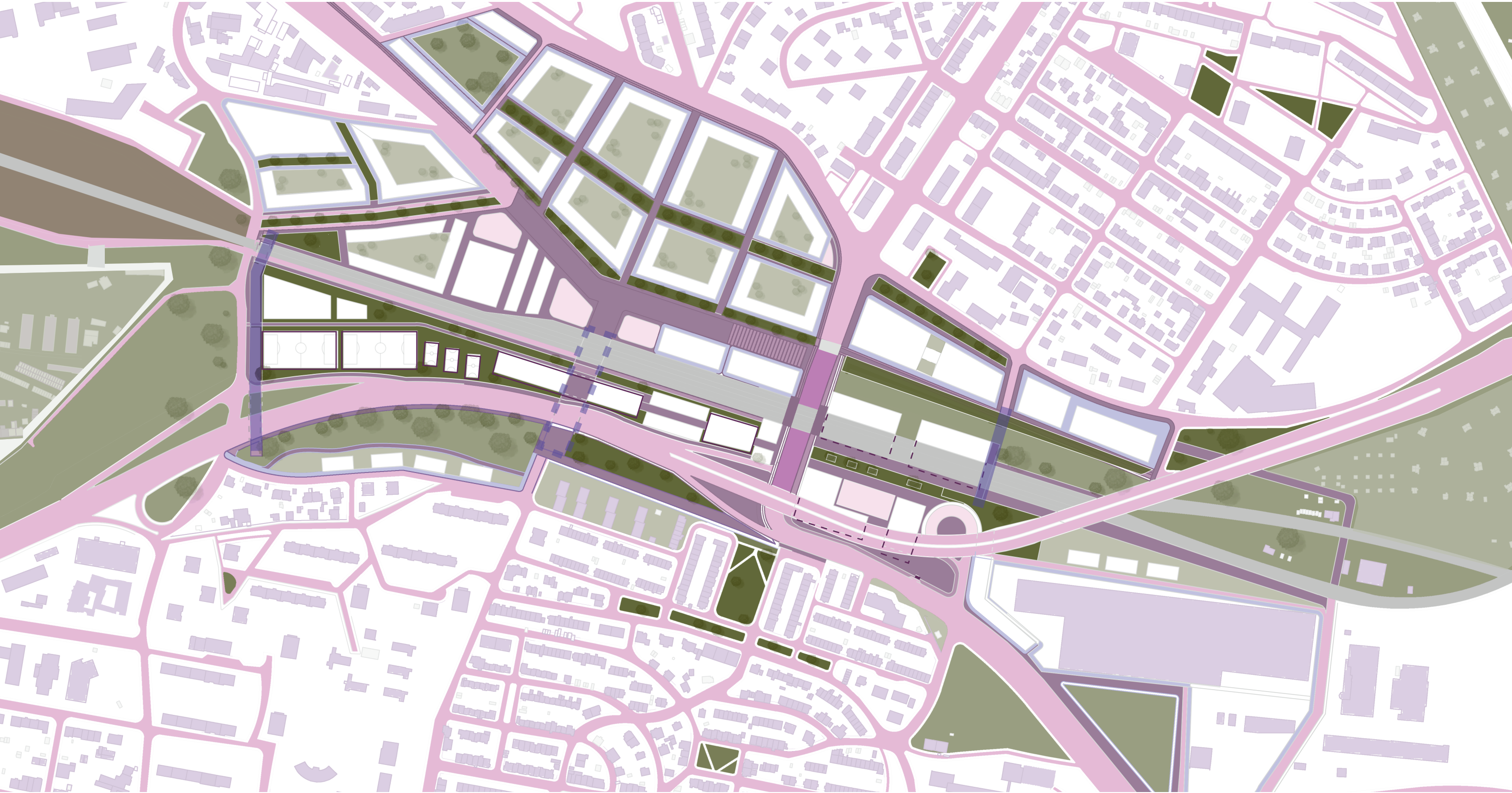

- public squares
- new connection
- intensive public road
- pedestrian public space
- public road

PUBLIC SPACE

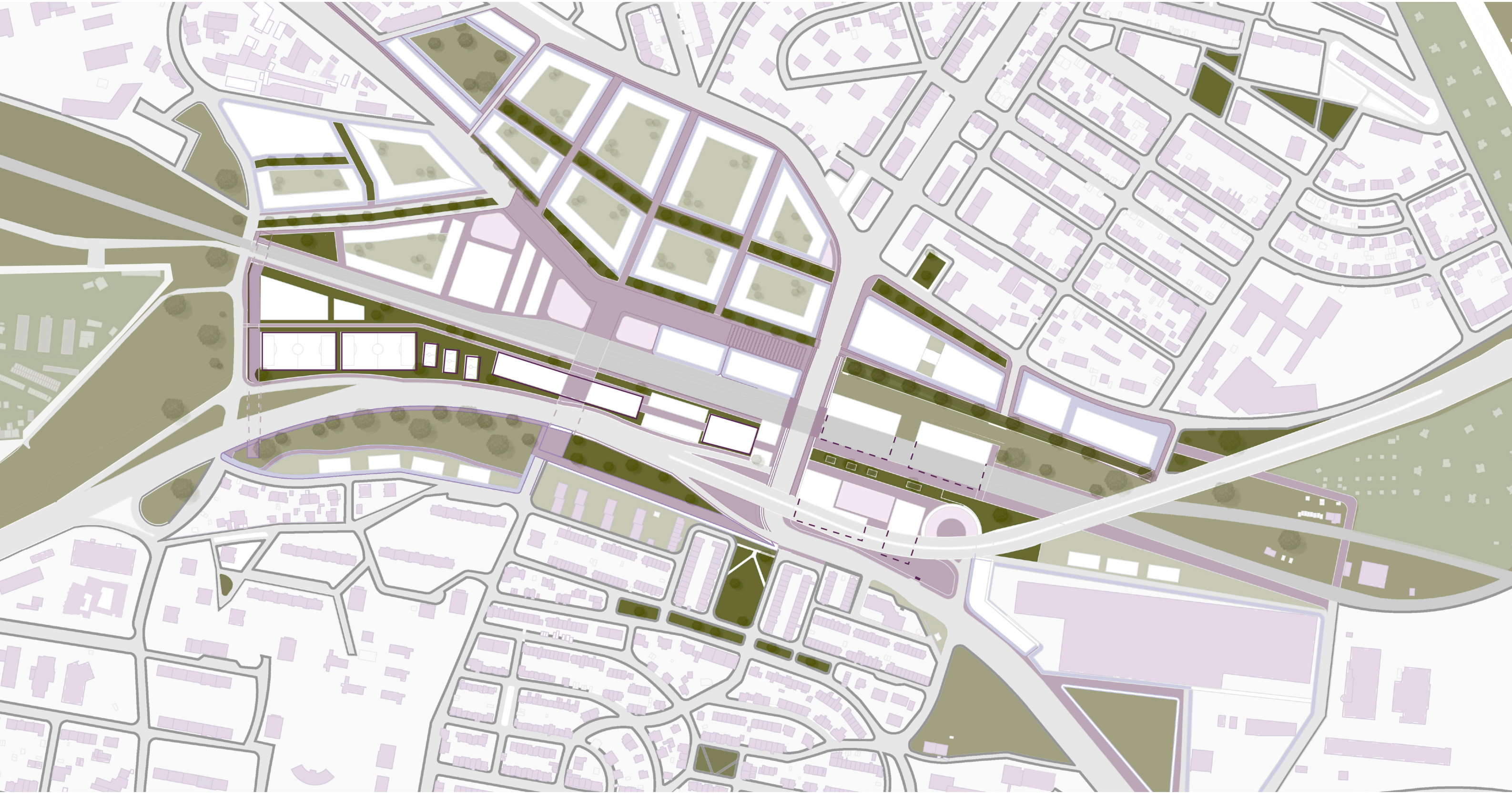

public park green
community green
natural green space

GREEN SPACE

scale: 3500
50m

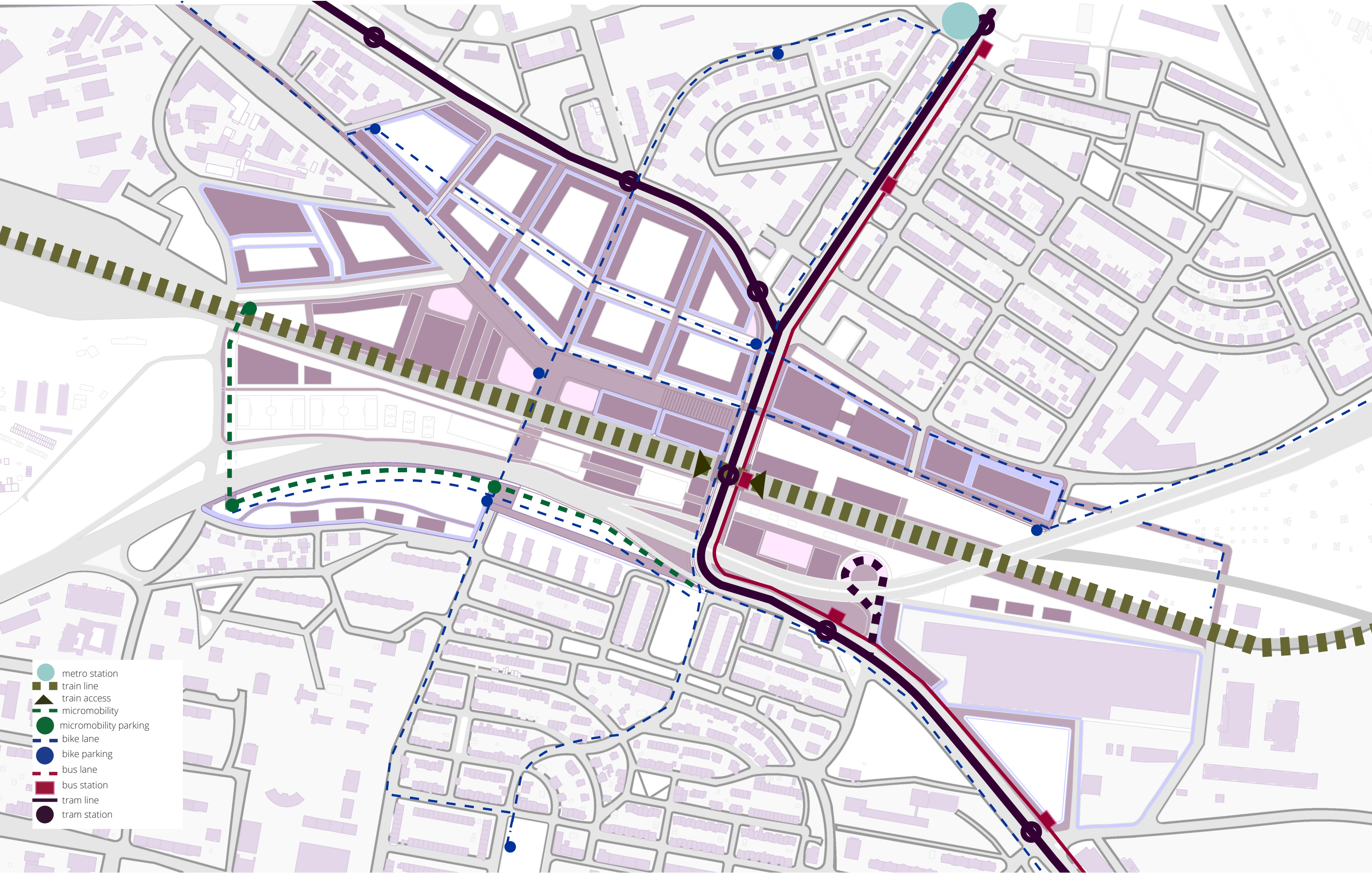

TRANSPORTATION

scale: 3500
500m

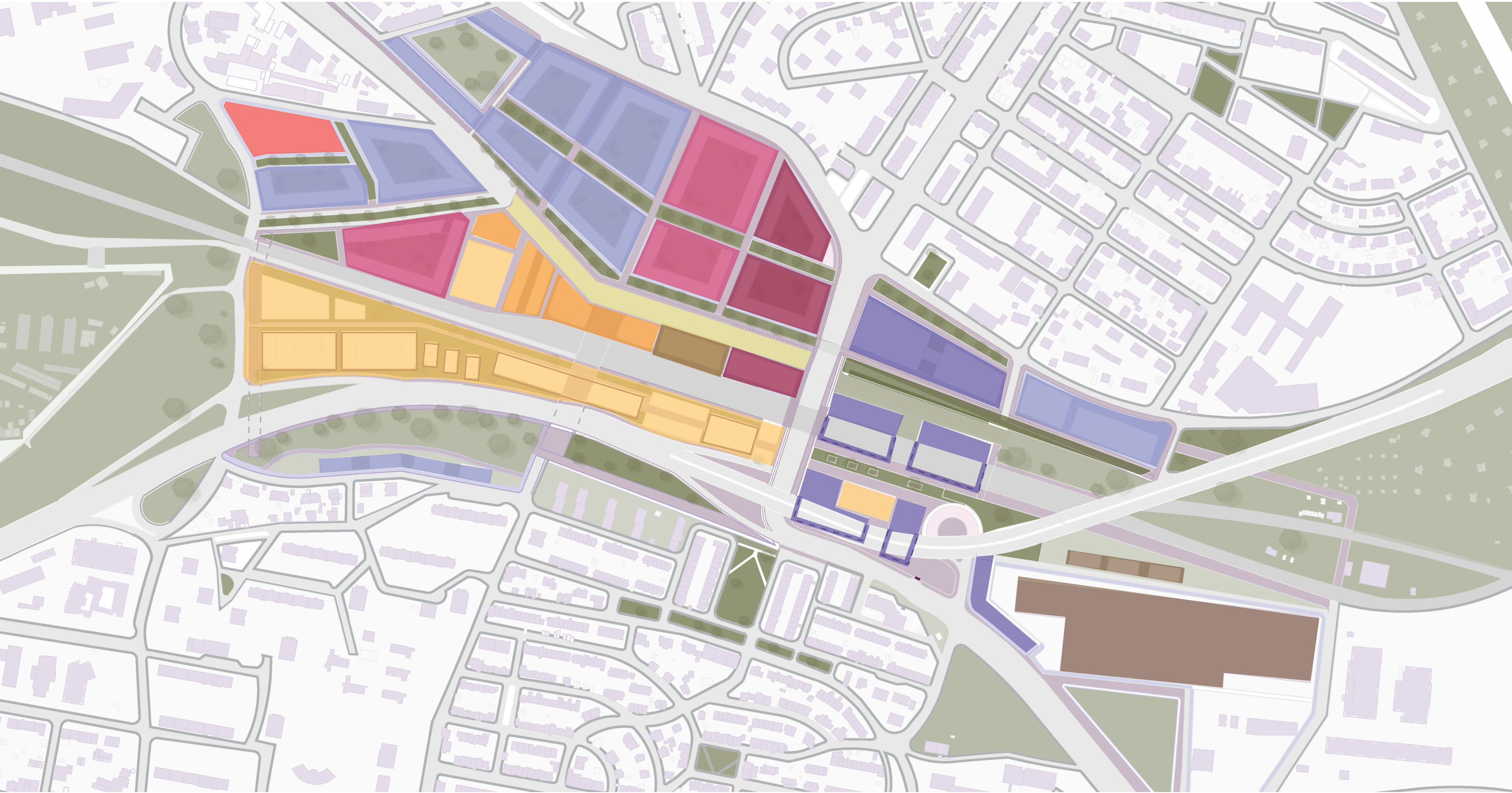

- hotel
- industry
- recreational - sport
- recreational - public mix use
- recreational- cultural space
- housing
- mixed use
- administrative
- commercial

LAND USE

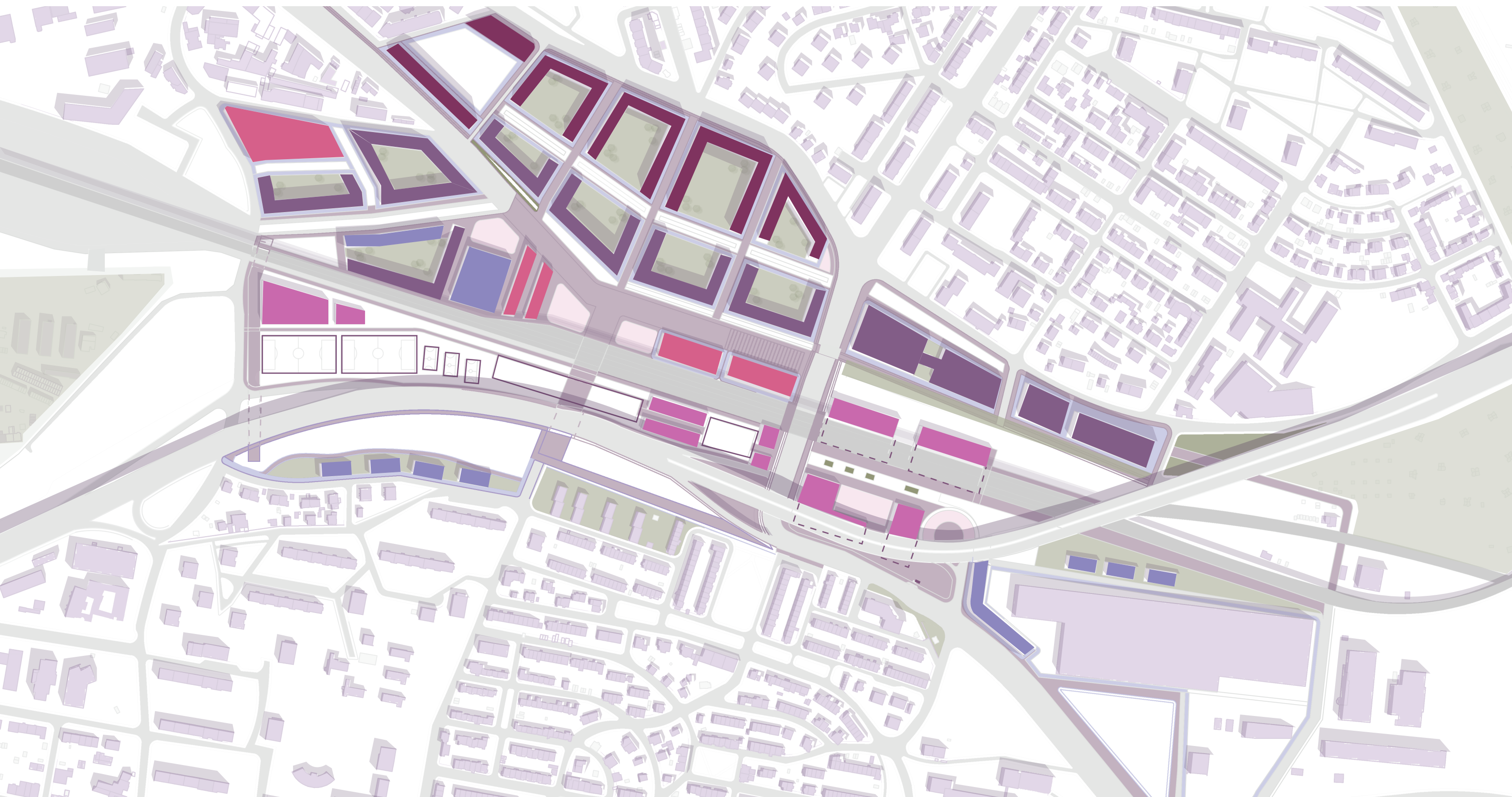

- 2 levels - 7 m
- 3 levels - 10.5 m
- 4 levels - 14 m
- 5 levels - 17.5 m
- 6 levels - 21m

BUILDING HEIGHT

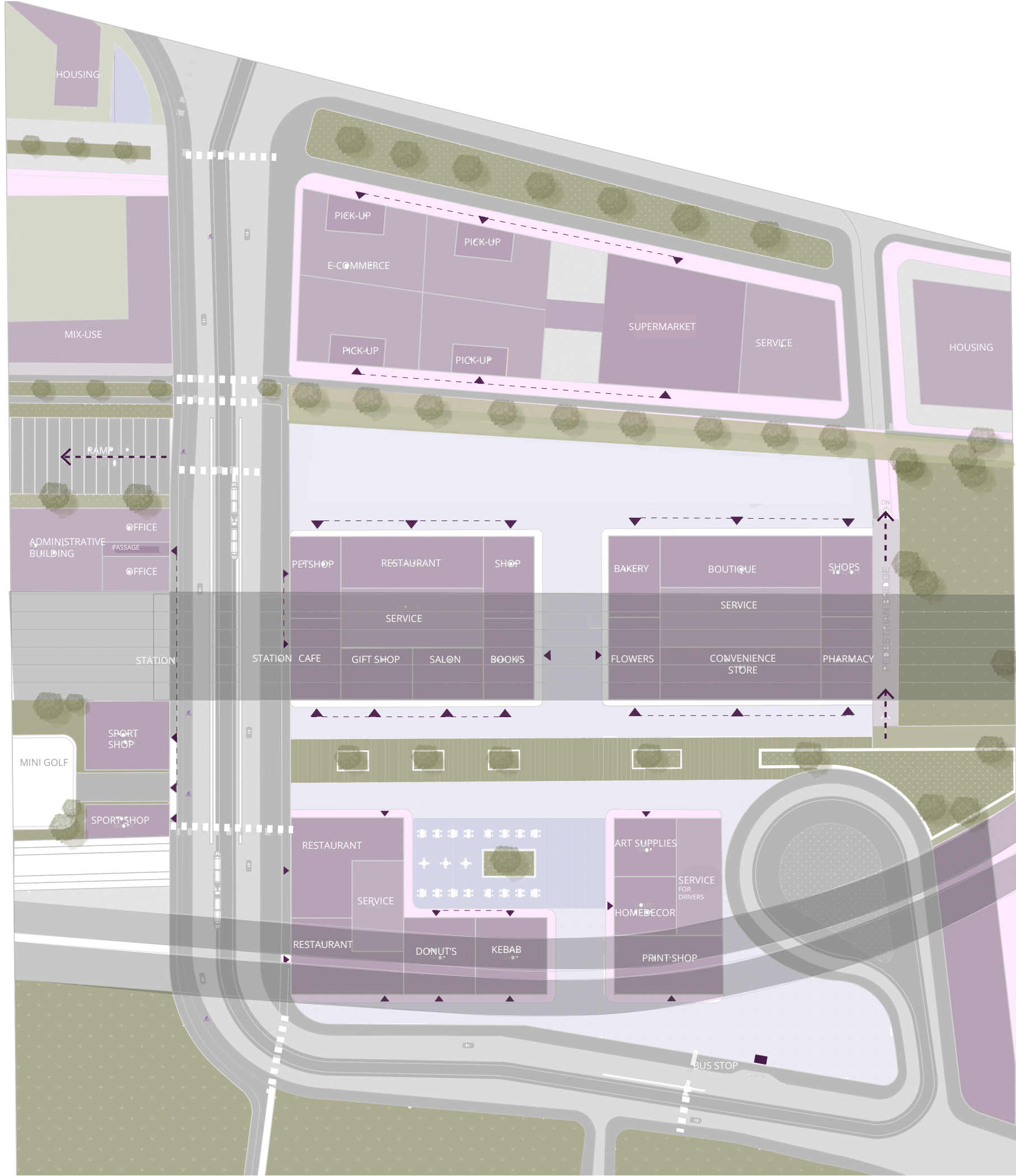

- bike path
- access - building
- building squares
- highway
- road - car
- road - tram
- public pedestrian path
- public squares
- community green
- public green space
- private
- public accessible

MASTER DETAIL

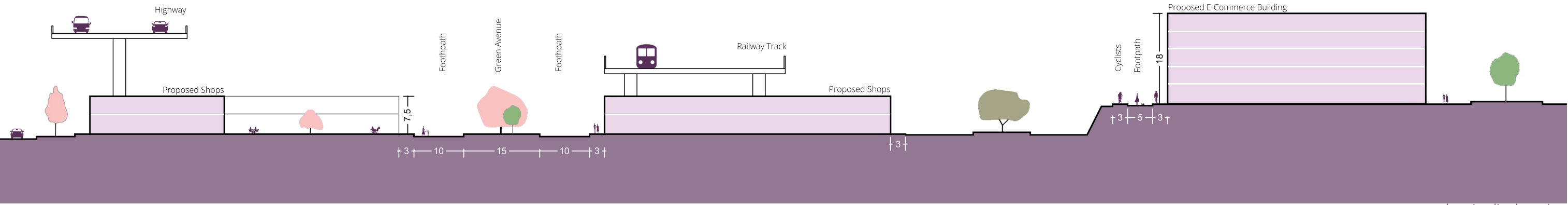

longitudinal section

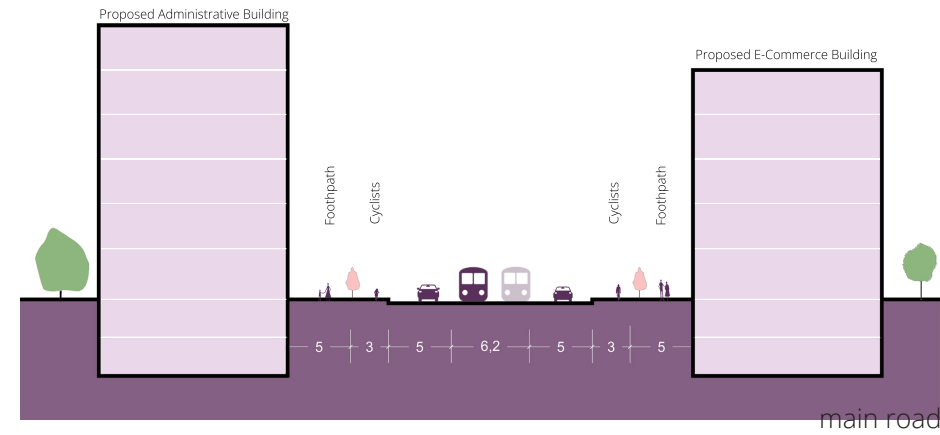

main road

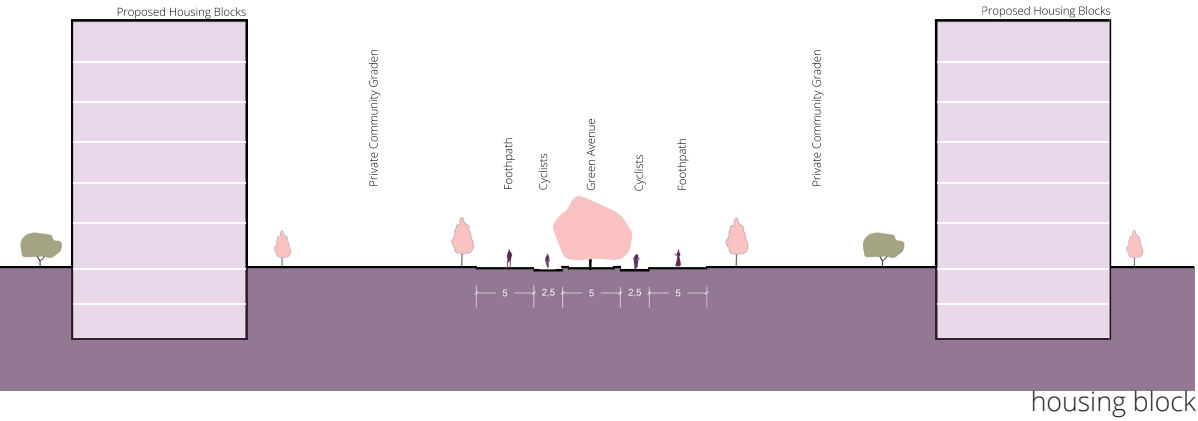

housing block

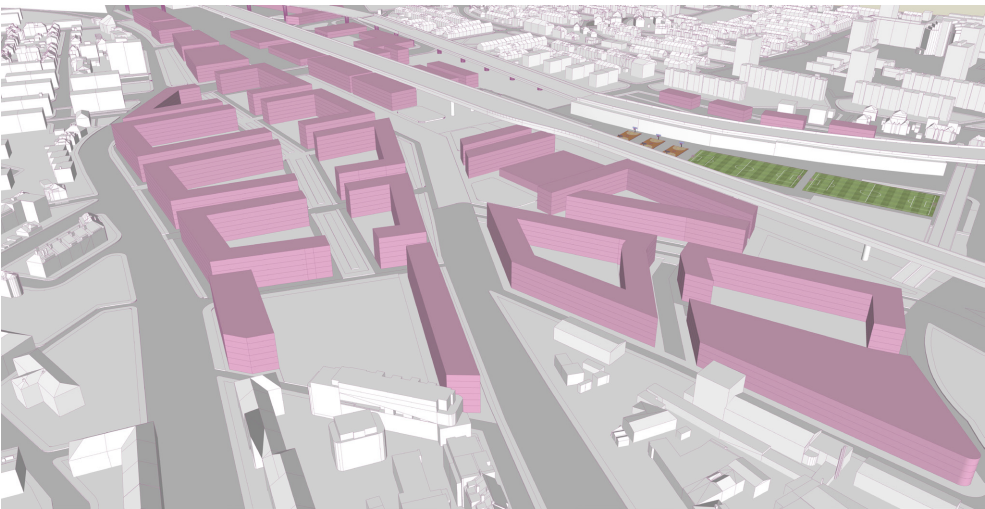
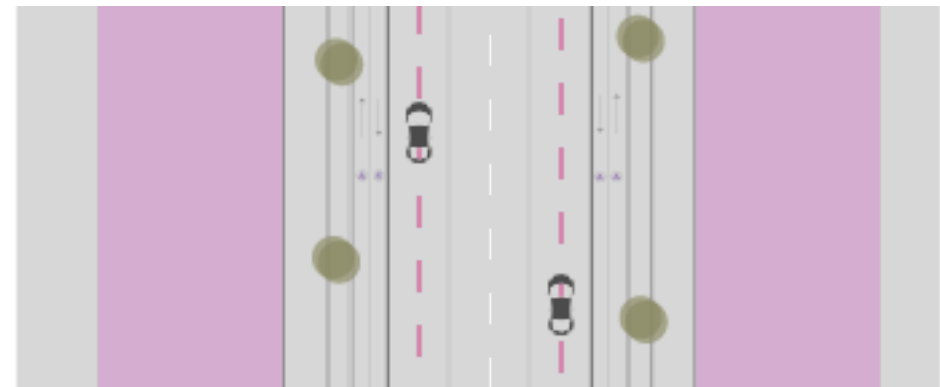

housing block

SECTIONS



commercial area

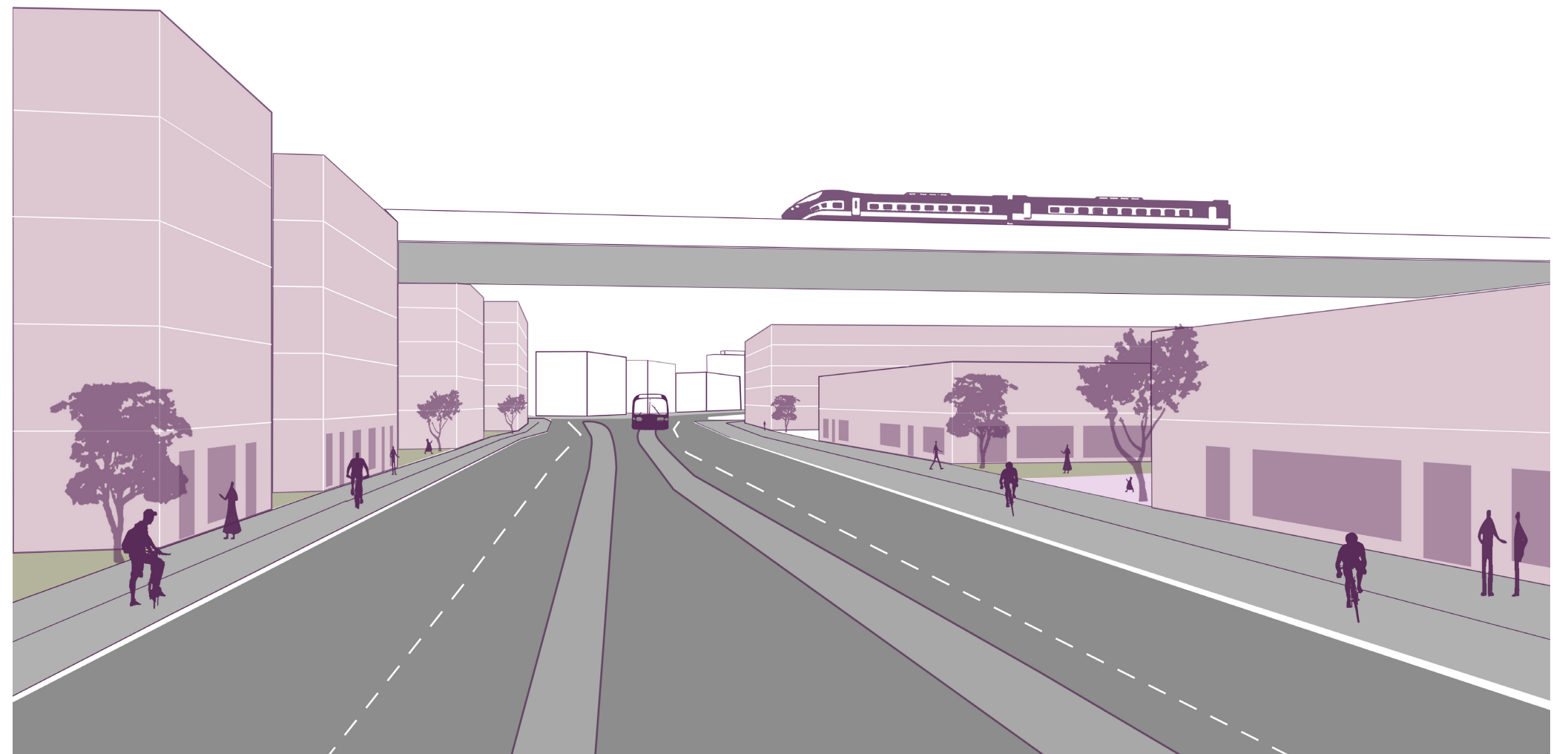

main road

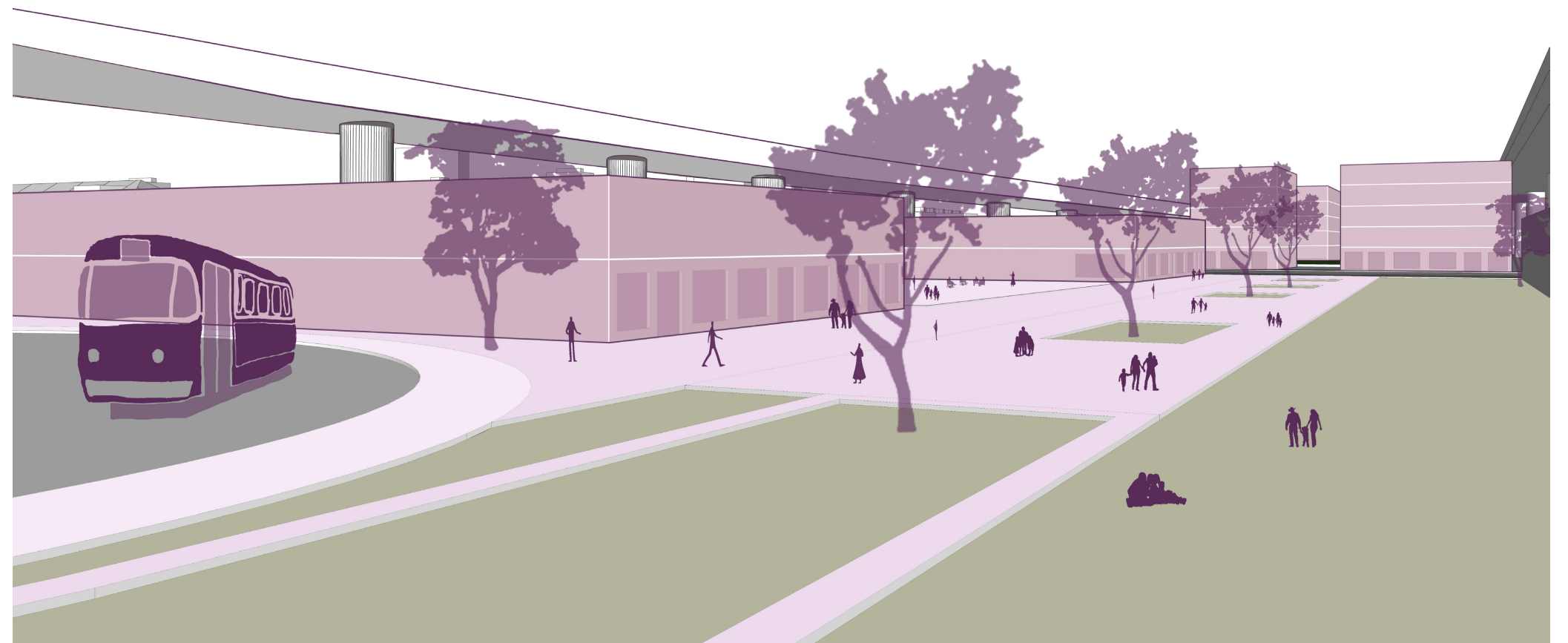

commercial zone

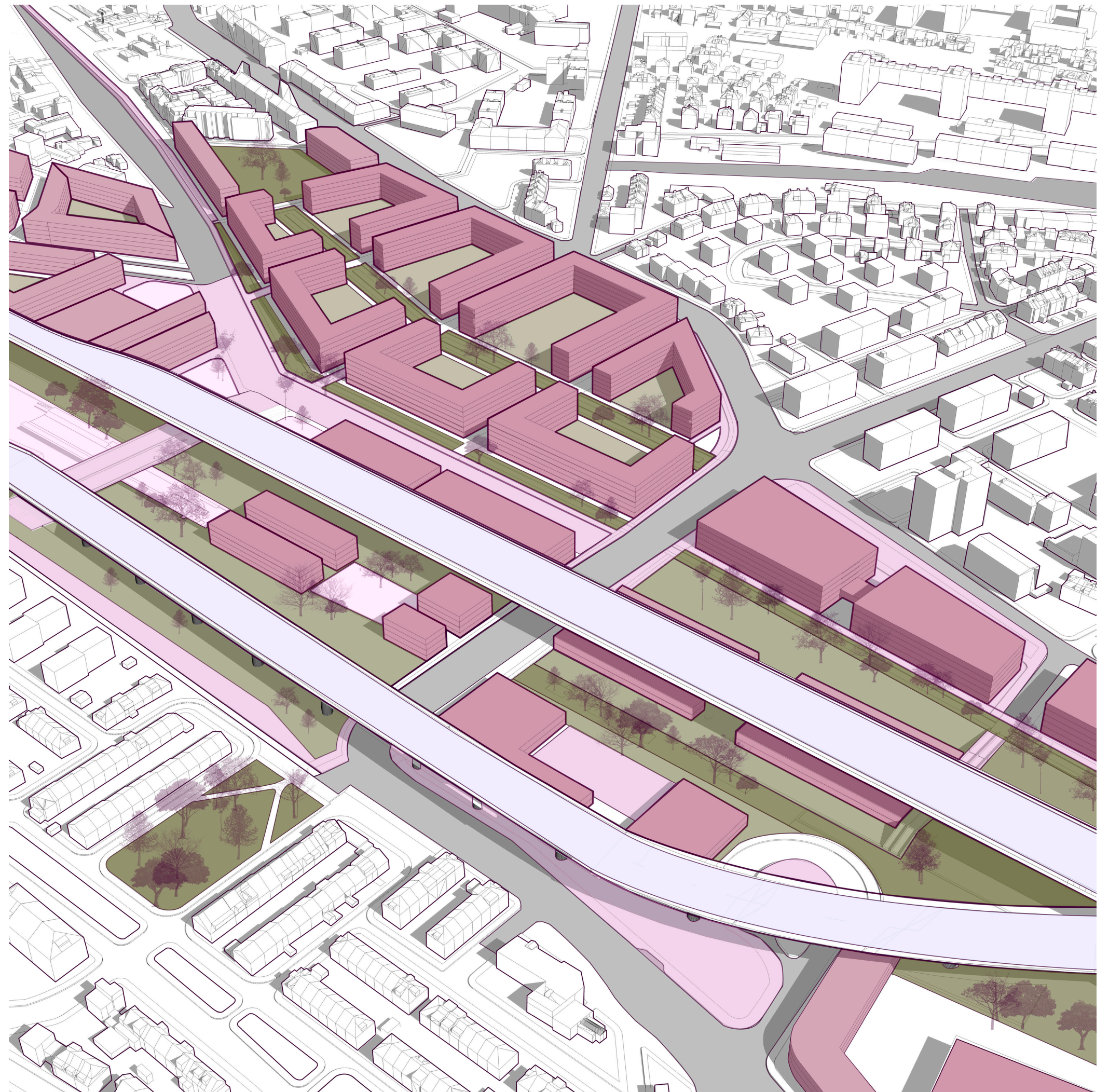

BIRD'S-EYE VIEW

