An architectural rendering of a public square. In the background, a modern building with a glass facade and a central tower is visible. The square is filled with mature trees and colorful flower beds. Several white silhouettes of people are scattered throughout the scene, some sitting on benches and others walking. In the foreground, two people are sitting at a small round table, their backs to the viewer. The overall atmosphere is bright and airy, with a soft, hazy light.

# T.G.M. SQUARE

---

Tábor **vol. 2**

ŠIMON PEŠEK  
ATELIER REHWALDT  
AT3 LS 2023\_2024



Masaryk Square was created in the 1900s as part of the botanical garden in front of the new School of Agriculture. It gained its current form in 2012.

Through the reuse of materials and trees present on site, I aim to create a new, active, and multifunctional space full of greenery.

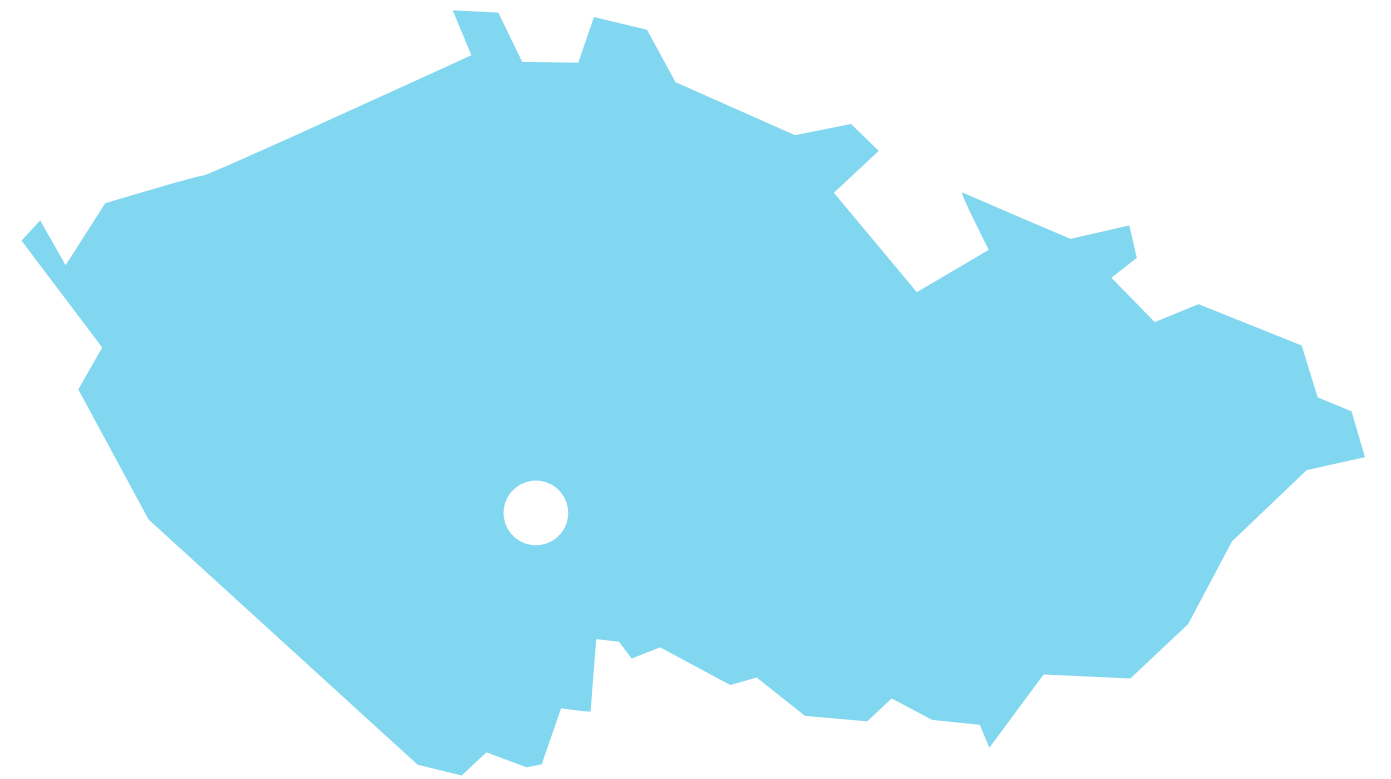

Sources:

Historical photography:  
Šechtí a Voseček, <https://sechtl-vosecek.ucw.cz/index.html>, 05. 2024

Aerial photography:  
ČÚZK, <https://ags.cuzk.cz/archiv/>, 05. 2024



# Historical development



Agriculture school



Botanical garden

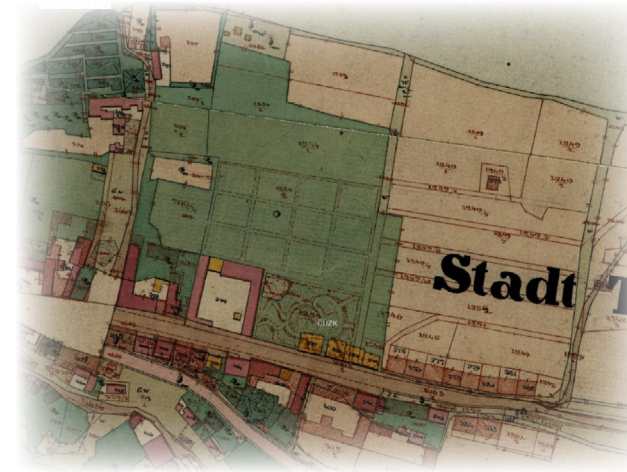

1830



1949



1972



1992



2011



2020

From garden to square



## Wider relations

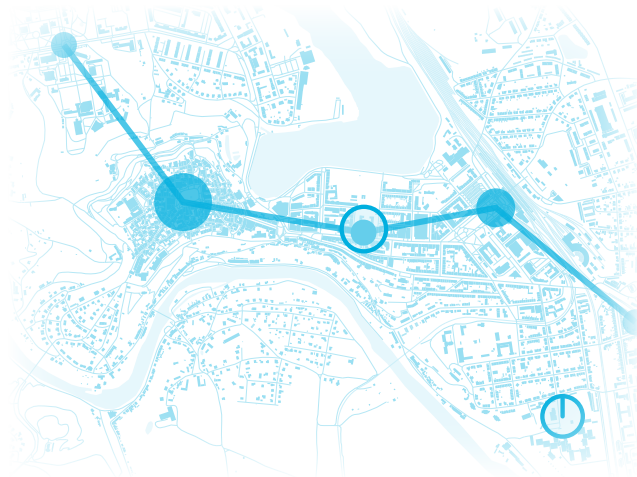

In the middle of the town

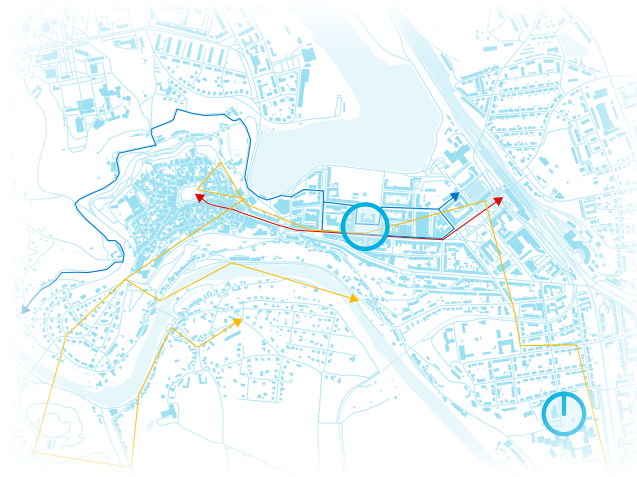

Traffic connections



Insufficient parks

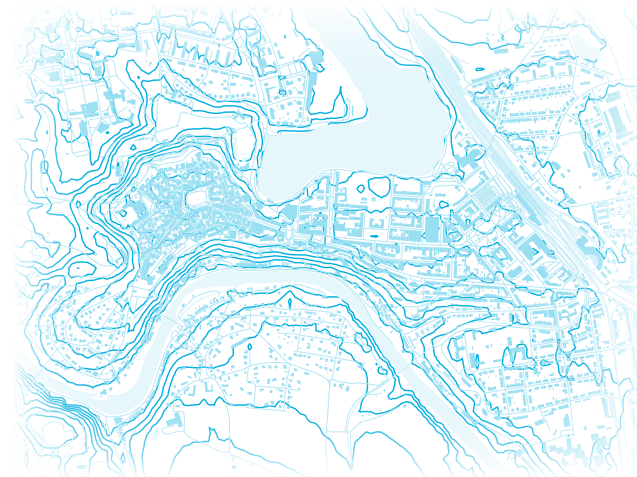

On the hill

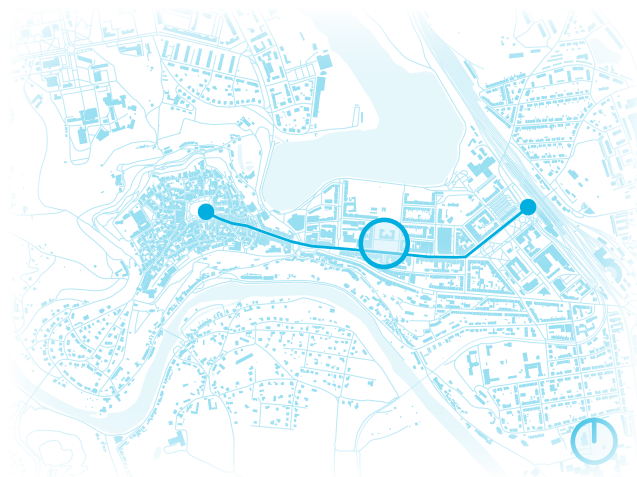

Connecting and commercial street



Car traffic

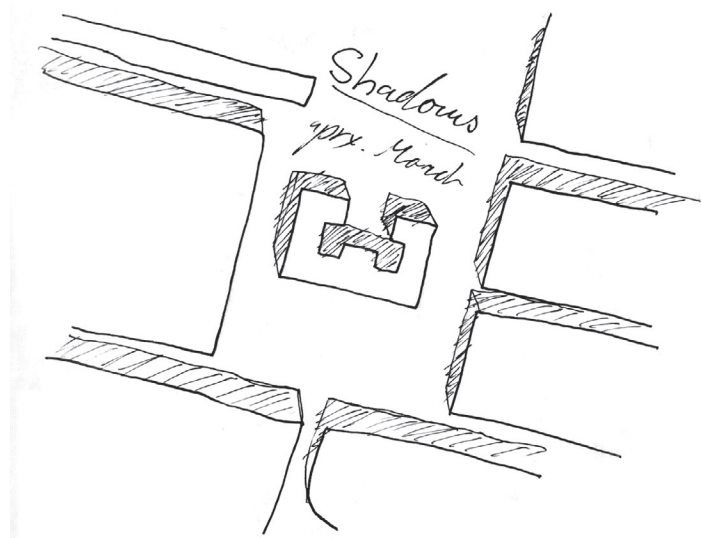
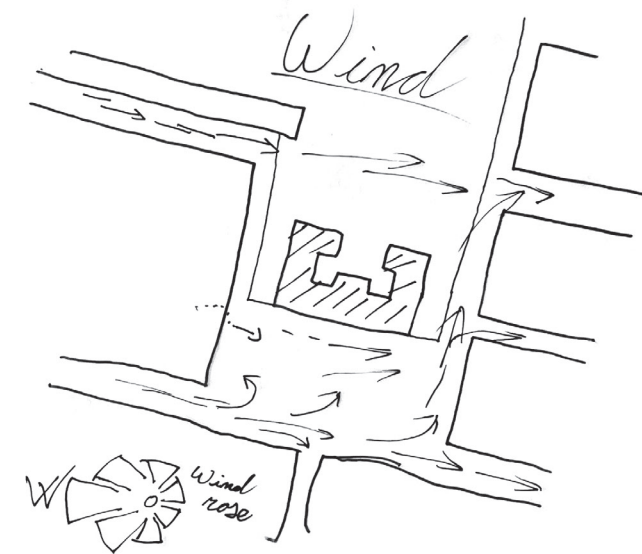
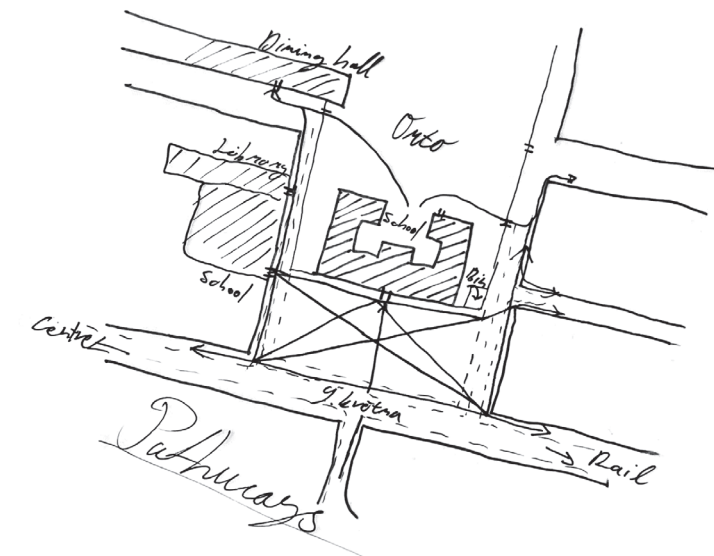

## Center of the modern town



## Views



How does it look when you arrive?

## Materials on site



Furnishing



Fountains



Stone paving



Concrete paving



Trees



Botanical garden

Reuse, relove



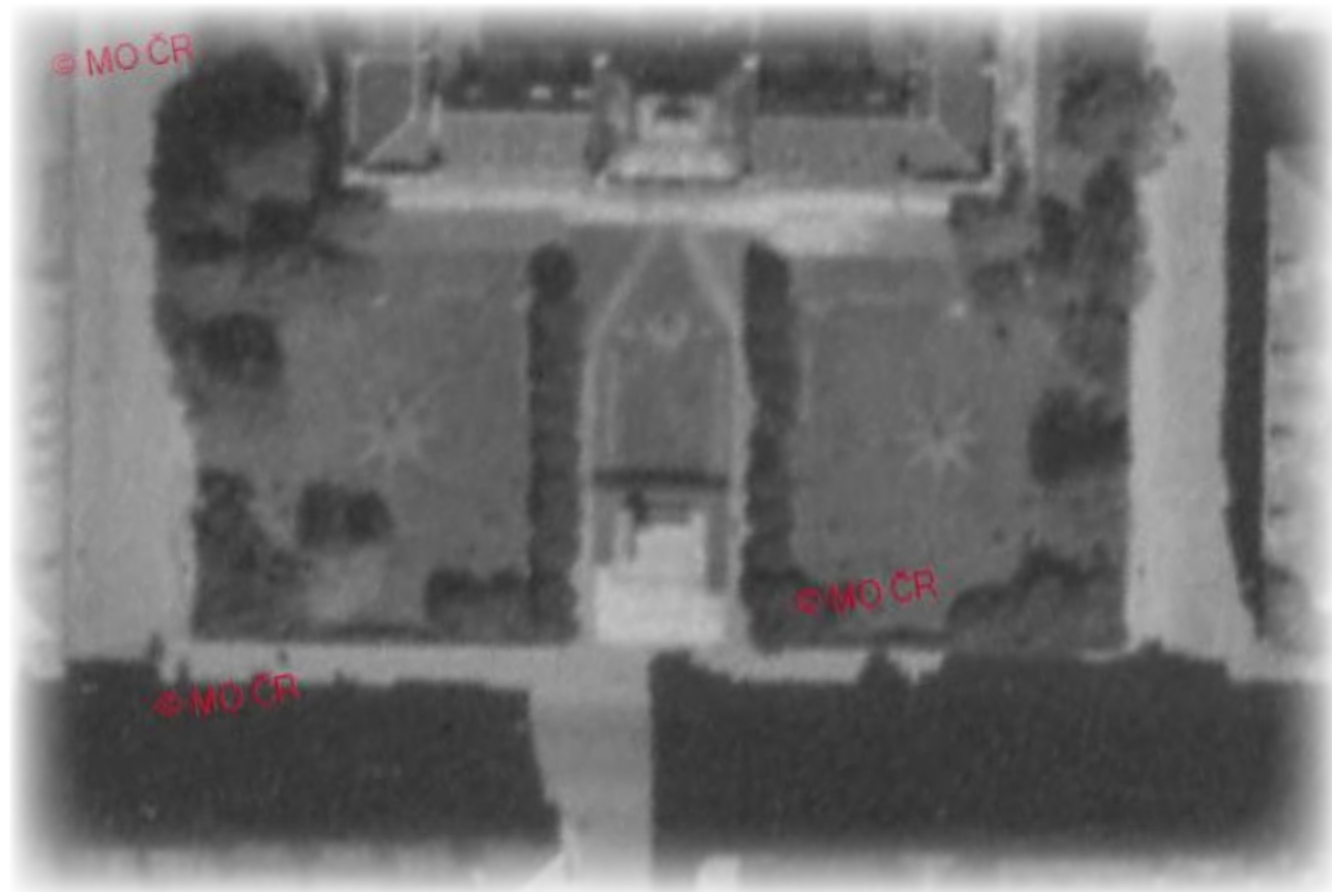

1900s - 1950s



2012 - ?



1950s - 2012

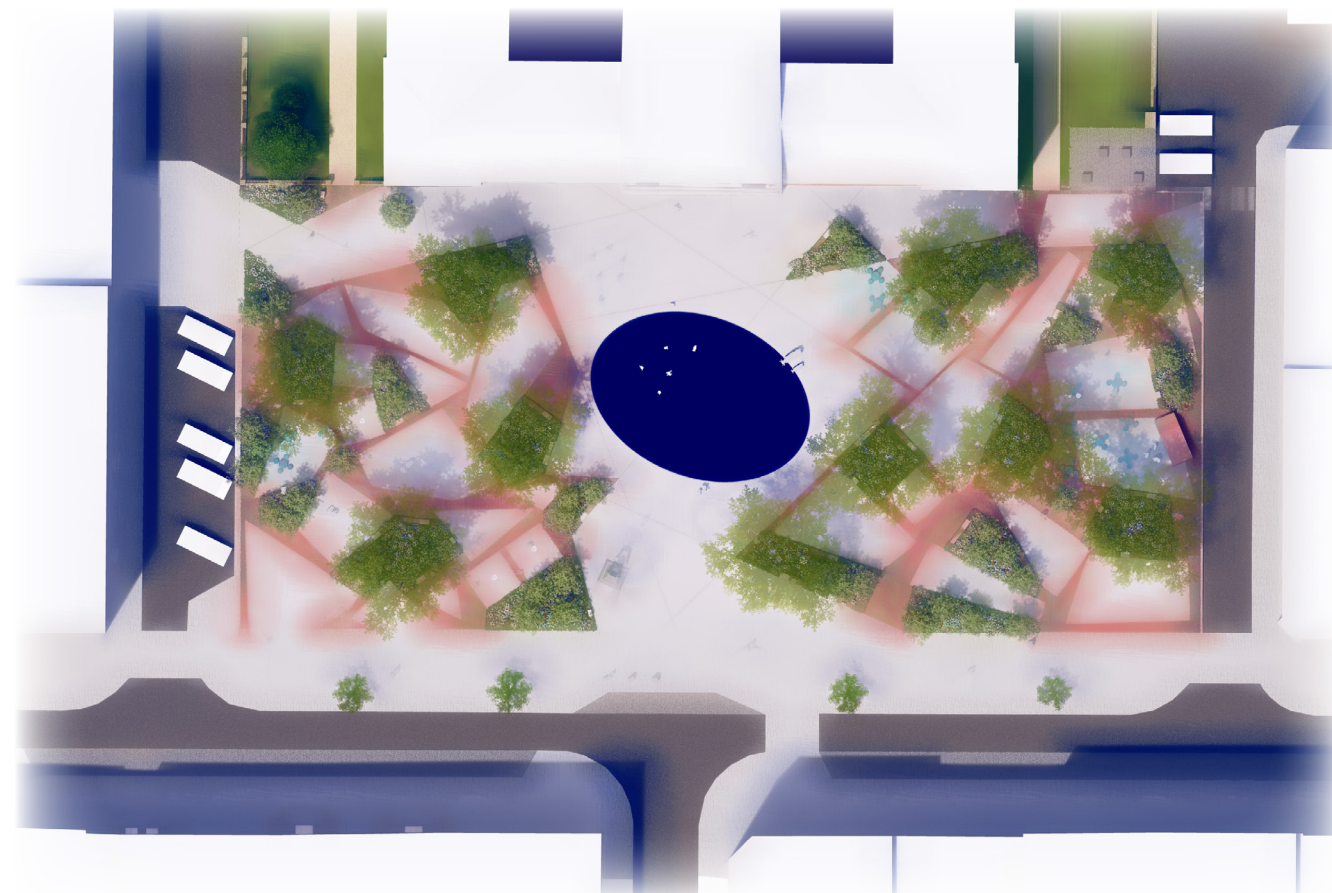

vol. 2



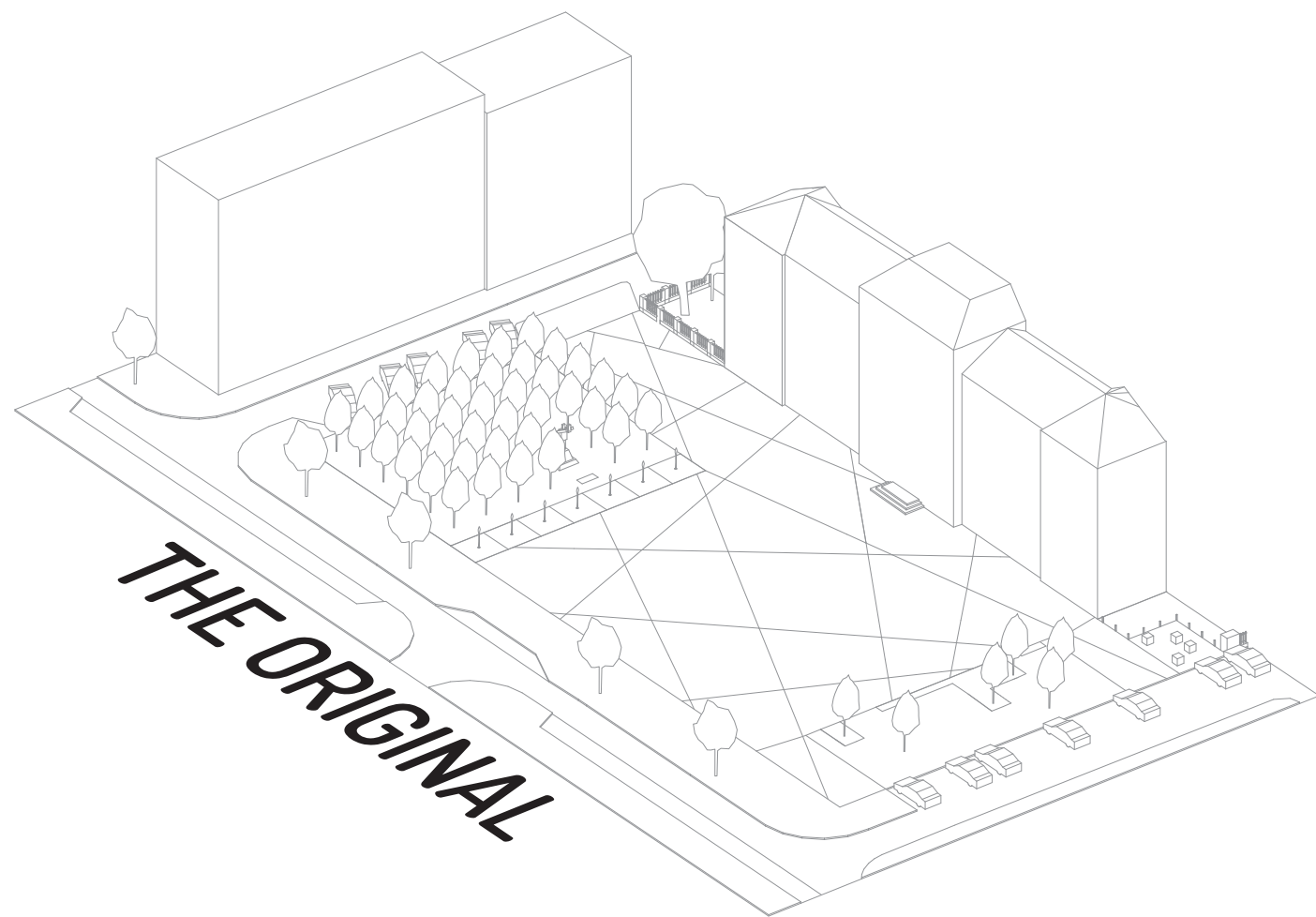

The square got its current form as a result of public competition in 2012.

Concrete paving and a square of amelanchiers.

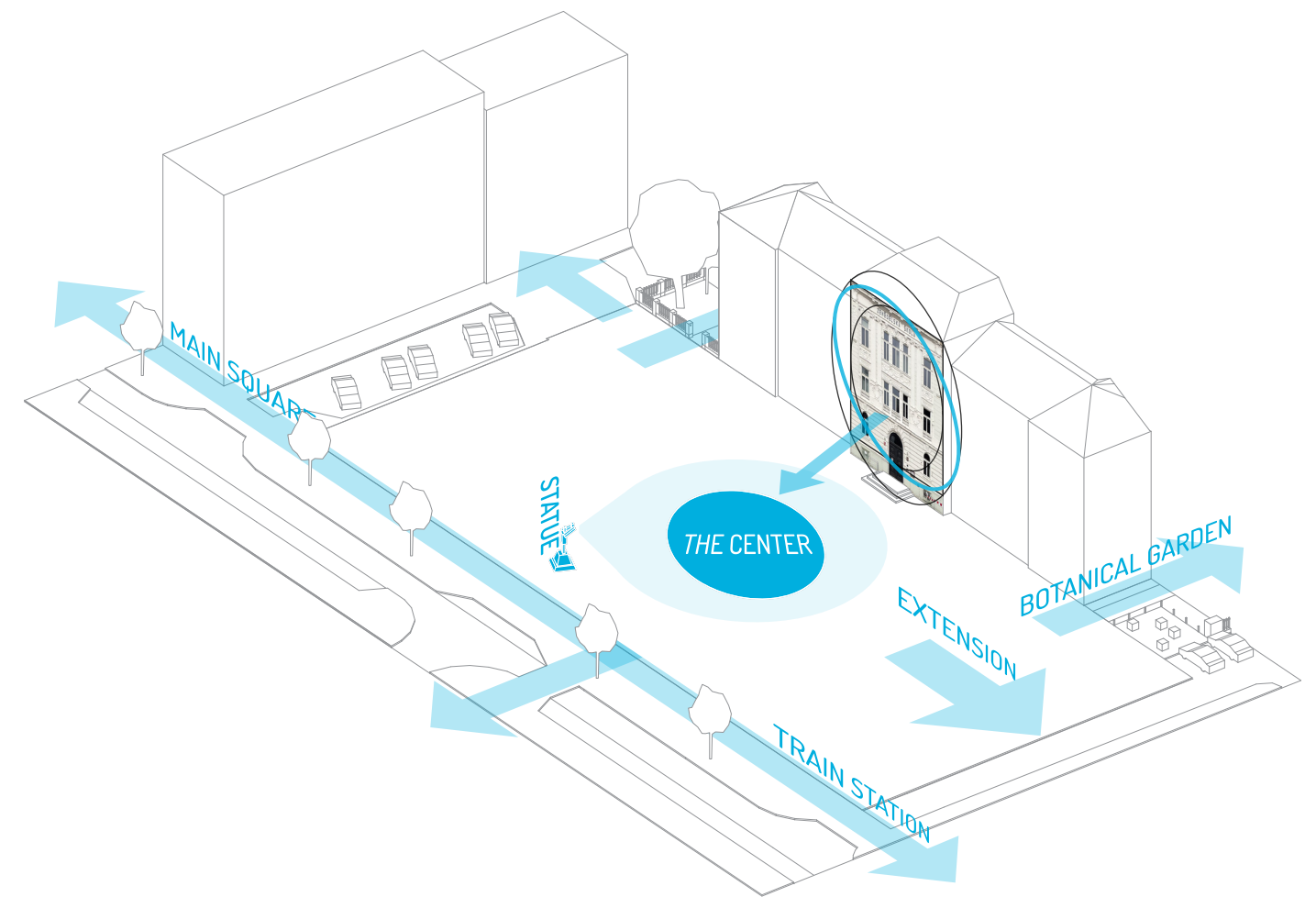

The **statue** is moved to the edge of the square so that it can create a central place by its direction.

From the neorenaissance geometry of the school I extracted an elliptic shape and created a **shallow pool** in the center. It can be drained to allow larger gatherings.

Direct **connection** to the botanical garden is vital and raised pedestrian crossings will support the main pedestrian axis from train station to the main square.



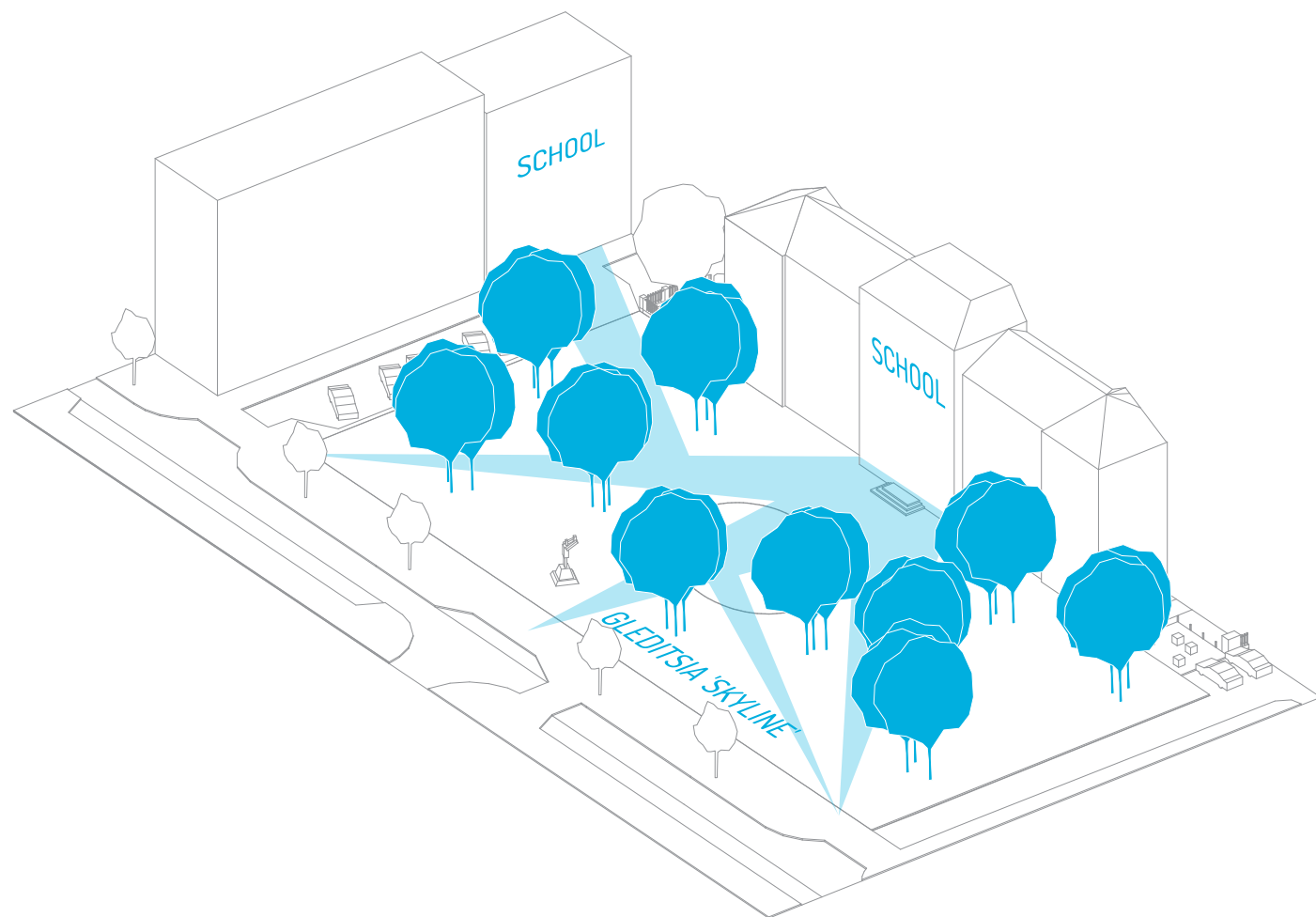

Large facade of the school of architecture was originally the reason for the square's existence. Another important institution is the academy of commerce.

They should be **visible** when you enter the space.

**Gleditsia triacanthos** 'Skyline' are planted in groups of three so that they do not obstruct the viewing angles and offer a lot of shade.

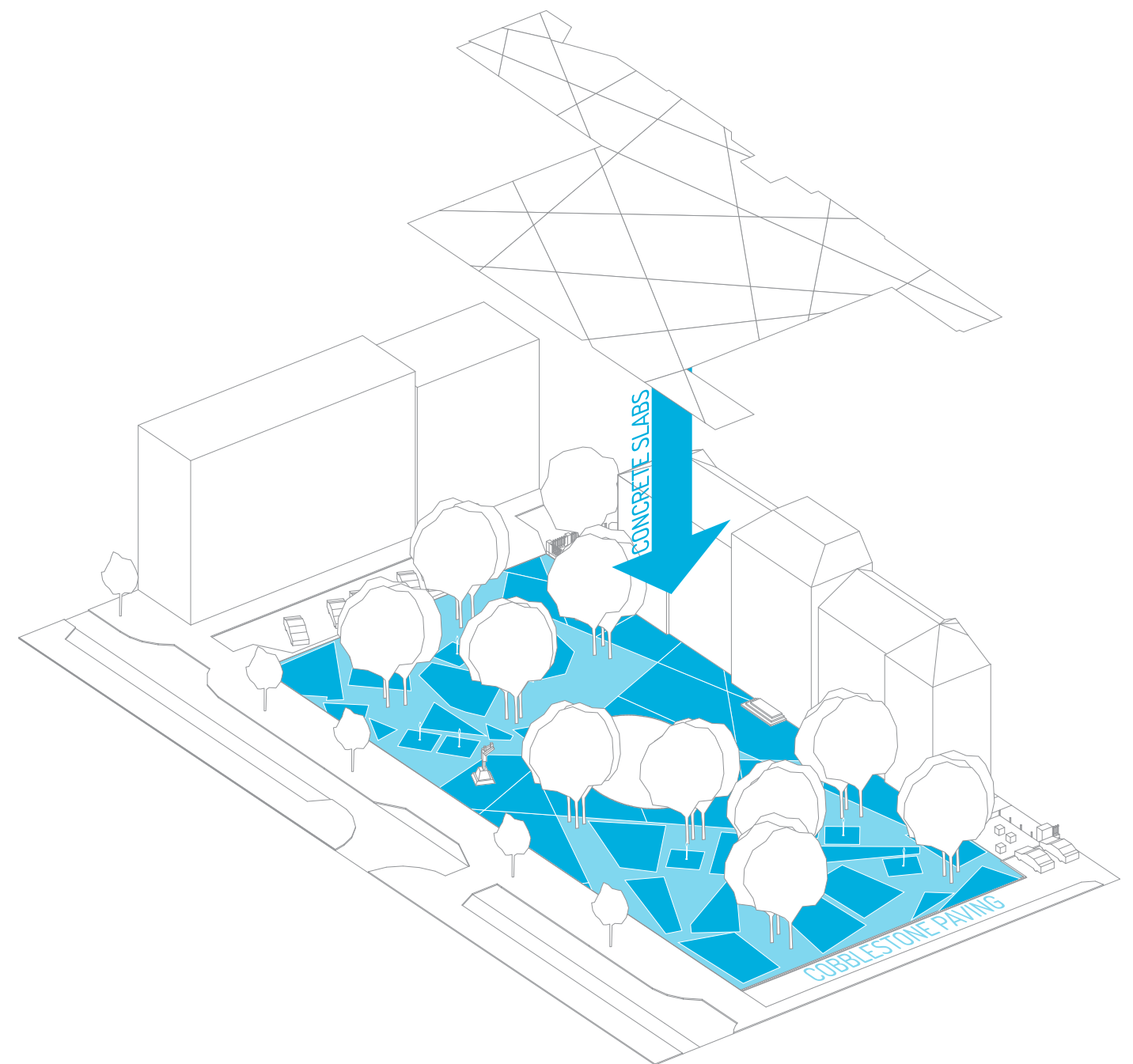

The **concrete slabs** from the current square are spread out and rearranged.

But the central area keeps its hard paving as a gathering space and a reminiscence of historical forms.

The residual gaps are filled with **cobblestones** present at site and walkable moss.



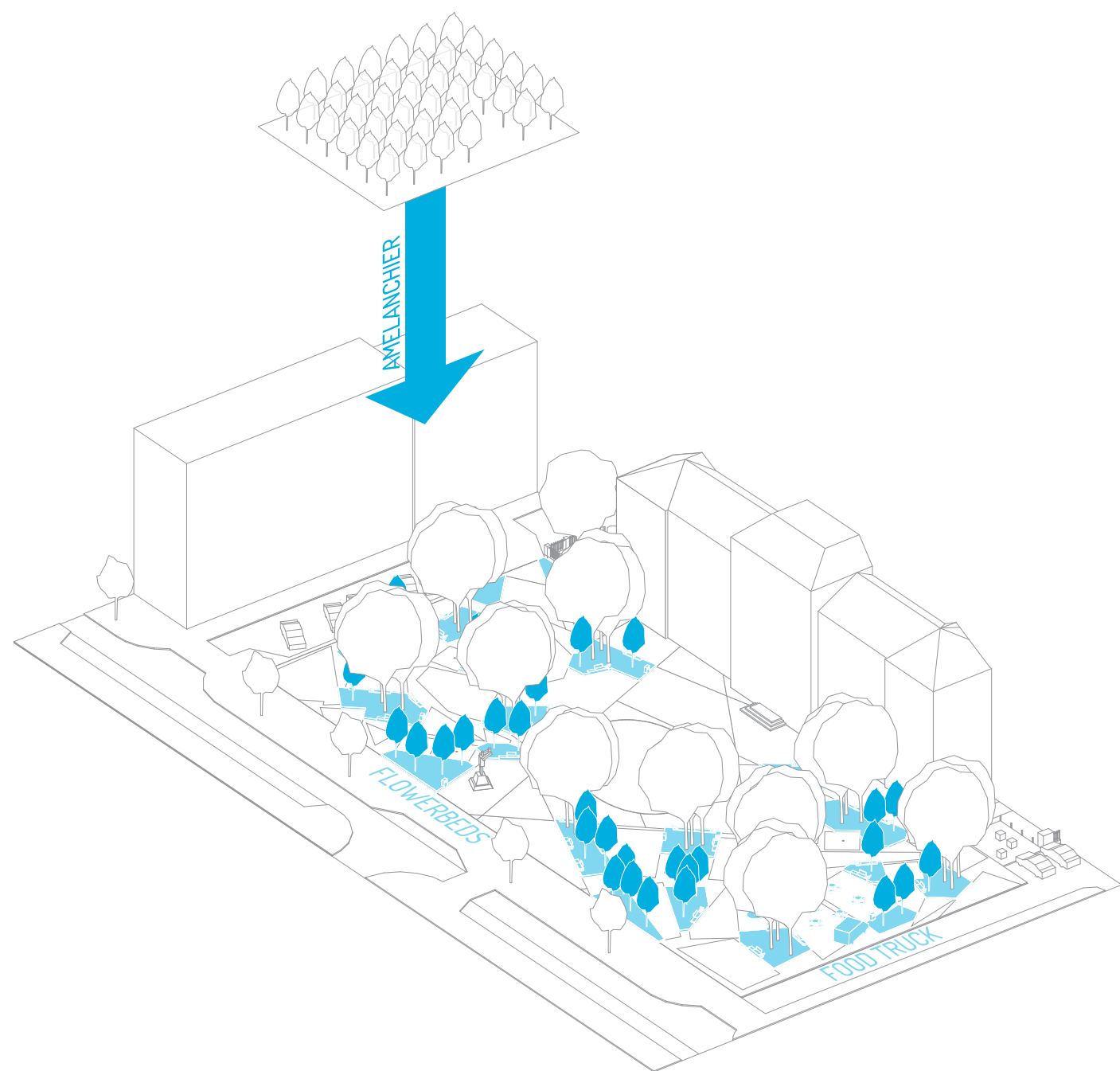

**Amelanchier** trees from the current square are also rearranged.

Under all the trees there are heightened **flowerbeds**.

They could be managed by the agriculture school as a part of their education.

There is a great amount of **benches** that are integrated to the flowerbeds. They allow you to sit, lie down or skate on them.

At the edge there is a place for **food truck** and tables with chairs.

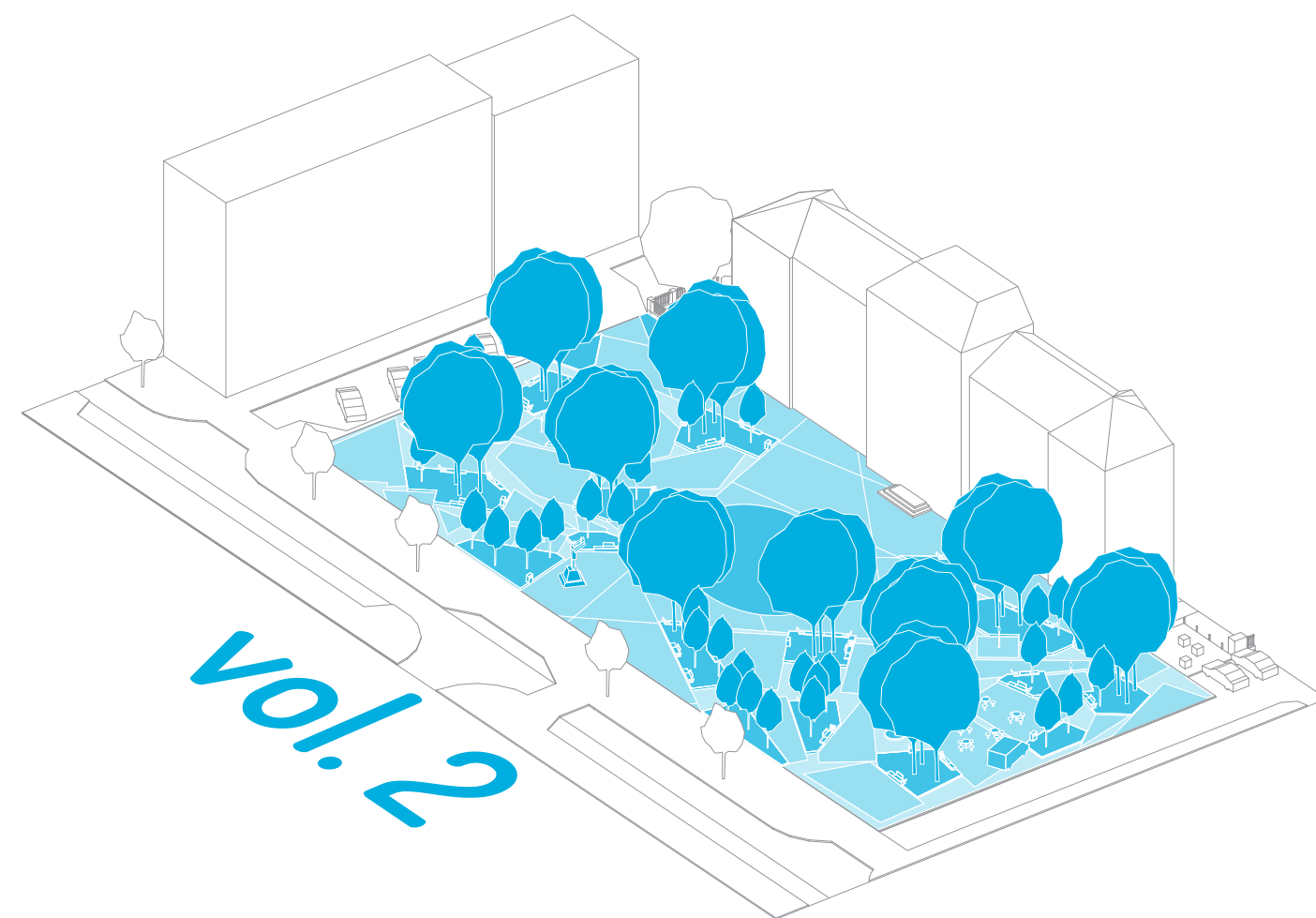

This is a sustainable, multifunctional space full of greenery.



